

BALDWIN

Installation Instructions ENGLISH

Premium Entrance Set SINGLE CYLINDER ESCUTCHEON TRIMS

Nantucker® Glennon™ Buckingham®



5370 5375 5380



With the completion of your project, remember that Baldwin quality hardware products are available for all your decorating and remodeling needs. Matching entrance sets for exterior doors, beautiful bath accessories, and a complete selection of cabinet and door-enhancing hardware are all available from your Baldwin retailer.

To request a product brochure or the name of a retailer near you, call 1-800-566-1986.

PK.5701
12/11

Congratulations!

With your purchase of this Premium Full Dummy Trim Set, you're among a group of discerning individuals who know the intrinsic value of selecting the finest—Baldwin.

Our step-by-step installation instructions will help guide you through your project quickly and easily.

Before you begin your installation, read and understand the installation instructions and marking templates. If you have any questions, please do not hesitate to contact our Baldwin Consumer Help Line at 1-800-566-1986. We're here to help! We thank you for your purchase and wish you the fullest enjoyment of your Baldwin product.

Care and Maintenance

WARNING: Do not attempt to clean your hardware with any type of abrasive cleaners, solvents, or chemicals. These types of cleaning agents may mar the finish. A damp cloth is all that is necessary to wipe clean. Note: Finish Nantucker, 102, Oil-Bronze, can be cleaned with light machine oil and wiped with a dry cloth.

Consumer Help Line 1-800-566-1986

Hours: 8 a.m. to 8 p.m. E.S.T. - Monday - Friday
10 a.m. to 6 p.m. E.S.T. - Saturday

If you have trouble installing your Baldwin product, feel free to call our toll-free Consumer Help Line.

Warranty Information

Limited Lifetime Mechanical Warranty – Baldwin warrants that each Baldwin product shall be free from mechanical defects at the time of delivery and for the lifetime of the product or as long as you own your home.

Limited Lifetime Finish™ Warranty – The Baldwin Lifetime Finish™ uses advanced finishing technology (physical vapor deposition) to create a finish highly resistant to the effects of weather and normal wear and tear. The Limited Lifetime Finish Warranty on Lifetime Finish™ products covers the original purchaser for as long as you own your home.

Limited Finish Warranty – The finish on Baldwin products (excluding Lifetime Finish and living finish products) is protected by a durable topcoat designed to maintain the beauty and quality of the Baldwin product. The Baldwin Limited Finish Warranty covers the original purchaser for five years from date of purchase for interior use and one year for exterior use.

Living Finishes – Due to the nature of Baldwin living finish products, they will wear over time and may already have begun the process before reaching your home. No finish warranty is offered on living finish products, which are designed to age and improve over time. Living finishes include raw brass, oil rubbed bronze, stainless steel, and other non-lacquered or non-PVD finishes.

Refer to www.baldwinhardware.com for a complete warranty statement.

www.baldwinhardware.com



Browse through the Baldwin Collection of beautiful locks, bath accessories and decorative hardware. Compare styles and finishes. There are thousands of photos and descriptions available to help you coordinate hardware throughout your home. Create your ideal "wish list" then visit your Baldwin Retailer or Dealer. Visit www.baldwinhardware.com today!

1 Before You Begin

- Check the thickness of the door. This lockset works on doors 1 1/2" thick only. For doors greater than 1 1/2" up to 2 1/2" thick, contact our Consumer Help Line at 1-800-566-1986. The conversion kit part number for this item is 5399.XXXA, please specify the finish of your product.
- **Follow the step-by-step sequence to ensure proper operation of your Baldwin lockset.**
- If your door is pre-drilled, see handsets installation step 1. If it is not pre-drilled, see door preparation step 1.
- **Important!** If you are removing an old lock and replacing it with this Baldwin lockset, you must install the Baldwin strikeplate provided. Failure to do so could void your warranty. You may need to plug existing holes left by the old strikeplate screws with wood dowels and re-drill the pilot holes for the new strikeplate.
- We recommend spreading cardboard over floor to prevent scratching parts and marring floor.
- Always wear protective eyewear.

Note: The illustrations in these instructions depict the outside handle being installed on the right of the door. For installation of the outside handle on the left of the door, proceed as if all illustrations were reversed.

2 Door Preparation (If Needed)



1 Pull door toward you to check if it's level. Observe contact of door to jam and make sure it's level. Adjust if necessary.

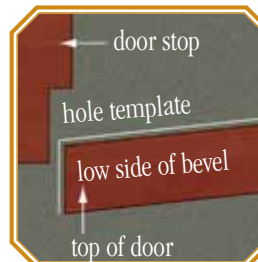

2 (Aerial View) To ensure proper alignment, only use hole template on side facing doorstop.
Helpful Hint: Some doors have a beveled edge with bevel facing doorstop.



3 Fold hole template along door edge with center of bottom hole (A), the 2 1/2" dia. hole, 3/8" from floor. Tape template to door.



4 Determine basket, which is the distance from the edge of door to center of hole. Use hole template to mark the basket center point for your installation. Locate and mark positions for (A, B, C, D, and E) on template. The most common basket is 2 1/4".

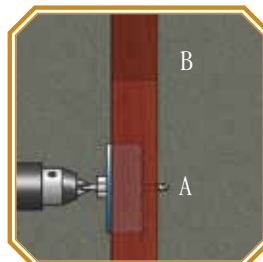

5 Very carefully drill (A, B) 2 1/4" holes into one side of door face until drill bit starts to protrude on opposite side.

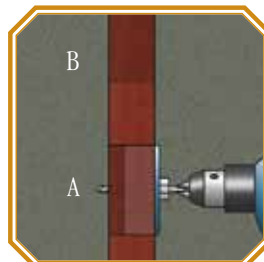

6 Complete drilling holes (A, B) from opposite side of door.

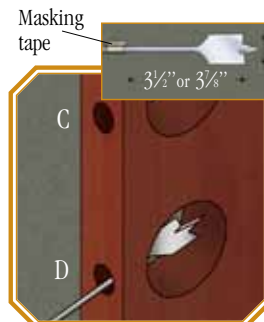

7 Very carefully drill (C, D) holes into door edge exactly at pencil marks. 3/2" deep for a 2 1/4" basket. 3 1/2" deep for a 2 1/2" basket. **Helpful Hint:** Mark edge depth of drilling with masking tape.

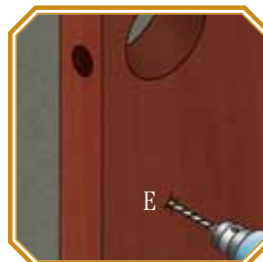

8 Very carefully drill (E) 1/4" hole into door exactly at pencil mark.



9 Insert latch into hole (D). Use utility knife to score chisel guides into door edge. Make sure score guides are parallel to door. Repeat for deadbolt hole (C).



10 Chisel faceplate cavity 1/4" deep. **Helpful Hint:** Chisel toward inside edge of score lines, removing only a small bit to avoid wood damage.

Exploded View

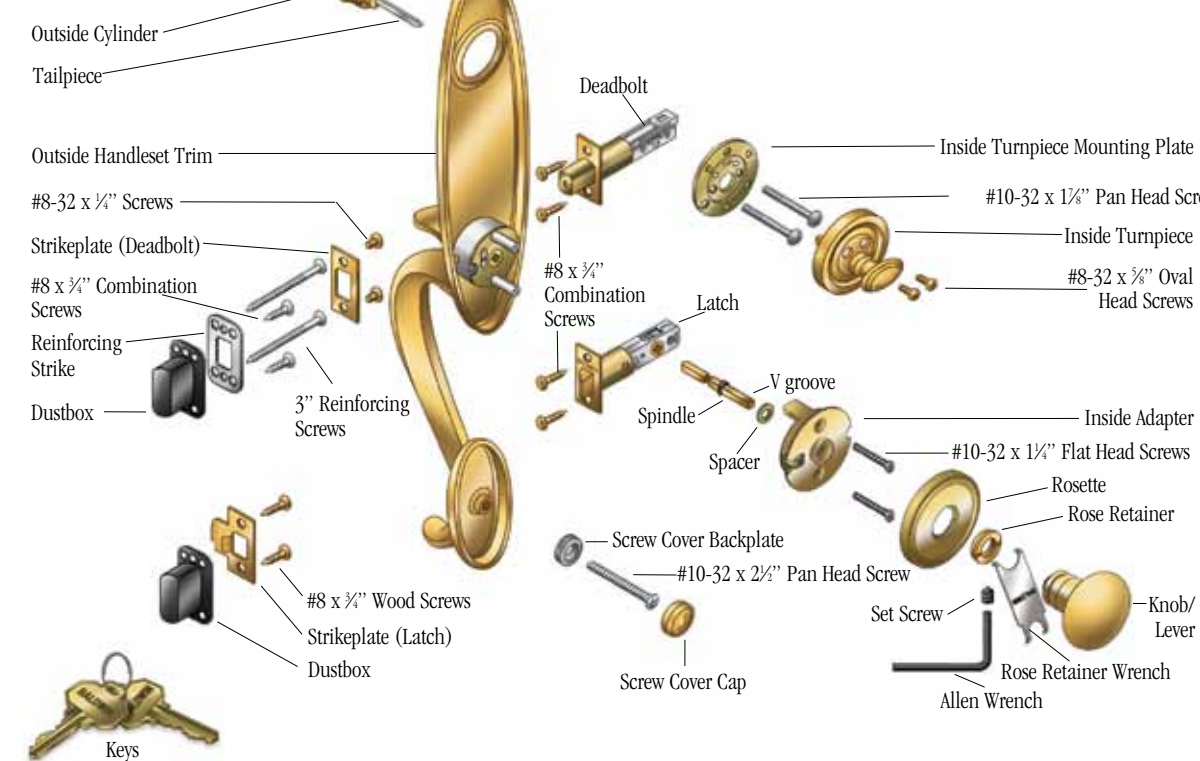

Handset Installation Fasteners



Strikeplate Installation Fasteners

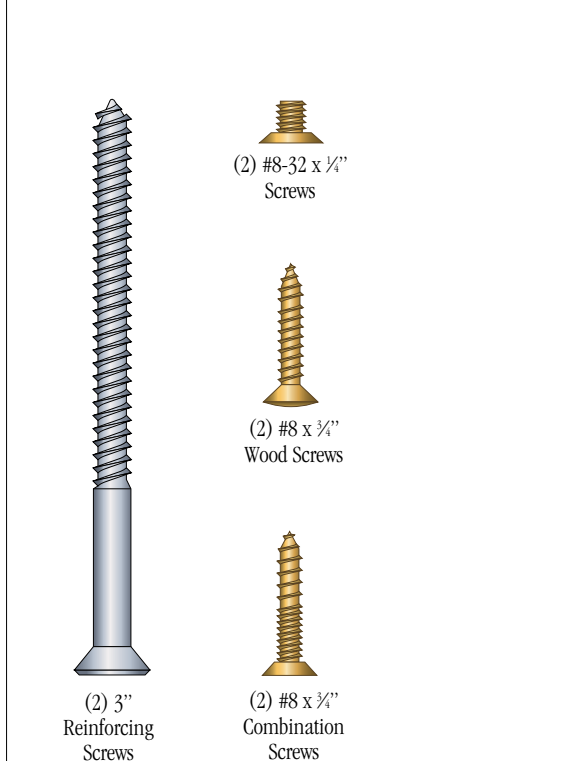

3 Handset Installation



1 Determine your basket, which is the distance from the edge of door to center of hole. Your lockset is shipped with a 2 1/4" basket (most common). Adjust for a 2 1/2" basket door only.



2 For a 2 1/4" basket, grasp body and twist faceplate 180° until it stops. Angled side of bolt should face outside. Follow same procedure for deadbolt. **Note:** See deadbolt orientation during installation Step 4.



3 Insert latch with angled side of bolt facing outside. Drill 1/8" pilot holes. Secure with #8 x 1/4" combination screws so latch is flush with door. Repeat for deadbolt. **Helpful Hint:** When installing wood screws it is recommended to put beeswax or soap on screw threads to improve installation.



4 Note orientation of deadbolt. Insert deadbolt. Drill 1/8" pilot holes. Secure with #8 x 1/4" combination screws so latch is flush with door.



5 Attach handle by inserting the #10-32 x 2 1/2" pan head screw on inside of door through screw cover backplate and the lower hole (E). Leave screw loose for adjustment. **Note:** Go to door preparation if you do not have a lower hole (E).



6 Measure the thickness of your door. If door is less than 1 1/2" thick, do not use the spacer provided. If your door measures 1 1/2", slide the spacer onto spindle.



7 From inside of door, insert short end of spindle through the latch with the V groove on the long end angled down and toward hinges. Position outside handset trim so spindle slides into square hole in thumbpiece cartridge. **Note:** Make certain spindle is inserted through the latch to stops.



8 Align spindle, latch, and outside handset trim. Insert the inside adapter onto the posts of the outside handset. Secure with two #10-32 x 1 1/4" flat head screws. Leave screws loose for adjustment.



9 Extend deadbolt with flat head screwdriver. Keeping tailpiece vertical, insert cylinder through outside handset and into deadbolt. Hold in place. **Note:** Do not insert key.



10 Place thumbpiece mounting plate on inside of door. Attach to cylinder using two #10-32 x 1 1/4" pan head screws. Tighten screws. **Important:** Note orientation of mounting plate.



11 Place inside thumbpiece over mounting plate. Insert tailpiece into inside thumbpiece. Attach cylinder using two #10-32 x 1 1/4" pan head screws. Tighten screws. Make certain turn knob rotates smoothly in both directions. Tighten all screws, including screw for bottom of handle.



12 Use the rose retainer wrench to attach the rose to the spindle using the rose retainer. Slide knob/lever onto spindle and tighten set screw with allen wrench. Knob/lever is secured when set screw enters V groove in spindle. Attach bottom screw cover.

Troubleshooting Guide

If parts are missing do not return product. Please call Baldwin's Consumer Help Line at 1-800-566-1986 and we will quickly send the parts to you.

Problem	Solution
Can't extend deadbolt unless key is in cylinder. Can't remove key with deadbolt in extended position.	Cylinder is out of time. Remove turn knob assembly and cylinder. Extend deadbolt with screwdriver and re-install hardware. Refer to Handset Installation Step 5.
Screws are all tight but the hardware is not firmly attached to the door.	Check door thickness. Door must be 1 3/4" thick. Hardware will not install on doors less than 1 3/4" thick.
Inside knob or lever spins freely and does not retract latch bolt. Deadbolt retracts when thumbpiece on outside is pushed.	Spindle is installed backwards. Short side of spindle must face exterior of house. Long side of the spindle is installed toward inside of house. Refer to Handset Installation Step 10.
Knob or lever keeps coming off the spindle.	Ensure that set screw on knob or lever is installed in V groove on spindle and securely tightened with allen wrench provided. Refer to Handset Installation Step 12.
Door is difficult to latch or will not stay closed unless deadbolt is extended.	Strikeplate is not aligning with latchbolt. Remove, plug holes with wooden dowels and glue. Adjust and re-install. Condition can also be caused by weather stripping being installed after hardware is installed. Re-install strike as described at left. Refer to Strikeplate Installation Step 1.
Can't extend deadbolt from inside with turn knob or outside with key when door is closed.	Open door and try to extend deadbolt. If deadbolt extends easily with door open, deadbolt strike is not aligned with deadbolt. Remove strike and relocate as necessary. Refer to Strikeplate Installation Step 1.
Door is already prepared with round hole for latch.	Replace door or return lockset to place of purchase. Baldwin does not manufacture a round (drive-in) latch at this time.
Deadbolt will only retract fully when retracted forcefully and quickly. Will not retract fully when retracted slowly.	Wrong deadbolt may have been supplied. Call our Consumer Help Line at 1-800-566-1986 for assistance.
Deadbolt works easily with turn knob on inside but is difficult to turn and has grinding sound when turned with key on outside.	Improper alignment of cylinder and thumbpiece or improper door thickness. Use a block of wood to tap cylinder collar so it will not move more than 1/16" in any direction. If this does not correct problem, check deadbolt hole preparation for accuracy. Ensure that door is 1 3/4" thick. Refer to Handset Installation Step 6.

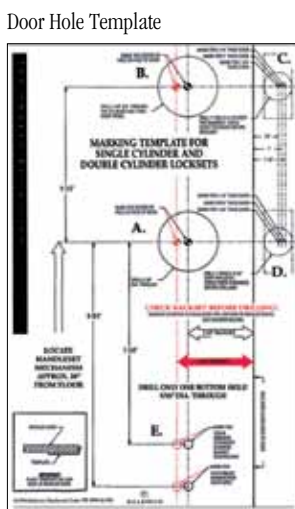

Door Hole Template

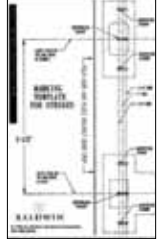

Door Frame Template

Required Tools

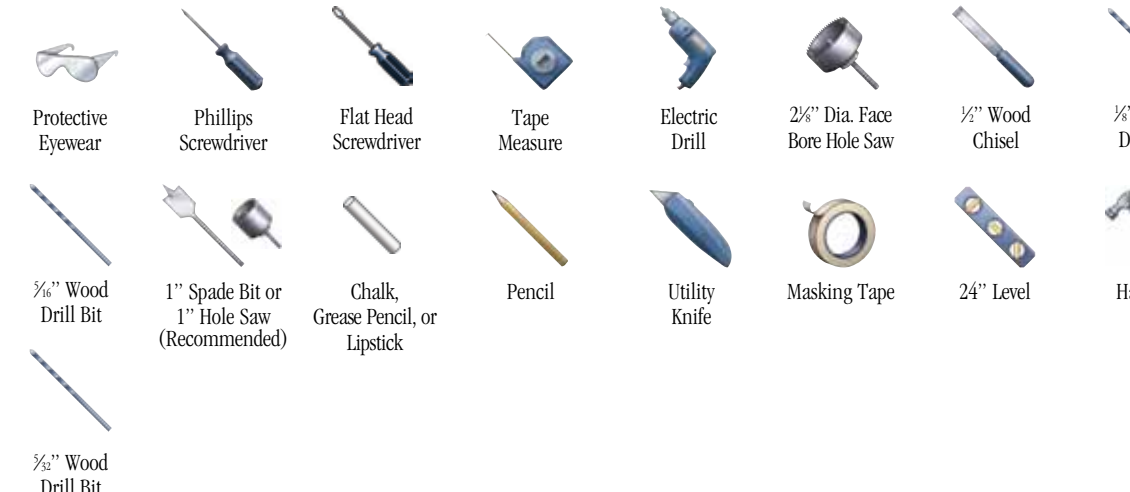

Helpful Tools

