

In2ition[®] Installation Instructions

Parts Included

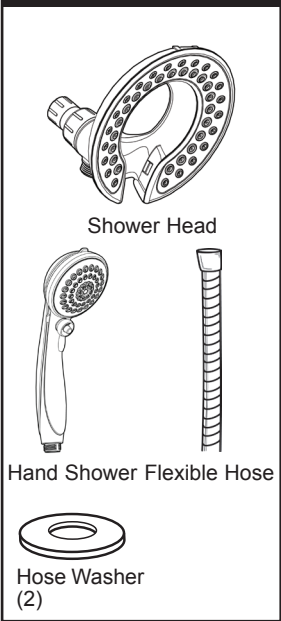

1. Install the shower head.

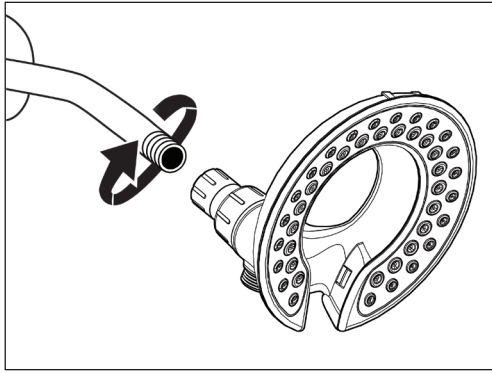

- Make sure to turn off water supply before installing the Shower Head.
- Remove existing Shower Head from Shower Arm.
- Apply Plumber tape (not provided) to Shower Arm if necessary, to ensure leak-free connection.
- Hand tighten the Ball Connector of the Shower Head to the Shower Arm. (Use a wrench if necessary for firm installation.)

2. Install hand shower.

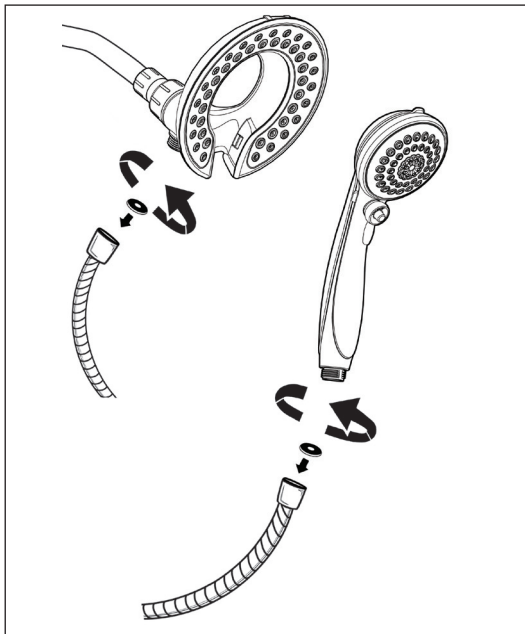

- Confirm the hose washers are installed in the hose nuts at each end of the hose.
- Connect one end of the Flexible Hose to the Shower Head. Connect the other end of the Flexible Hose to the Hand Shower. All connections should be made by hand tightening.

3. Insert hand shower into shower head.

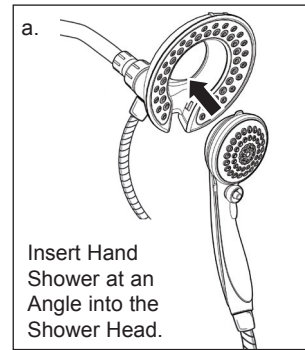

- The Hand Shower should be inserted at an angle so the tab on the top of the Hand Shower fits into the slot in the Shower Head.
- Gently push the Hand Shower into the Shower Head.

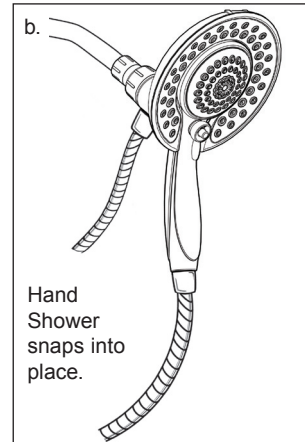

- If the Shower Head moves when removing the Hand Shower, tighten the connection between the Shower Head and the Shower Arm.

4. Removing the Hand Shower from the Shower Head.

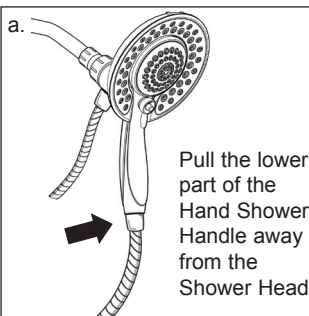

- The Hand Shower should be removed at an angle to release from the Shower Head.

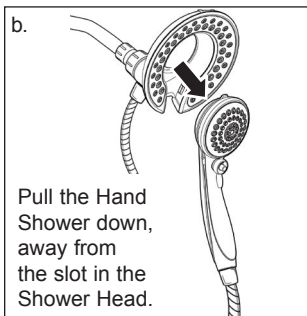

- Once the Hand Shower is released from the lower clips of the Shower Head, gently pull the Hand Shower away from the slot in the upper portion of the Shower Head.

Cleaning of Parts

Only clean with a mild non-abrasive detergent and soft cloth.

Note: Any other cleaning product not specifically designed for cleaning plastic or metal surfaces may damage the finish.

Limited Lifetime Warranty

All parts and finishes of the Delta[®] faucet are warranted to the original consumer purchaser to be free from defects in material & workmanship for as long as the original consumer purchaser owns their home. Delta Faucet Company recommends using a professional plumber for all installation & repair.

Delta will replace, FREE OF CHARGE, during the warranty period, any part or finish that proves defective in material and/or workmanship under normal installation, use & service. Replacement parts may be obtained by calling 1-800-345-DELTA (in the U.S. and Canada) or by writing to:

In the United States:
Delta Faucet Company
Product Service
55 E. 111th Street
Indianapolis, IN 46280

In Canada:
Masco Canada Limited, Plumbing Group
350 South Edgeware Road,
ST. Thomas, Ontario, Canada N5P 4L1

This warranty is extensive in that it covers replacement of all defective parts and even finish, but these are the only two things that are covered. LABOR CHARGES AND/OR DAMAGE INCURRED IN INSTALLATION, REPAIR, OR REPLACEMENT AS WELL AS ANY OTHER KIND OF LOSS OR DAMAGES ARE EXCLUDED. Proof of purchase (original sales receipt) from the original consumer purchaser must be made available to Delta for all warranty claims. THIS IS THE EXCLUSIVE WARRANTY BY DELTA FAUCET COMPANY, WHICH DOES NOT MAKE ANY OTHER WARRANTY OF ANY KIND, INCLUDING THE IMPLIED WARRANTY OF MERCHANTABILITY.

© 2011 Masco Corporation of Indiana
www.deltafaucet.com

WARNING: Plumbing Codes require that shower heads and hand showers provide a small but continuous flow of water (trickle) when in "PAUSE" mode. Because of this continuous flow, in certain circumstances pressure variations in the water line and/or changes in the position of shower temperature control handle while in "PAUSE" mode could result in dramatic changes to the temperature of the water when the shower head or hand shower is returned to the "ON" position.

ALWAYS point the shower head away from yourself when returning to the "ON" position and feel the water with your hand before resuming your shower to ensure the water flow is not too hot or too cold. DO NOT allow children or others who might not understand this warning to use the "PAUSE" function.