

3 1/2" X 3 1/2"
SPRING HINGES

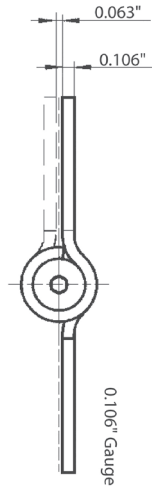

SPECIFICATIONS

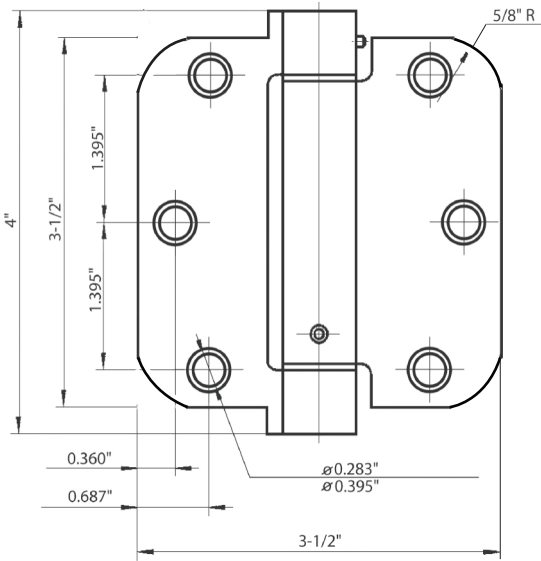

- #10 X 1/2" machine screw (10-24NC) standard.
- #10 x 1" wood screw standard.
- Box Pack: 1 Pair (2 pcs) per box.
20 Pair / CTN, 28 Lbs
- Gauge: 0.106" Steel

PRICING

Description	Radius		US26D	US10B
3 1/2" x 3 1/2" Spring Hinge	5/8"	Item No.	SP3506	SP3510
		List Price		

4" X 4"
SPRING HINGES

SPECIFICATIONS



- #10 X 1/2" machine screw (10-24NC) standard.
- #10 x 1" wood screw standard.
- Box Pack: 1 Pair (2 pcs) per box.
20 Pair / CTN, 32 Lbs
- Gauge: 0.106" Steel

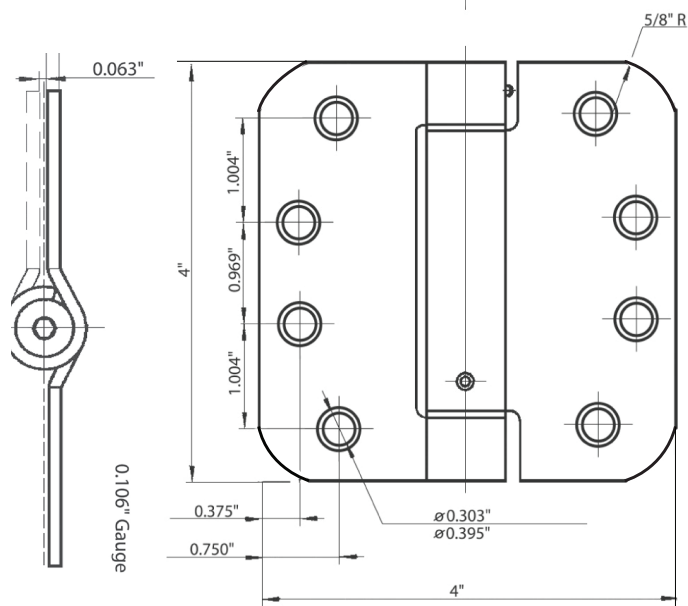

PRICING

Description	Radius		US26D	US10B
4" x 4" Spring Hinge	5/8"	Item No.	SP4506	SP4510
		List Price		



Please see page D-18 for Hinge Sizing Guide.