

The logo for Greenworks, featuring the brand name in a bold, lowercase, sans-serif font. The text is white and set against a black, rounded hexagonal background.

19" Cordless Self-propelled Lawn Mower 25272

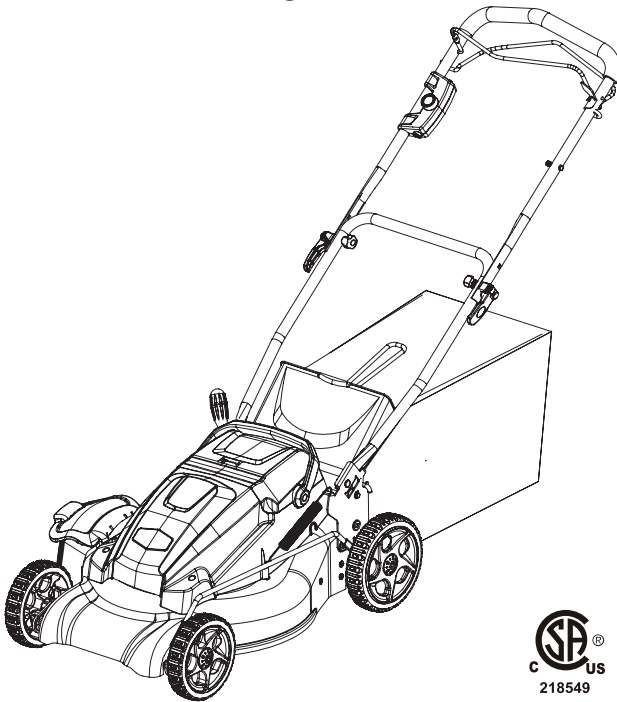

Owner's Manual

TOLL-FREE HELPLINE: 1-888-90WORKS (888.909.6757)

www.GreenWorksTools.com

 Read all safety rules and instructions carefully before operating this tool.

CONTENTS

Contents	2
Product specifications.....	2
Safety information.....	3-7
Symbols.....	8-9
Battery & Charger.....	10-12
Know your lawn mower	13
Assembly	14-18
Operation.....	19-24
Maintenance	25-26
Storage	27
Environmentally safe battery disposal	28
Service	29
Troubleshooting	30
Warranty	31
Exploded View.....	32
Parts List.....	33-35

PRODUCT SPECIFICATIONS

19" CORDLESS SELF-PROPELLED LAWN MOWER

Battery type	36V, 10 Ah sealed lead acid
Charger time.....	10-13 hours
No-load speed.....	3300 RPM
Height adjustments.....	1 1/4 - 3 3/8" (3.2 - 8.6 cm)
Functions.....	3-in-1: Mulch, side discharge or rear bag
Unit weight.....	77 lbs (35 kg)



SAFETY INFORMATION

GENERAL SAFETY RULES

READ ALL INSTRUCTIONS CAREFULLY

W A R N I N G

This symbol indicates important safety instructions. If these instructions are not followed, it could endanger the personal safety and/or property of the operator and others. Read and understand all instructions in this manual before attempting to operate the mower. Failure to comply with these instructions may result in personal injury.

D A N G E R

This mower was built to be operated according to the rules for safe operation that are contained in this manual. As with any type of power equipment, carelessness or error on the part of the operator can result in serious injury. This mower is capable of amputating body parts and throwing objects. Failure to observe the following safety rules could result in serious injury or death.

W A R N I N G

Basic safety precautions should always be followed when using electric lawn mowers, in order to reduce the risk of fire, electric shock, and personal injury.

W A R N I N G

Use of this mower should be restricted to individuals who have read and understood and will follow the warnings and instructions that are printed in this manual and on the mower.



DANGER

AVOID SERIOUS INJURY OR DEATH

- To reduce risk of injury, user must read and understand operator's manual.
- To reduce the risk of electric shock, do not expose to water, do not use in rain.
- Replace damaged parts immediately.
- Remove the key before servicing, opening or removing blade.
- Do not mow when children and others are around.
- Remove object that could be thrown by the blade.
- Go across slopes, not up and down.
- Keep safety devices(guards, shields, switches ETC.) in place and working.
- Look down and behind before and while moving backwards.
- Always wear proper eye and hearing protection.

SAFETY INFORMATION

- Carefully read all instructions on the mower and in the manual before attempting to assemble and operate the mower. Keep this manual in a safe place for future reference, and consult it regularly.
- Become familiar with all controls and their proper operation. Know how to stop the mower and how to disengage the power in an emergency.
- In order to avoid contact with the blade or injury caused by a thrown object, stay in the operating zone behind the handles, and keep children and bystanders at least 100' (30 m) away from the mower while it is in operation. Stop the motor immediately if someone enters the mowing area.
- Thoroughly inspect the area where the mower is to be used. Remove all stones, sticks, wire, bones, toys, and other objects that could be tripped over or thrown by the blade. Thrown objects can cause serious personal injury.
- Plan your mowing pattern in such a way as to avoid discharging material toward roads, sidewalks, bystanders, etc. Do not discharge material against a wall or obstruction. Doing so may cause the discharged material to ricochet back toward the operator.
- Always wear proper eye protection that complies with ANSI Z87.1 in order to protect your eyes while operating or performing any adjustment or repair. Thrown objects that ricochet can cause serious eye injury.
- Always wear a face mask or a dust mask when operating the mower in a dusty environment.
- Dress properly. Do not wear loose clothing or jewellery that can get caught in moving parts. The wearing of protective gloves and safety footwear is recommended.
- Ground Fault Circuit Interrupter (GFCI) protection should be provided on the circuit(s) or outlet(s) that will be used to charge the lawn mower battery. Outlets with built-in GFCI protection are available, and may be used as an added safety measure.
- Many injuries occur as a result of the mower being pulled over the operator's foot during a fall caused by slipping or tripping. Do not operate this mower in bare feet, or while wearing sandals or lightweight (e.g., canvas) shoes. Do not hold on to the mower if you are falling. Release the handle immediately.
- Never pull the mower back toward you while you are walking. If you must back the mower away from a wall or an obstruction, first look down and behind in order to avoid tripping, and then follow these steps:
 - Step back from the mower in order to fully extend your arms.
 - Be sure that you are well balanced.
 - Pull the mower back slowly.
- Do not use the mower for any job except that for which it is intended. Do not force the mower.
- Do not operate the mower while under the influence of alcohol or drugs.
- Stay Alert: Do not operate the mower when you are tired. Pay attention to what you are doing. Use common sense.
- Do not put hands or feet near rotating parts or under the cutting deck. Contact with the blade can amputate hands and feet.
- Do not attempt to adjust the wheels or the cutting height while the motor is running.
- Avoid dangerous environments. Do not operate the mower in the rain or in wet or damp grass.
- Mow only in daylight or in good artificial light. Do not rush a mowing job.

SAFETY INFORMATION

- Stop the blade when crossing gravel driveways, walkways, or roads.
- If the mower starts to vibrate excessively, stop the motor and check for the cause immediately. Vibration is generally a warning of trouble.
- Stop the motor and wait until the blade comes to a complete stop before removing the grass catcher or unclogging the chute. The cutting blade will continue to rotate for a few seconds after the motor is shut off. Do not place any part of your body in the blade area until you are sure that the blade has stopped rotating.
- Never operate mower without a proper trail shield, discharge cover, grass catcher, switch control, or other safety device in place and in working order. Do not operate the mower with damaged safety devices. Doing so can result in injury.
- Don't force lawn mower. It will do the job better and safer at the rate for which it was designed.
- Store idle lawn mower indoors. When not in use, lawn mower should be stored in an indoor dry and look-up place, out of reach of children.
- Maintain lawn mower. Keep cutting edgers sharp and clean for best and safety performance.
- If lawn mower strikes a foreign objects follow these steps:
 - Stop lawn mower, release the switch.
 - Remove the key and battery.
 - Inspect for damage.
 - Repair any damage before restarting and operating the lawn mower.
- Do not charge lawn mower in rain or in wet location.
- Remove or disconnect battery before servicing, cleaning or removing material from lawn mower.

CHILD SAFETY

Tragic accidents can occur if the operator is not aware of the presence of children.

- Keep children out of the mowing area and under the watchful care of a responsible adult.
- Do not allow children under the age of 14 to operate this mower. Children who are 14 years of age and older must read and understand the operating instructions and safety rules in this manual, and must be trained and supervised by a parent.
- Stay alert, and turn the mower off if a child or any other person enters the mowing area.
- Look behind and down for small children before and while moving backwards.
- Use extreme care when approaching blind corners, doorways, shrubs, trees, or other objects that may obscure your view of a child who may run into the path of the mower.

BATTERY & CHARGER

CAUTION

USE ONLY GREENWORKS APPROVED REPLACEMENT BATTERIES, OTHER BATTERIES MAY CAUSE INJURY OR DAMAGE TO THE MOWER. Use with GREENWORKS 36V 10Ah battery.

SAFETY INFORMATION

BATTERY RULES FOR SAFETY

- Battery operated units do not have to be plugged into an electrical outlet; therefore, they are always in operating condition. Be aware of possible hazards even when unit is not operating.
- Remove the battery pack before making any adjustments, cleaning, or removing material from the unit.
- Ensure the isolator key is removed before inserting battery pack.
- A battery pack must be recharged only with the charger specified by the manufacturer. Using a charger with an incompatible battery pack may create a risk of fire. Use battery pack only with charger listed.
- Use only battery pack intended specifically for the machine. Use of any other battery packs may result in a risk of fire, electric shock, or injury to persons.
- When battery pack is not in use, keep it away from other metal objects like: paper clips, coins, keys, nails, screws, or other small metal objects that can make a connection from one terminal to another. Shorting the battery pack terminals together may cause sparks, burns, or a fire.
- Do not place battery products or their batteries near fire or heat. This will reduce the risk of explosion and possibly injury.
- Do not open or mutilate the battery pack. Released electrolyte is corrosive and may cause damage to the eyes or skin. It may be toxic if swallowed.
- Do not short-circuit the battery pack. There is danger of explosion.
- Protect the battery pack against moisture and water. Do not charge unit in a damp or wet location. Following this rule will reduce the risk of electric shock.
- If electrolyte contacts the skin, wash it off immediately with water.
- If electrolyte contacts the eyes, flush thoroughly and immediately with water. Seek medical attention.
- In case of damage and improper use of the battery, vapour may be emitted. Provide for fresh air and seek medical help in case of complaints. The vapour can irritate the respiratory system.
- Do not leave the battery pack in the car in the summer.
- Do not incinerate the battery.

SAFETY RULES FOR CHARGER

- Use of an attachment not recommended by the manufacturer may result in a risk of fire, electric shock, or injury to persons. Following this rule will reduce the risk of electric shock, fire, or serious personal injury.
- Do not clean machine with isolator key or charger installed.
- Do not use the charger when the ambient temperature is above 40°C or below 0°C.
- Do not operate charger with a damaged cable or plug, which could cause shorting and electric shock. Return to authorised service centre for repair or replacement.
- Do not operate charger if it has received a sharp blow, been dropped, or otherwise damaged in any way. Take it to an authorised service center for electrical check to determine if the charger is in good working order.

SAFETY INFORMATION

- Do not disassemble charger, take it to an authorised service station if repair is required. Incorrect reassemble may result in a risk of electric shock or fire.
- Unplug charger from outlet before attempting any cleaning to reduce the risk of electric shock.
- Disconnect charger from the power supply when not in use to prevent damage to the charger during a power surge.
- Do not expose machine to rain or wet conditions. Water entering charger will increase the risk of electric shock.
- Make sure cable is located so that it will not be stepped on, tripped over, come in contact with sharp edges or moving parts or otherwise subjected to damage or stress. This will reduce the risk of accidental wash, which could cause injury, and damage to the cable, which could result in electric shock.
- Keep cable and charger away from heat to prevent damage to housing or internal parts.
- Do not let gasoline/petrol, oils, petroleum-based products, etc. come in contact with plastic parts. They contain chemicals that can damage, weaken, or destroy plastic.
- An extension cable should not be used for the charger unless absolutely necessary. Use of improper extension cable could result in a risk of fire and electric shock. If extension cord must be used, make sure:
 - That pins on plug of extension cord are the same number, size and shape as those of plug on charger.
 - That extension cord is properly wired and in good electrical condition.

WARNING

If any parts are missing, do not operate unit until the missing parts are replaced. Failure to do so could result in possible serious personal injury.

WARNING

When transporting or servicing unit, always remove the key and battery.

WARNING (PROPOSITION 65)

Some dust created by power sanding, sawing, grinding, drilling and other construction activities contains chemicals known to the state of California to cause cancer, birth defects or other reproductive harm. Some examples of these chemicals are:









- Lead from lead-based paints,
- Crystalline silica from bricks and cement and other masonry products, and
- Arsenic and chromium from chemically-treated lumber.

Your risk from these exposures varies, depending on how often you do this type of work. To reduce your exposure to these chemical: work in a well ventilated area, and work with approved safety equipment, such as those dust masks that are specially designed to filter out microscopic particles.

SAVE THESE INSTRUCTIONS



SYMBOLS

Some of the following symbols may be used on this product. Please study them and learn their meaning. Proper interpretation of these symbols will allow you to operate the product better and safer.

SYMBOL	NAME	DESIGNATION/EXPLANATION
V	Volts	Voltage
A	Amperes	Current
Hz	Hertz	Frequency (cycles per second)
W	Watts	Power
min	Minutes	Time
~	Alternating Current	Type of current
≡	Direct Current	Type or a characteristic of current
n_0	No Load Speed	Rational speed, at no load
	Class II Construction	Double-insulated construction
/min	Per Minute	Revolutions, strokes, surface speed, orbits etc., per minute
	Wet Conditions Alert	Do not expose to rain or use in damp locations
	Read The Operator's Manual	To reduce the risk of injury user must read and understand operator's manual before using this product.
	Eye Protection	Wear eye protection when operating this equipment.
	Ricochet	Thrown objects can ricochet and result in personal injury or property damage.
	Sharp Blade	Danger – Keep hands and feet away from blade.
	Operating on a slope	Do not mow a slope that has an angle of greater than 15°.
	Keep Bystanders Away	Keep all bystanders at least 100 ft. away.

SYMBOLS

The following signal words and meanings are intended to explain the levels of risk associated with this product.

SYMBOL	SIGNAL	MEANING
	DANGER	Indicates an imminently hazardous situation, which, if not avoided, will result in death or serious injury.
	WARNING	Indicates a potentially hazardous situation, which, if not avoided, could result in death or serious injury.
	CAUTION	Indicates a potentially hazardous situation, which, if not avoided, may result in minor or moderate injury.
	CAUTION	(Without Safety Alert Symbol) Indicates a situation that may result in property damage.

ENVIRONMENTAL PROTECTION



Waste electrical products should not be disposed of with household waste. Please recycle where facilities exist. Check with your local authority or retailer for recycling advice.

 The battery contains material which is hazardous to you and the environment. It must be removed and disposed of separately at a facility that accepts Lead-acid batteries.

SERVICE

Servicing requires extreme care and knowledge and should be performed only by a qualified service technician. For service we suggest you return the product to your nearest **AUTHORIZED SERVICE CENTER** for repair. When servicing, use only identical replacement parts.

W A R N I N G

To avoid serious personal injury, do not attempt to use this product until you have read this Owner's Manual thoroughly and understand it completely. If you do not understand the warnings and instructions in this Owner's Manual, do not use this product. Call the Toll-free Helpline (1-888-909-6757) for assistance.

W A R N I N G



The operation of any power tool can result in foreign objects being thrown into your eyes, which can result in severe eye damage. Before beginning power tool operation, always wear safety goggles or safety glasses with side shields and, when needed, a full face shield. We recommend Wide Vision Safety Mask for use over eyeglasses or standard safety glasses with side shields. Always use eye protection which is marked to comply with ANSI Z87.1.

SAVE THESE INSTRUCTIONS

BATTERY & CHARGER

WARNING

Always remove the isolator key and store it in a separate location out of the reach of children when the mower is charging or not in use. Failure to remove the isolator key may result in accidental starting or unauthorized use and cause serious personal injury.

The lawn mower comes with a maintenance-free, spillfree, sealed 36 volt battery pack.

- The battery charger is only for use indoors, it must not be used in wet or damp environments. Do not operate the charger near petrol/gasoline or other explosive gasses or vapours.
- The battery should be charged in a cool, dry place. The battery charger should be operated in temperatures between 0 °C and 40 °C.
- Charge the battery pack only with the charger provided.
- The battery pack may be charged while it is connected to the mower, or while it is disconnected from the mower.
- Allow at least 10-13 hours of charge time before initial use of the mower.
- For optimal performance, recharge the battery every 2 months even when it is not in use and prior to each usage.
- The charger may remain connected to the battery pack any time the mower is not in use.
- To improve battery life, store battery indoors in a controlled climate.
- The battery does not have to be fully discharged before recharging.
- Two to three initial charging/discharging cycles may be required to achieve maximum run time/capacity.
- When fully charged, the battery can be safely stored in environment of 25 °C for a period of up to two months, before it requires charging.

BATTERY & CHARGER

CHARGING THE BATTERY PACK

Note: The battery can be charged in or out of the mower.

- Make sure the power supply is normal household voltage, 120 V, 60 Hz, AC only.
- Remove the isolator key and store in separate location out of reach of children.
- **Method 1:** Remove the isolator key, then plug the charger connector into the slot on the right vent when the battery is on the mower. (See Figure 1)
- **Method 2:** After parting the battery from the mower, plug the charger connector into the receptacle on the battery. (See Figure 2)
- Insert the plug of the charger into the wall receptacle.
- When the light is red, the battery is charging. When the light switches to green, the battery is fully charged. A fully discharged battery will charge in approximately 10-13 hours.
- When charging is complete, disconnect the charger from the battery, or the slot from the right vent.

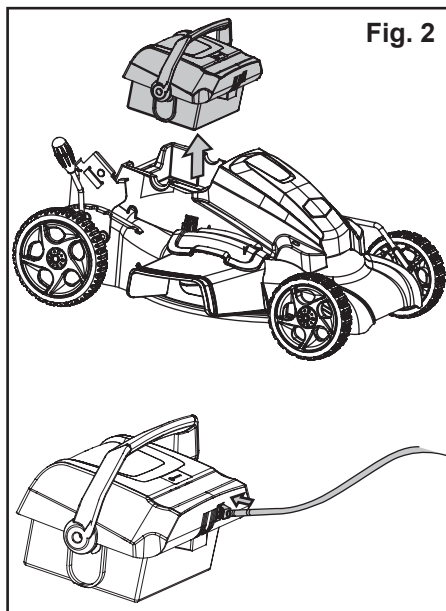
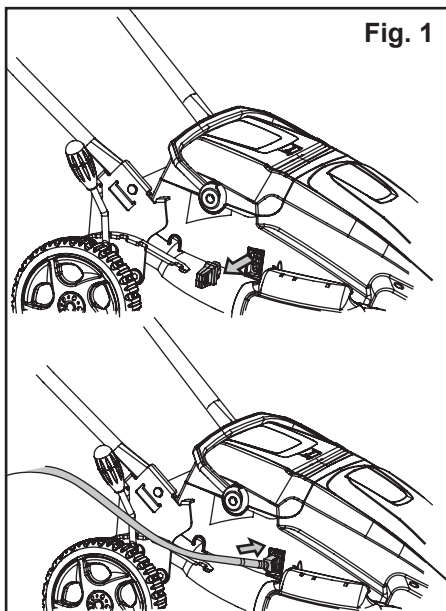

BATTERY & CHARGER

BATTERY METER

Since the mower battery is shipped in a low charge condition, the battery must be charged before use. The battery has four LED lights to indicate battery capacity. These lights will illuminate when the button is pressed.

If four LED lights illuminate, the battery is 100% charged and ready for use. Three lights indicate a 50-80% charge.

Two lights indicate a 30-50% charge.

If one light illuminates, the battery will soon require charging. It is recommended that the battery be charged at this point. The battery is at 5-30% charge when one light illuminates.

If no light illuminates, the battery must be charged immediately before use. There is less than 5% of battery charge remaining if none of the lights are on.

NOTE: When none of the lights are on, you must stop the mower and charge the battery immediately, or it will reduce the life of the battery.

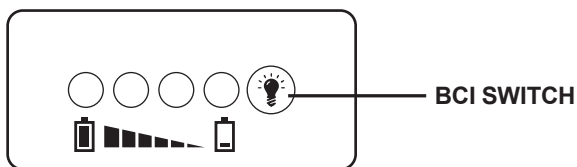

Lights	CAPACITY
4 Green Lights	At Full capacity
3 Green Lights	At 50%-80% capacity
2 Green Lights	At 30%-50% capacity
1 Green Light	At 5%-30% capacity

KNOW YOUR LAWN MOWER

Read this operator's manual and safety rules before operating your lawn mower. Compare the illustration in Figure 3 to your lawn mower in order to familiarize yourself with the location of various controls and adjustments. Save this manual for future reference.

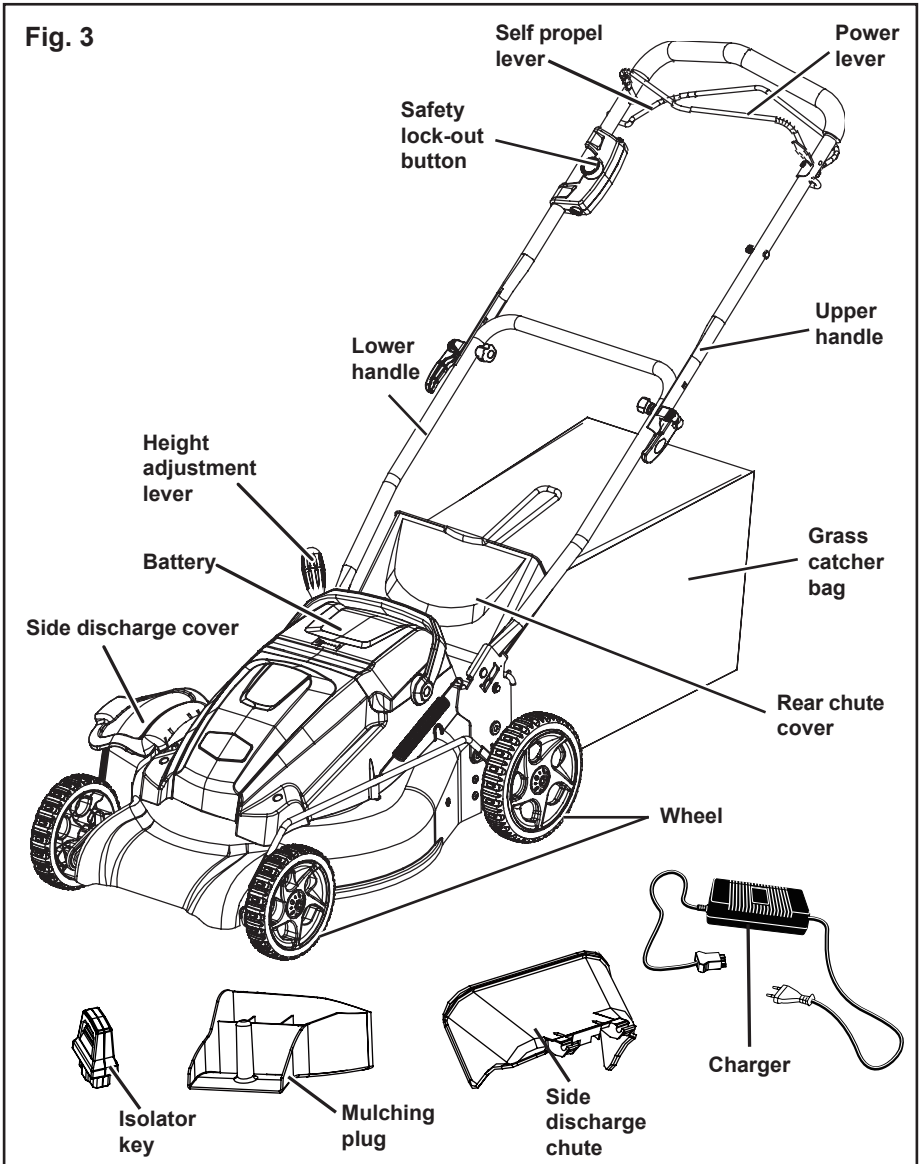

ASSEMBLY INSTRUCTIONS

UNPACKING

- Carefully remove the product and any accessories from the box. Make sure that all items listed in the packing list are included.
- Inspect the product carefully to make sure no breakage or damage occurred during shipping.
- Do not discard the packing material until you have carefully inspected and satisfactorily operated the product.
- If any parts are damaged or missing, please call 1-888-909-6757 for assistance.

PACKING LIST

- | | |
|---------------------|------------------------|
| • Lawn mower | • Side discharge chute |
| • Isolator key | • Battery |
| • Mulching plug | • Charger |
| • Grass catcher bag | • Owner's Manual |
-

WARNING

If any parts are damaged or missing do not operate this product until the parts are replaced. Using a product with damaged or missing parts could result in serious personal injury.

WARNING

Do not attempt to modify this product or create accessories not recommended for use with this product. Any such alteration or modification is misuse and could result in a hazardous condition leading to possible serious personal injury.

WARNING

Do not insert key until assembly is complete and you are ready to mow. Failure to comply could result in accidental starting and possible serious personal injury.

WARNING

To prevent accidental starting that could cause serious personal injury, always remove the battery pack from the product when assembling parts.

WARNING

Never operate the mower without the proper safety devices in place and working. Never operate the mower with damaged safety devices. Operation of this product with damaged or missing parts could result in serious personal injury.

ASSEMBLY INSTRUCTIONS

UNFOLDING AND ADJUSTING HANDLE (See Figure 4)

- Pull up and back on the upper handle to raise the handle into operating position. Make certain the handles snap into place securely.
- Tighten the upper handle with the cam locks on both sides.

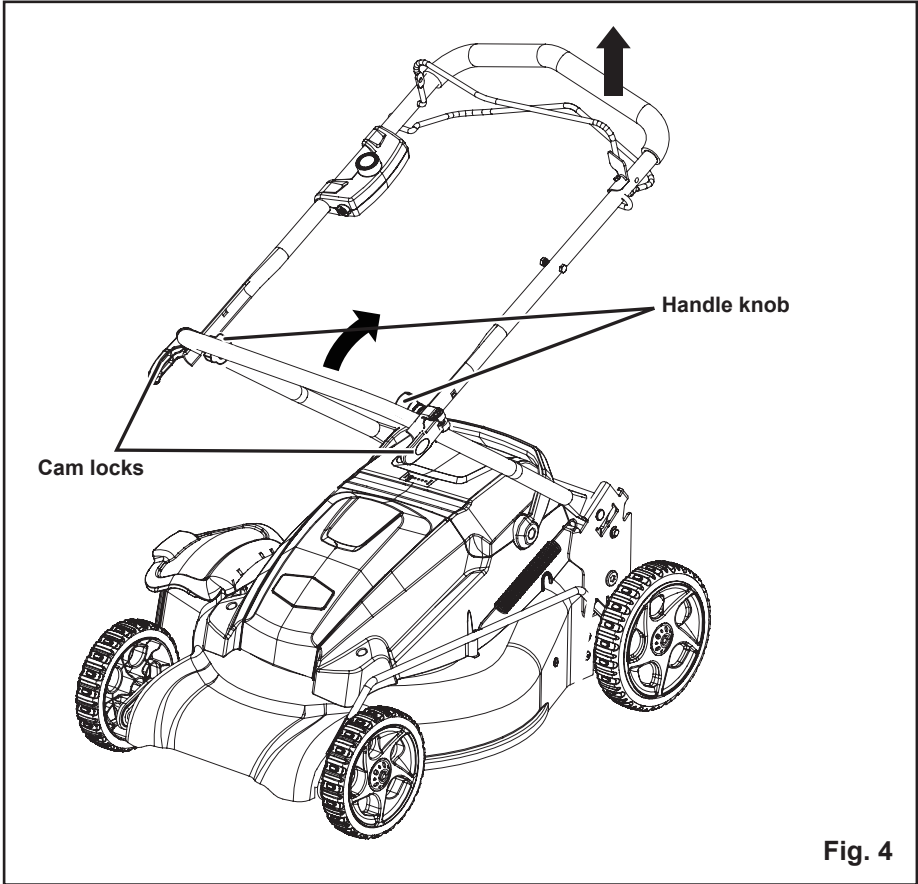

ASSEMBLY INSTRUCTIONS

INSTALLING THE GRASS CATCHER BAG (See Figure 5)

- Lift the chute cover (1).
- Lift the grass catcher by its handle (2) and place under the chute cover so that the hooks (3) on the grass catcher frame are seated into the slots in the handle bracket.
- Release the chute cover. When installed correctly, the hooks on the grass catcher will rest securely in the slots on the handle brackets.

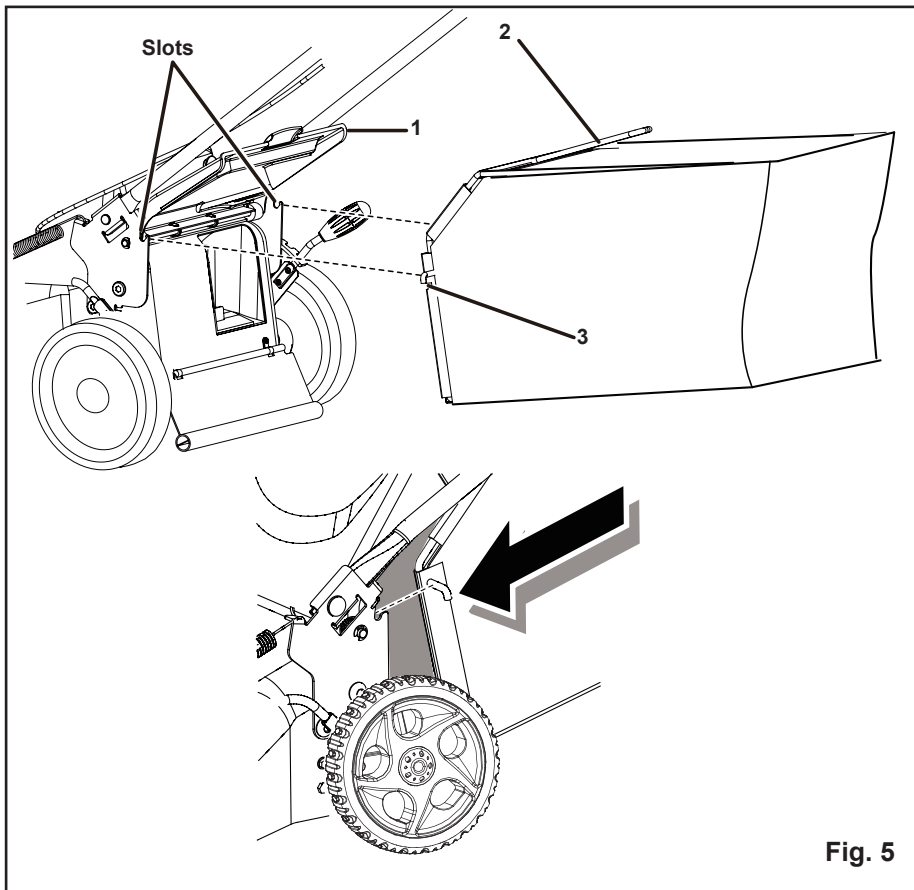
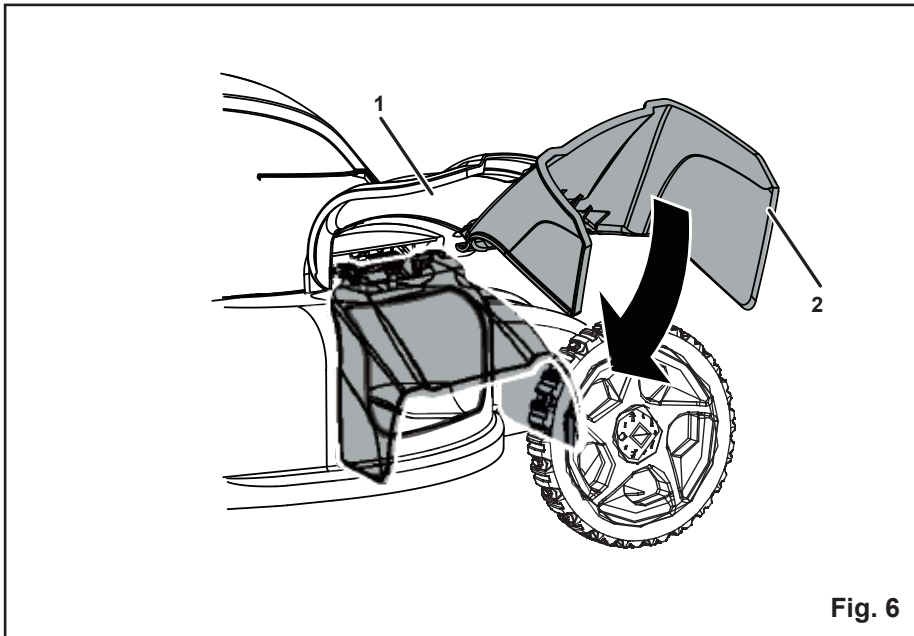

Fig. 5

ASSEMBLY INSTRUCTIONS

INSTALLING SIDE DISCHARGE CHUTE (See Figure 6)

- Lift the side discharge cover (1).
- Align the grooves on the discharge chute (2) with the pins on the underside of the discharge cover (1).
- Lower the discharge chute (2) until the hooks on the mower deck are secured in the openings in the discharge chute (2).
- Release the side discharge cover (1).



ASSEMBLY INSTRUCTIONS

INSTALLING THE MULCHING PLUG (See Figure 7)

- To remove the mulching plug, lift the chute cover (1).
- Grasp the handle (2) of the mulching plug and pull the mulching plug out using the handle.
- The mulching plug (3) is inserted on an angle, so it requires some force to remove it.
- The mulching plug must be removed in order to install the grass catcher bag.
- The mulching plug must be re-installed when the grass catcher bag is removed.

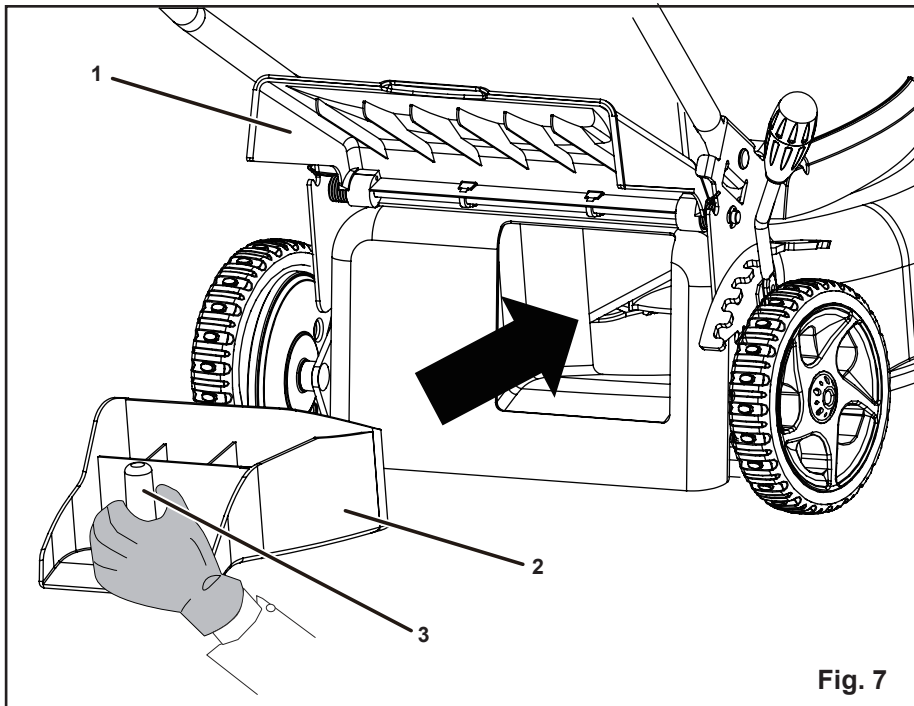

OPERATING YOUR LAWN MOWER

STARTING/STOPPING THE MOWER (See Figure 8)

- Insert the isolator key into the slot on the motor/shroud assembly.
- Press and hold the start button. Pull the power lever toward the handle and release the button to start the mower.
- To stop the mower, release the power lever.
- For starting in thick grass conditions maybe necessary to press down on the handlebars and slightly raise the front wheels until the motor reaches full speed.
- Never lift the rear wheels as this can cause debris to be thrown towards you and increase risk of injury.

SELF-PROPELLED MOWING

- Once the mower has been started, the self-propelled feature is engaged by pulling the self propel lever upward to meet the handle.
- To disengage the self-propelled feature, release the self propel lever.

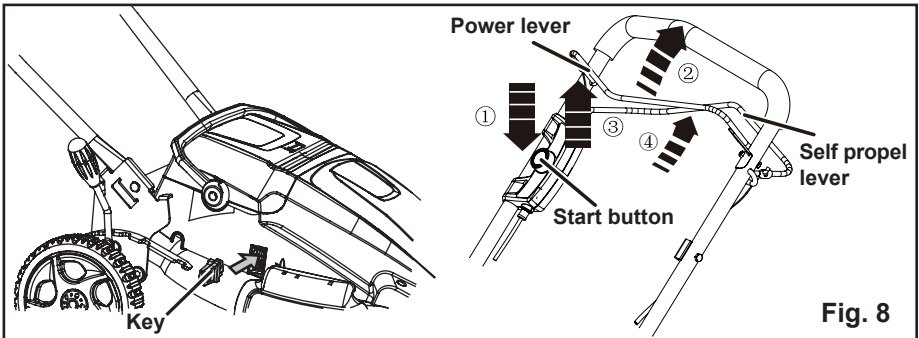

Fig. 8

⚠ CAUTION :

Do not attempt to override the operation of the isolator key or lever.

⚠ WARNING

The operation of any mower can result in foreign objects being thrown into the eyes, which can cause severe eye damage. Always wear safety glasses that comply with ANSI Z87.1 and while operating the mower and while performing any adjustments or repairs.

⚠ WARNING

Ensure that other people and pets remain at least 100 ft. (30 m) away when the mower is in use.

INSPECT THE CUTTING AREA

Remove all stones, sticks, wire, and other debris that might be thrown by the rotating blades.

OPERATING YOUR LAWN MOWER

CUTTING HEIGHT ADJUSTMENT (See Figure 9)

When shipped, the wheels on the mower are set to a low-cutting position. Before using the mower for the first time, raise the cutting position to the height best suited for your lawn. The average lawn should be between 1 1/2" to 2" (3.8 to 5 cm) during cool months and between 2" and 3 1/2" (5 cm to 8.9 cm) during hot months.

To adjust the blade height:

- To raise the blade height, grasp the height adjustment lever (1) and move it toward the back of the mower.
- To lower the blade height, grasp the height adjustment lever (1) and move it toward the front of the mower.

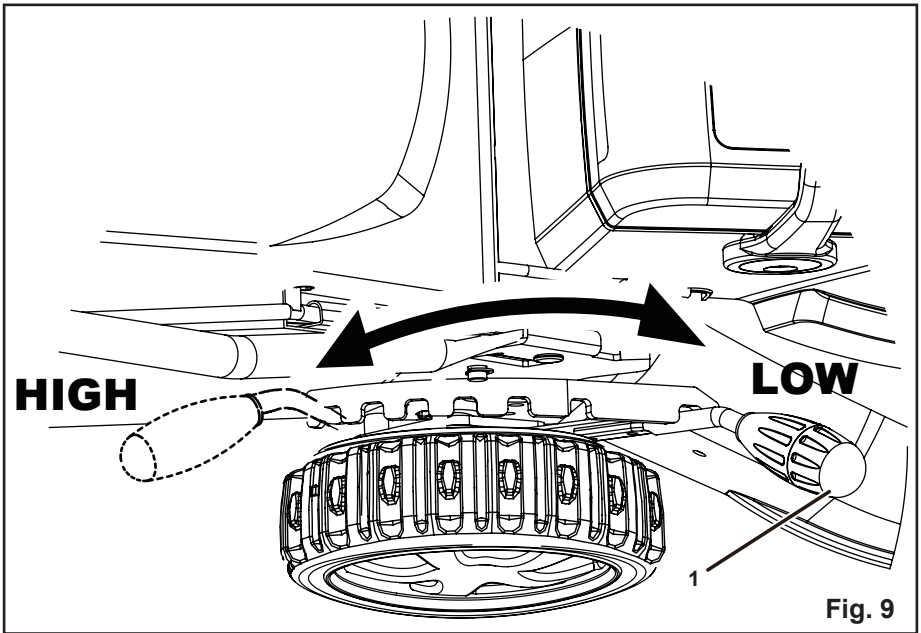
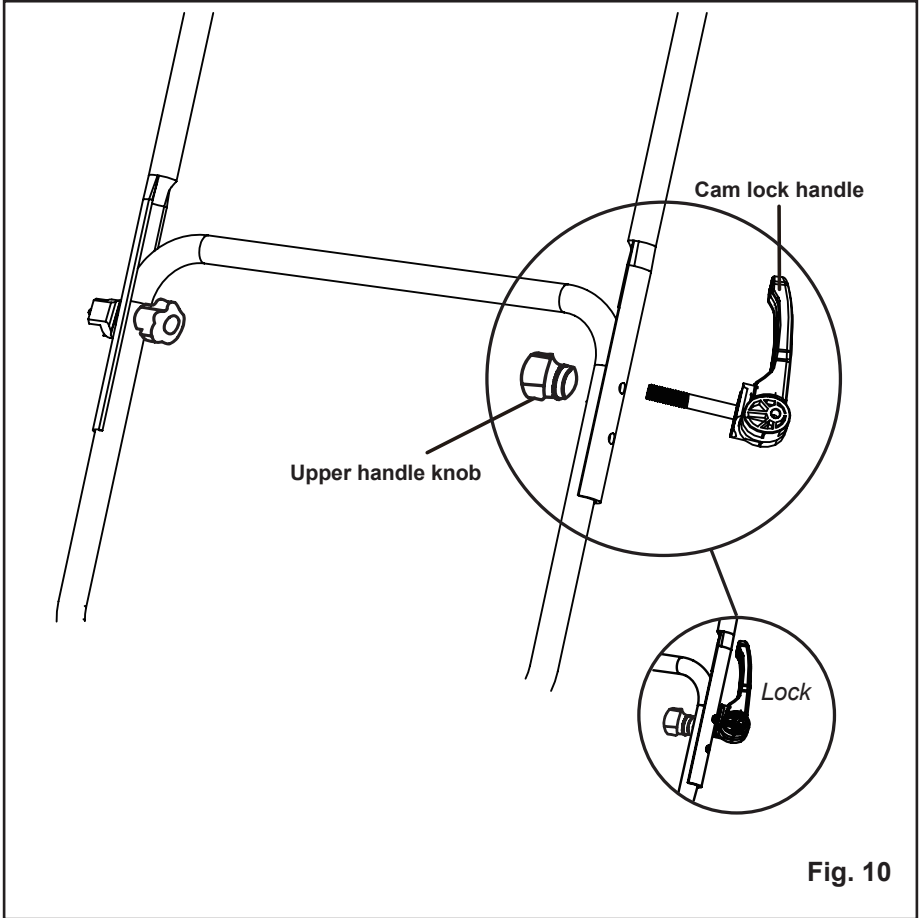

Fig. 9

OPERATING YOUR LAWN MOWER

ADJUST THE UPPER HANDLE HEIGHT (See Figure 10)

- Loosen the upper handle knob.
- Adjust the upper handle to the most comfortable of the 2 positions.
- Snug the upper handle knob and lock the cam lock handle to secure.



OPERATING YOUR LAWN MOWER

EMPTYING THE GRASS CATCHER BAG (See Figure 11)

- Stop mower, allow blades to completely stop, and remove key.
- Lift the rear chute cover.
- Lift the grass catcher bag by its handle to remove from mower.
- Empty grass clippings.
- Lift the rear chute cover and reinstall the grass catcher bag as described earlier in this manual.

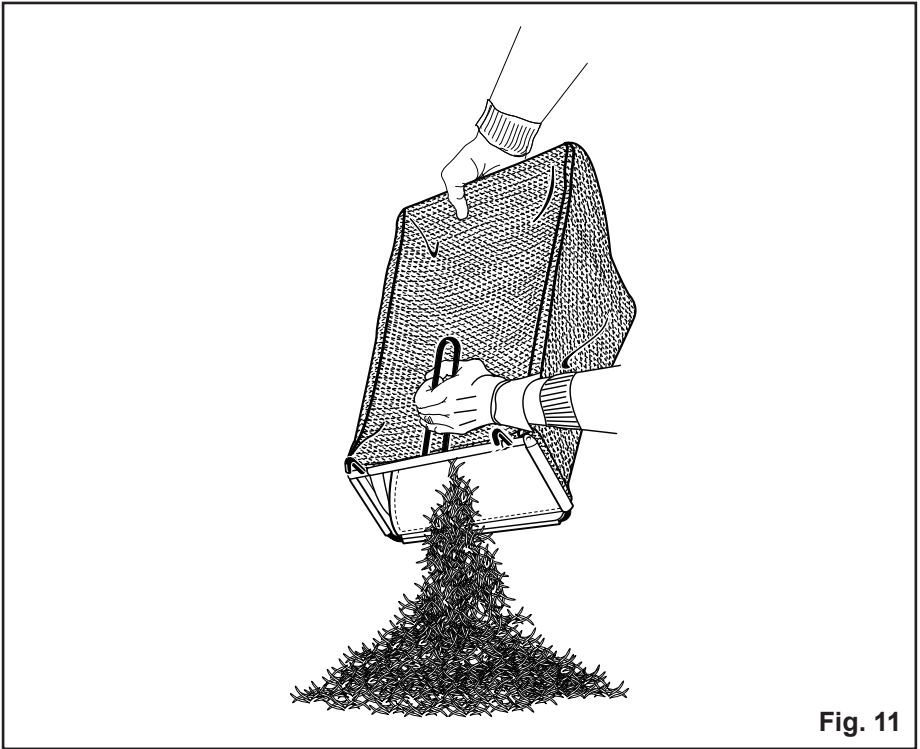

Fig. 11

OPERATING YOUR LAWN MOWER

SLOPE OPERATION

W A R N I N G

Do not mow a slope that has an angle of greater than 15° (a rise of approximately 2-1/2 ft. [75 cm] every 10 ft. [3 m]). Mow across the face of a slope, and never up and down.

- Slopes are a major factor related to slip and fall accidents that can result in severe injury. Operation on slopes requires extra caution. If you feel uneasy on a slope, do not mow it. For your safety, do not attempt to mow slopes greater than 15 degrees.
- Mow across the face of slopes, not up and down. Exercise extreme caution when changing direction on slopes.
- Watch for holes, ruts, rocks, hidden objects, or bumps which can cause you to slip or trip. Tall grass can hide obstacles. Remove all objects such as rocks, tree limbs, etc., which could be tripped over or thrown by the blade.
- Always be sure of your footing. A slip and fall can cause serious personal injury. If you feel you are losing your balance, release the switch control lever immediately.
- Do not mow near drop-offs, ditches, or embankments; you could lose your footing or balance.

OPERATING YOUR LAWN MOWER

MOWING TIPS

NOTE: A sharp blade will greatly enhance the performance of the mower, especially when cutting high grass. Be sure to check the blade and to sharpen it at least once per year, as described in the Maintenance section.

- Verify that the lawn is free of stones, sticks, wires, and other objects that could damage the blades or the motor. These objects could be accidentally thrown by the mower in any direction, and could cause serious personal injury to the operator and to others.
- In order to prevent electric shock, do not operate the mower in damp or wet conditions.
- Do not mow in circles. Travel back and forth across the lawn.
- When cutting thick grass, reduce walking speed in order to allow for a more effective cut and a proper discharge of the clippings. For a healthy lawn, always cut off one-third or less of the total length of the grass. The average lawn should be approximately 1-1/2 to 2" (3.8 to 5 cm) long during cool months, and more than 2" (5 cm) long during hot months. If there is growth, the lawn should be cut in the fall.

MULCHING TIPS

NOTE: ALWAYS INSPECT AREA WHERE MOWER IS TO BE USED AND REMOVE ALL STONES, STICKS, WIRE, BONES AND OTHER DEBRIS WHICH MIGHT BE THROWN THE ROTATING BLADE.

- Release switch to turn mower OFF when crossing any graveled area (stones can be thrown by the blade).
- Set mower at highest cutting height when mowing on rough ground or in tall weeds.
- For effective mulching, do not cut wet grass, as it tends to stick to the underside of the deck preventing proper mulching of grass clippings. New or thick grass may require a narrower cut. The ground speed should be adjusted to the condition of the lawn. If mowing has been delayed and the grass has been allowed to grow in excess of 4", mow twice to reduce the grass height to 3-3/4" maximum.
- Walk at a good, steady pace. Overlap your rows. Don't let the grass get too tall. If the grass gets too long start at the highest cutting position and work down to the desired cutting height.

WARNING

If you strike a foreign object, stop the motor and remove the key and battery. Thoroughly inspect the mower for any damage. Repair any damage before operating the mower. Excessive vibration of the mower during operation is an indication of damage. Thoroughly inspect the mower and repair any damage before operating the mower.

MAINTENANCE

REPLACING THE CUTTING BLADE (See Figure 12-13)

⚠ WARNING

Always protect your hands by wearing heavy gloves and/or wrapping the cutting edges with rags or other materials when performing any maintenance on the blades. ALWAYS remove the isolator key when servicing or transporting the mower.

Use only a GREENWORKS replacement blade.

- REMOVE BATTERY.
- While wearing leather padded gloves, wedge a block of wood between the blade and the mower deck in order to prevent the blade from turning when the nut is being removed.
- Using a 15 mm wrench or socket, loosen the blade nut (1) and remove the blade (4). Turn the nut "COUNTER-CLOCKWISE" to loosen it and "CLOCKWISE" to tighten it.
- Remove the blade nut (1), the square washer(2), the insulator washer(3), and the blade.
- To re-install the blade, position the blade with the cutting edges toward the ground. Assemble the blade nut, the square washer, and the insulator washer as shown. Using a 15 mm socket or wrench, turn the blade nut "CLOCKWISE" in order to secure the blade.

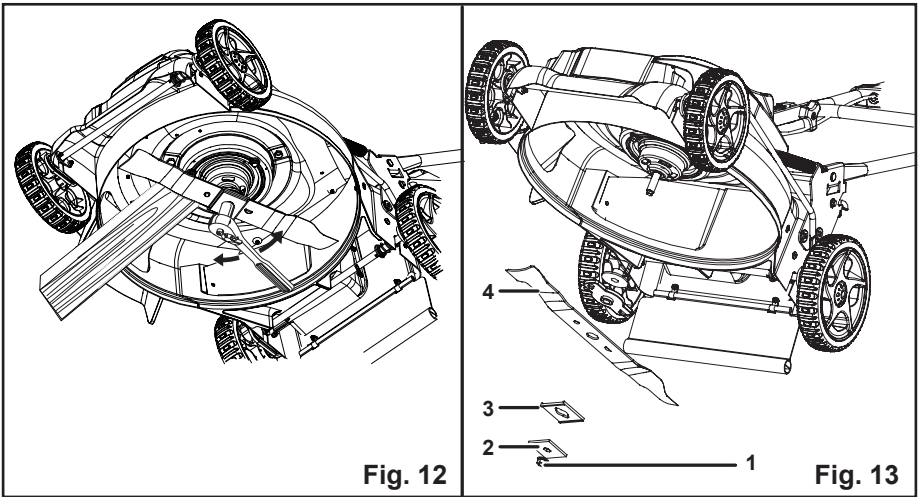

NOTE: Be sure to replace the parts in the exact order in which they were removed. When installing the cutting blade, verify that it is installed with the curved ends pointing toward the mower deck, and not toward the ground. Refer to the schematic drawing on page 32 of this manual.

MAINTENANCE

REPLACING THE BATTERY

The mower battery is designed for maximum life; however, like all batteries, it will eventually need to be replaced.

Charge the new battery pack before use. See Battery & Charger of this manual.

TO INSTALL A NEW BATTERY:

- Remove the isolator key.
- Carefully lift the old battery by the handle.
- Install the new battery pack.
- Take the old battery pack to a recycling center that accepts lead acid/lithium ion batteries. Never dispose of battery in fire or regular household trash.

STORAGE

CLEAN THE MOWER

WARNING

To reduce the risk of electric shock, do not expose the mower to water.

The underside of mower deck should be cleaned after each use as grass clippings, leaves, dirt and other debris will accumulate causing rust and corrosion.

- Remove any buildup of grass and leaves on or around the motor cover (do not use water). Wipe the mower clean with a dry cloth occasionally.
- If debris build up on the underside of the unit while in use, stop the motor and disconnect it from the power supply. Tilt the mower forward, or on its side, and scrape it clean with an appropriate tool.

STORING THE MOWER

The following steps should be taken in order to prepare the lawn mower for storage.

- Clean the mower as described in the previous section.
- Inspect the blade, and replace it or sharpen it, if required (refer to the Maintenance section).
- Lubricate the mower (refer to the Maintenance section).
- Store the mower in a dry, clean location. Do not store it next to corrosive materials, such as fertilizer or rock salt.
- Store the mower indoors, in a cool, dry place, out of the reach of children. Do not cover the lawn mower with a solid plastic sheet. Plastic coverings trap moisture around the mower, which causes rust and corrosion.

The handle may be folded away completely for storage.

- Lift up the cam locks on the sides of the handle to unlock, and fold the upper handle down.
- Pull outwards on each side of the lower handle, and lift the sides of the lower handle past the edges of the handle mounting brackets. Fold the lower handle forward. Make sure not to bend or kink the power cord.
- Remove the battery and store it in a cool dry location, if possible. Charge the battery every two months when not in use in order to increase its life.
- Remove the key and store in a secure location out of the reach of children. Removal of the battery is not required for storage.

WARNING

This battery must be charged when in storage to maintain running life.

ENVIRONMENTALLY SAFE BATTERY DISPOSAL

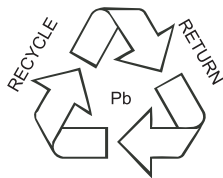

The following toxic and corrosive materials are in the batteries used in this battery pack: a toxic material.

⚠ WARNING

All toxic materials must be disposed of in a specified manner to prevent contamination of the environment. Dispose of batteries according to local by-laws because this Lead-acid batteries contain lead and sulphuric acid that are hazardous materials.

⚠ WARNING

If the battery pack cracks or breaks, with or without leaks, do not recharge it and do not use. Dispose of it and replace with a new battery pack. **DO NOT ATTEMPT TO REPAIR IT!** To avoid injury and risk of fire, explosion, or electric shock, and to avoid damage to the environment:

- Cover the battery's terminals with heavy-duty adhesive tape.
 - **DO NOT** attempt to remove or destroy any of the battery pack components.
 - **DO NOT** attempt to open the battery pack.
 - If a leak develops, the released electrolytes are corrosive and toxic. **DO NOT** get the solution in the eyes or on skin, and do not swallow it.
 - **DO NOT** place these batteries in your regular household trash.
 - **DO NOT** incinerate.
 - **DO NOT** place them where they will become part of any waste landfill or municipal solid waste stream.
 - Take them to a certified recycling or disposal center.
-

SERVICE

- When servicing the mower, use only replacement parts that are available from the manufacturer. In order to obtain replacement parts, call the toll-free helpline, at 1-888-909-6757. The use of parts that do not meet the original equipment specifications may lead to improper performance, and may compromise safety.
- Before cleaning, repairing, or inspecting, verify that the blade and all moving parts have come to a complete stop. Remove the battery when making any adjustments or when any of the four wheels must be lifted off the ground.
- Follow the instructions for lubricating and changing accessories.
- Keep the handles dry, clean, and free of oil and grease.
- In order to reduce the risk of fire, keep the motor free of grass, leaves, and debris build-up.
- Check the blade and motor mounting bolts for proper tightness frequently. Visually inspect blade for damage (e.g., bent, cracked, or worn).
- For best and safest performance, maintain the mower with care. Keep the mower blade sharp and clean. Mower blades are sharp, and can cut. Wrap the blades or wear gloves, and use extra caution when servicing.
- Keep all nuts, bolts, and screws tight in order to be sure that the equipment is in safe working condition.
- Never tamper with safety devices. Check them regularly for proper operation.
- After striking a foreign object, stop the motor and remove the isolator key. Thoroughly inspect the mower for any damage. Repair any damage before operating the mower.
- The grass catcher components, discharge cover, and trail shield are subject to wear and damage, which could expose moving parts or allow objects to be thrown. As a safety precaution, check these components frequently, and immediately replace any parts that show signs of wear, or that are cracked or broken. Use original equipment manufacturer's (OEM) parts only, as listed in this manual.
- When it is not in use, store the mower indoors in a dry area, and out of the reach of children.

WARNING

ALWAYS REMOVE KEY AND BATTERY WHEN SERVICING OR TRANSPORTING THE MOWER.

TROUBLESHOOTING

PROBLEM	POSSIBLE CAUSE	SOLUTION
The mower does not start.	The battery is not charged.	Charge the battery.
	The switch is defective.	Replace the switch (call the tollfree helpline, at 1-888-909-6757)
	Grass jammed at blade.	Remove battery; check under deck for jams.
	The battery is not attached to the motor.	Check the connection between the motor connector and the battery.
	Battery may require service or replacement.	Call toll free helpline, at 1-888-909-6757 or replace battery.
	Isolator key is not installed.	Insert the isolator key.
The mower cuts the grass unevenly.	The lawn is rough or uneven.	Check the mowing area.
	The cutting height is not set properly.	Move the wheels to a higher setting.
The mower does not mulch properly.	Wet grass clippings are sticking to the underside of the deck.	Wait until the grass dries before mowing.
	The mulching plug is missing.	Install the mulching plug.
The mower is hard to push.	The grass is too tall, or the cutting height is too low.	Raise the cutting height.
	The rear of the mower housing and the blade are dragging in thick grass.	Empty the grass clippings from the grass catcher bag.
The mower is excessively noisy and vibrates.	The motor shaft is bent.	Stop the motor, and inspect for damage.
	The blade is unbalanced.	Repair before restarting. If vibration persists, call the toll free helpline (1-888-909-6757)

LIMITED FOUR-YEAR WARRANTY



GREENWORKS™ hereby warranties this product, to the original purchaser with **proof of purchase**, for a period of four (4) years against defects in materials, parts or workmanship. GREENWORKS™, at its own discretion will repair or replace any and all parts found to be defective, through normal use, free of charge to the customer. This warranty is valid only for units which have been used for personal use that have not been hired or rented for industrial/commercial use, and that have been maintained in accordance with the instructions in the owners' manual supplied with the product from new.

Battery carries a one (1) year warranty against defects in workmanship and materials. Batteries must be charged in accordance with the operator's manuals directions and regulations in order to be valid.

ITEMS NOT COVERED BY WARRANTY:

1. Any part that has become inoperative due to misuse, commercial use, abuse, neglect, accident, improper maintenance, or alteration; or
2. The unit, if it has not been operated and/or maintained in accordance with the owner's manual; or
3. Normal wear, except as noted below;
4. Routine maintenance items such as lubricants, blade sharpening;
5. Normal deterioration of the exterior finish due to use or exposure.

GREENWORKS HELPLINE (1 888 90WORKS):

Warranty service is available by calling our toll-free helpline, 9 a.m. to 5 p.m. EST. Monday – Friday at **1 888 909 6757 (1 888 90WORKS)**.

TRANSPORTATION CHARGES:

Transportation charges for the movement of any power equipment unit or attachment are the responsibility of the purchaser. It is the purchaser's responsibility to pay transportation charges for any part submitted for replacement under this warranty unless such return is requested in writing by GREENWORKS.

EXPLODED VIEW

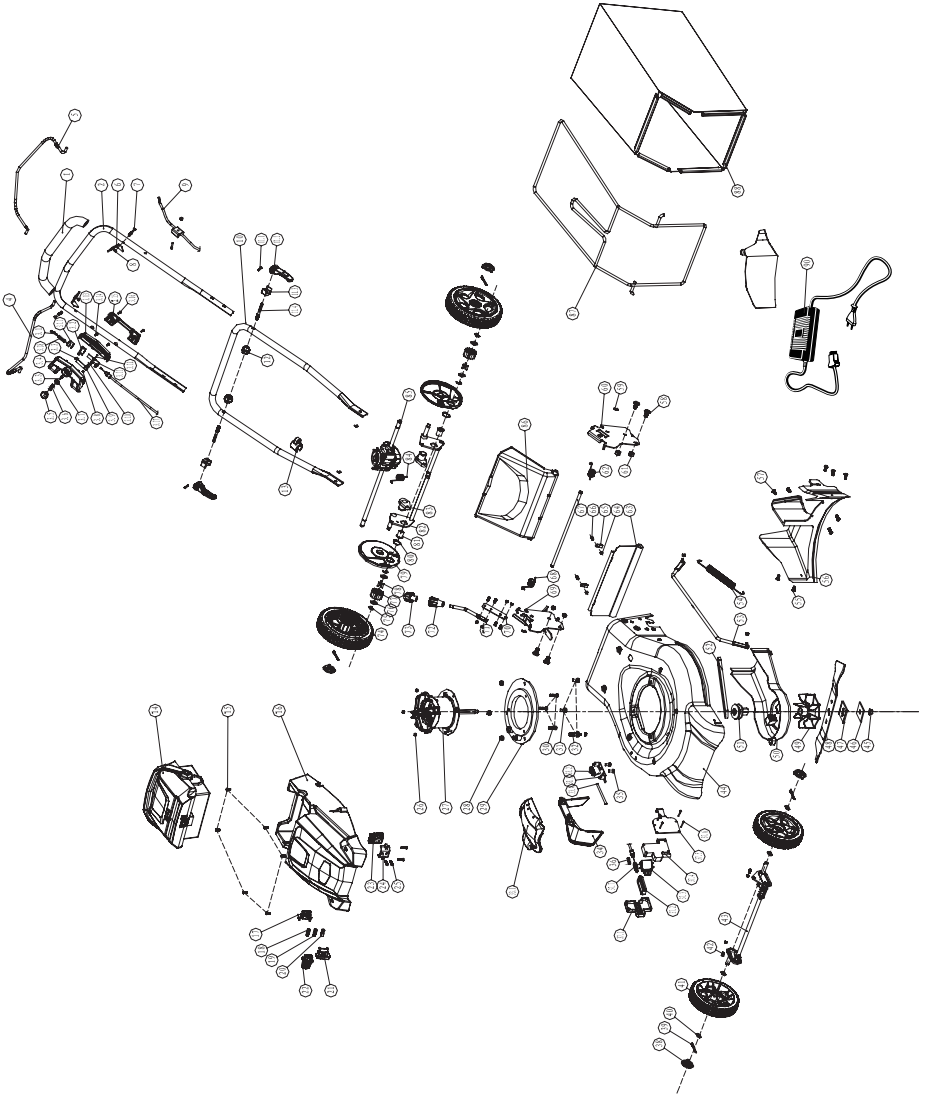

PARTS LIST

ITEM NO.	PART NO.	DESCRIPTION	QTY
1	34115250	Foam grip	1
2	33303250-8	Upper handle	1
3	31110487	Motor engagement box assy.	1
3.1	31901250	Start cable (short)	1
3.2	34118250	Block	1
3.3	3220735	Screw	3
3.4	34110250-3	Upper cover, motor engagement box	1
3.5	34129250-2	Start button	1
3.6	33401229	Spring	1
3.7	34123469	Compressor	1
3.8	3221305	Nut M3	1
3.9	33315250	Spring	1
3.10	33316250	Torsion spring	1
3.11	33317250	Slide block	1
3.12	32204250	Bolt M3×20	1
3.13	34111250-3	Lower cover I, motor engagement box	1
3.14	32204113	Screw ST4.2×20-C	2
3.15	34116250-3	Lower cover II, motor engagement box	1
3.16	3220346	Screw ST3.5X20-C	2
3.17	31902469	Start cable (long)	1
3.18	33318250	Compressed spring	1
4	33305469-4	Power lever	1
5	33308469-4	Self propel lever	1
6	33323250-1	Bail stop	2
7	32208234	Bolt M5×30	2
8	3220439	Lock nut M5	10
9	31901469-1	Drive cable	1
10	33302463-4	Lower handle	1
11	31103487	Cam lock assy.	2
11.1	32901466	Dowel pin 5×26	2
11.2	34102466-3	Cam lock lever	2
11.3	34103466-3	Cam lock block	2
11.4	33201466	Cam lock bolt	2
12	34106467-1	Handle knob	2
13	34135469	Cord guide	2
14	31102492	Battery	1
15	32206250	Screw M5×12	6
16	34105492	Upper housing	1
17	34107492	Key holder B	1
18	36503487	Cord, red	1
19	31127469	Cord, black	1

PARTS LIST

ITEM NO.	PART NO.	DESCRIPTION	QTY
20	36503487	Cord, red	1
21	34106492	Key holder A	1
22	31201470	Key	1
23	36501229	Connector	1
24	34105462	Retaining seat	1
25	32210131	Screw ST4×14-F	2
26	3220537	Lock nut M6	7
27	36101492	Motor	1
28	32208261	Nut M8	2
29	34101463-1	Motor bracket	1
30	3220135	Bolt M6×25	3
31	3220406	Bolt M8×16	2
32	32202234	Bolt	1
33	31104487	Side discharge cover assy.	1
33.1	34102467-1	Side discharge cover	1
33.2	33331250	Side discharge torsion spring	1
33.3	34107250	Side discharge bracket	1
33.4	33308250	Side discharge axle	1
34	34103467-1	Side discharge chute	1
35	3220136	Bolt M6X8	2
36	33332250	Spring	1
37	31106250-3	Switch box assy.	1
37.1	34134250-1	Upper cover, switch box	1
37.2	34114250	Switch box slide block	1
37.3	36302470	Switch	1
37.4	34113250	Lower cover, switch box	1
37.5	33325250	Switch box bracket	1
37.6	32205404	Screw ST4.2×35-F	4
38	34106488	Wheel cover	4
39	3290135	Pin ϕ 2.5	4
40	3220898	Washer	4
41	31102488	7" wheel assy.	2
42	3220435	Screw M5×15	6
43	33901234-1	Front wheel axle	1
44	31301492	Deck	1
45	32902250	Lock nut M12	1
46	33322250	Square washer	1
47	3410535	Insulator washer	1
48	33301487	19" blade	1
49	34101492	Fan	1
50	34103463	Belt guard	1

PARTS LIST

ITEM NO.	PART NO.	DESCRIPTION	QTY
51	33901250	Belt pulley	1
52	34201234-1	Drive belt	1
53	33302234-4	Link bar	1
54	33312234	Tension spring	1
55	32205234	Screw ST6.3×16-F	6
56	34102234-1	Rear baffle	1
57	32210234	Screw ST6.3×12-F	3
58	32207234	Bolt	4
59	3290506	Retaining ring 8	2
60	33905234-1	Height adjustment plate (left)	1
61	32910131	Nut M10	5
62	33310234	Torsion spring (left)	1
63	34101467	Rear shield	1
64	3221237	Lock nut M4	2
65	3330490-1	Wire clip	1
66	3220518	Screw M4×12	2
67	33201234	Rear cover rod	1
68	33313234	Torsion spring (right)	1
69	33904234-1	Height adjustment plate (right)	1
70	33303234	Spring plate	1
71	33304234	Height adjustment lever	1
72	34114227-5	Height adjustment knob (lower)	1
73	34113227-5	Height adjustment knob (upper)	1
74	31101492	Wheel	2
75	32905234	Retaining ring 10	4
76	32908234	Washer	4
77	33204234	Pinion gear	2
78	32906234-1	Dowel pin	6
79	34104234-1	Wheel dust cover	2
80	32902234	Retaining ring	2
81	32101234	Bushing	2
82	33903234-1	Rear wheel bracket	1
83	33908234	Housing	2
84	33901472	Tension spring	1
85	31103473	Transmission assy.	1
86	34101234-4	Rear door	1
87	33907234-5	Bag frame	1
88	34902234-10	Grass bag	1
89	34106463-2	Mulching plug	1
90	36601492	36V charger	1



TOLL-FREE HELPLINE: 1-888-90WORKS (888.909.6757)

Rev: 01 (10-12-12)

 Printed in China on 100% Recycled Paper