



Features:

- Alternates water flow between 2 or 3 discrete shower outlets
- 4/3 Port Diverter allows for 1 inlet and 3 outlets
- 3/2 Port Diverter allows for 1 inlet and 2 outlets
- 1/2" NPT inlets and outlets

Description	Handle Type	Product Number
3/2 Port Diverter Valve	Lever	848/177 
4/3 Port Diverter Valve	Lever	848/178 

Available Finishes	Finish Code
Polished Chrome	100
Brushed Nickel	144
Platinum Nickel	150

Rough & Trim Options	Handle Type	Product Number
Trim Only	Lever	848/O77 
Rough Only - 3/2 Port Diverter		876/OO3/191
Rough Only - 4/3 Port Diverter		876/OO4/191

Extension Kit	Product Number
Diverter Valve Extension Kit	H3990.191

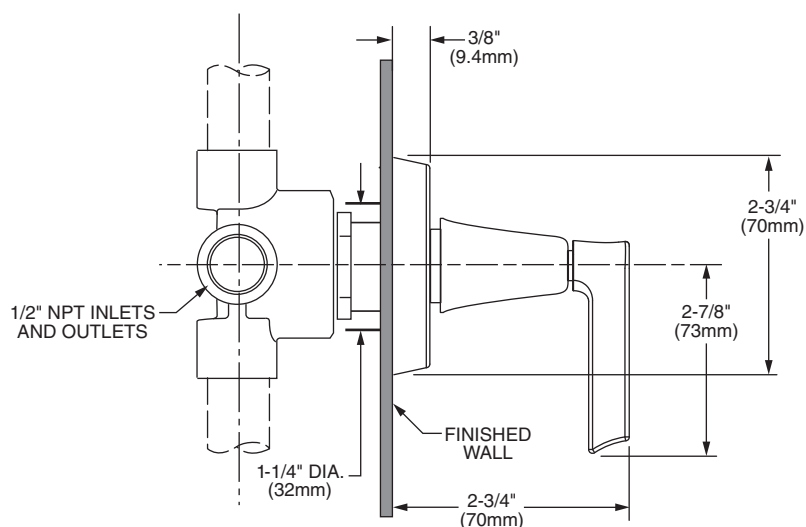

IMPORTANT: These measurements are subject to change or cancellation. No responsibility is assumed for use of superseded or voided pages.

CODES & STANDARDS

These products meet and exceed the following codes and standards:

- ASME A112.18.1
- CSA B125.1



Meets the American Disabilities Act Guidelines and ANSI A117.1 Requirements for the physically challenged.

