

## JET JWP-16OS 16" Open Stand Planer

The JET 16" Open Stand Planer combines our heavy cast iron construction, user friendly design and powerful motors with the economy of an open, all-steel stand. The result is a tough, precise, and value-laden planer that comfortably handles the workload of active woodworking shops. The JET 16" Open Stand Planer comes standard with our 5-year warranty.

### Open Stand



We even added cast iron feet to the open stand, complete with pre-cast holes for bolting the machine to a suitable floor as an option.

The open leg stand is made from heavy gauge steel for the strength and rigidity necessary to support this 430 lb. machine. The stand is easy to assemble and features wide, generously sized, cast iron feet that further increase stability. Each foot has a hole for bolting the JET 16" Open Stand Planer to a suitable floor (optional). The open stand also contributes to the JET 16" Planer's space-saving overall dimensions of 48" x 32" x 51"!

### Power on Top

The JET 16" Open Stand Planer features a 3HP TEFC (totally enclosed fan cooled) 1Ph, 230V motor, rated using a continuous duty cycle for a true indication of its output. The motor power is delivered to the cutterhead and feed rollers through a triple V-belt drive that insures smooth, slip-free operation. Because the motor is on top, the belts are relatively short and when needed, the tension adjustment mechanism is easily accessible.

The motor is controlled by a heavy-duty magnetic switch, also mounted near the top of the JET 16" Open Stand Planer where it is always within easy reach. This magnetic switch helps protect the motor from potentially damaging power variations. Should the power fall to dangerous levels, the switch is designed to automatically shut the JET 16" Open Stand Planer down, preventing damage to the motor. Another benefit of this magnetic switch is that should the power go out, the machine will not start unexpectedly when the power is restored. The operator must push the "Start" button to restart the JET 16" Open Stand Planer.



The JET 16" Open Stand Planer has all the power and accuracy needed to make dead flat panels for users of all skill levels.



The 3HP motor and magnetic switch are up top and easy to use and service.

## In the Head

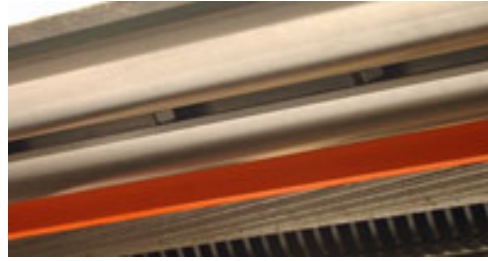

The views from under the head, from the front (left) and from the rear (right) show the anti-kickback fingers, feed rollers and cutterhead that make this such a consistent performing machine.

At the heart of the JET 16" Open Stand Planer is the cutter head and feed rollers. Here again we applied tried and true JET manufacturing technology to

insure exacting performance and durability.

First on the infeed side of the cast iron cutterhead housing is a row of gravity-operated steel anti-kickback fingers. These specially designed plates help prevent the wood from being ejected should something go wrong during planing. This row of anti-kickback fingers run the full width of the cutterhead housing to control any size wood up to the full 16" width capacity of the JET 16" Open Stand Planer.

Next is the serrated steel infeed roller. The spiral pattern of the serrations insures a solid grip on the wood as it enters the JET 16" Open Stand Planer while maintaining a consistent feed rate for the best possible cut quality.

Next is the 2 7/8"-diameter cutterhead that spins at 4,500 RPM. Precisely machined from solid steel, this cutterhead is exceptionally tough and has the weight to impart a flywheel effect that enhances the cutting action of the knives.



A closer look (left) shows an individual knife with its gib bar retainer and the jacking screw that makes adjusting the critical knife height easier. We even include an easy to use knife setting gauge (right) that helps get all three knives perfectly set so they work together.

The cutterhead has three full-width knives, set into precisely machined channels. Each knife is retained by a full width gib secured with six locking screws. To make critical knife height adjustments easy yet precise we added jacking screws at the outer ends of each knife. We also include an easy to use knife setting gauge that simplifies adjusting the knives evenly and insuring all three are at the same height. These settings are critical to how a planer performs and the combination of our jacking screws and setting gauge help you keep your JET 16" Open Stand Planer in top operating condition with minimal effort.



The two speed gearbox controls the 20 FPM and 16 FPM rates. Changing speed is done while the machine is running (only) by simply pulling the knob out or pushing it in.

Just after the cutterhead is the adjustable chip breaker. This simple but effective device helps reduce the size of the debris coming off of the cutterhead to help maintain an efficient flow of debris through the 4"-diameter port.

Last is the outfeed roller. This steel roller keeps the stock moving after the cut has been made, pushing it out onto the outfeed table extension. Its smooth surface grips the freshly cut surface of the wood without leaving marks.

Both the infeed and outfeed rollers are fully adjustable for height and spring pressure. Those adjustments are intentionally easy to reach and make because fine-tuning feed roller pressure and height substantially improves the

performance of any planer.

The JET 16" Open Stand Planer has two feed rates, controlled by a gearbox on the side of the cutterhead housing. A simple push-pull knob makes changing feed rates (only while the machine is running) simple.

The faster 20 FPM (feet per minute) feed rate is most often used when making initial dimensioning cuts. When the material is close to its final thickness switching to the slower 16-FPM rate gives a surface-smoothing 13,500 cuts per minute.

### Cut Height Adjustments

The JET 16" Open Stand Planer has a maximum thickness capacity of 6" and a maximum full-width cut of 1/8"-deep to help prevent damage to the machine and over stressing the wood itself. Adjusting the cutterhead housing up and down controls the depth of cut. Four, 2"-diameter precision-machined steel columns, guide the cutterhead housing. Each column has a chain-driven lead screw within it that controls that corner of the cutterhead housing for maximum control and consistency.

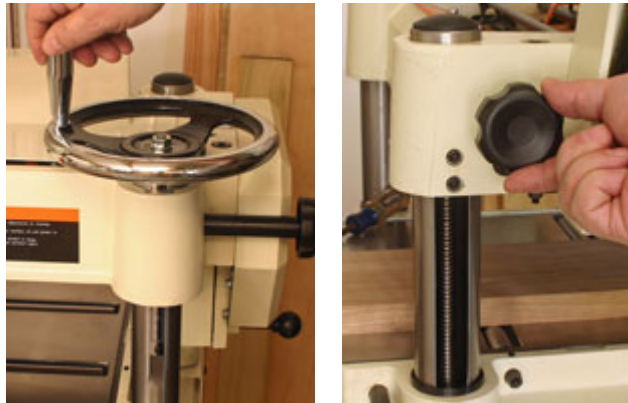

The large cast iron handwheel (left) makes adjusting cut depth easy. The locking knobs (right) secure the head assembly to the lead screws in each column

A large 8 1/2"-diameter cast iron handwheel with spinner handle operates the chain drive making height changes virtually effortless. Each full turn of the handwheel produces a cut

depth change of 0.0158" (4mm). A handy scale on the column makes presetting initial cut heights easy.

The cutterhead housing assembly is secured in position when making cuts with a pair of knobs that lock it on the front and rear columns. When engaged, these large knobs secure the head assembly to the lead screws for precise cuts.

## Table and Extensions



With the included three-roller extension tables there is 48" of support for the wood as it goes through.

The JET 16" Open Stand Planer has a 20 ½"-long by 16"-wide cast iron table that supports the wood. We added a pair of fully adjustable in-table rollers that help rough stock move through the JET 16" Open Stand Planer smoothly. The height adjustments for the table rollers are at the edge of the table where they are easily accessible.

A pair of double roller extension tables are included that extend the overall material support length to 48". Each table features adjusting screws at their mounting flange that allow fine-tuning the extension rollers to be level with the main table surface.

## Mobility

In many wood shops, the ability to park machines out of the way and then bring them out for use is important. We offer the JMB-UMB-HD (#708119) Universal Mobile Base that is designed to carry the JET 16" Open Stand Planer safely while making it easy to move where needed. A pair of fixed wheels at one end and full-swivel casters at the other make "driving" the JET 16" Open Stand Planer where needed safer and easier. All four wheels lock to keep the JET 16" Open Stand Planer stable during use.



The heavy duty JET mobile base kit handles the weight of the Open Stand Planer and makes moving it around the shop safe and easy.

The JET 16" Open Stand Planer has the capacity, precision and durability that make it an outstanding value. The quality construction and design mean the JET 16" Open Stand Planer will enhance your woodworking today and long into the future.