

# Assembly Instructions For

# F2697/3

(E) 5/11

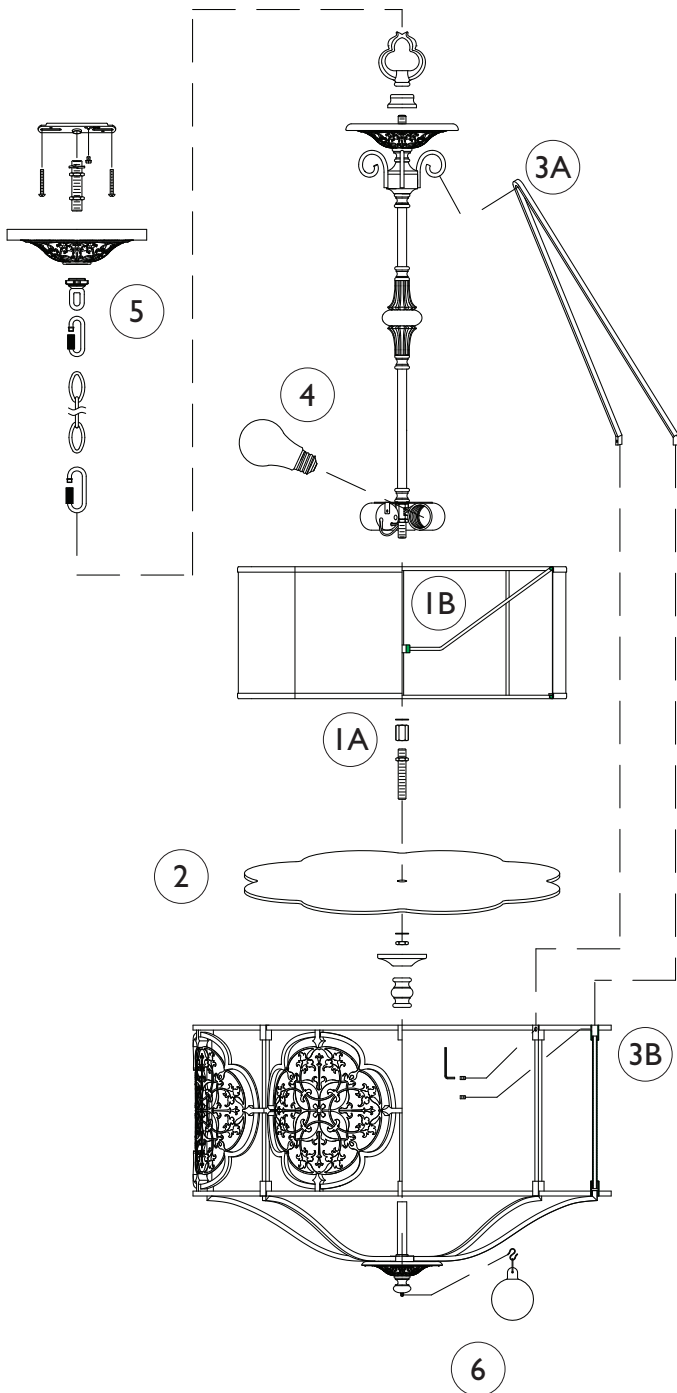

## IMPORTANT TURN OFF THE POWER AT THE MAIN FUSE OR CIRCUIT BREAKER BOX BEFORE STARTING INSTALLATION

Carefully unpack and identify all parts before assembly. Bulbs not included.

1. A. Install a hex nut onto one end of long threaded pipe leaving about 3/8" (10 mm) of thread exposed.  
B. Install inner shade onto bottom of socket assembly by fastening with a lock washer and threaded pipe. Tighten hex nut.
2. Install glass plate onto bottom of inner shade by fastening with a round washer and lower column. **IMPORTANT: DO NOT OVER TIGHTEN.**
3. A. Hook top of arm onto center column.  
B. Then install bottom ends of arm by fastening onto corresponding holes on top of main frame. Use enclosed hex key to tighten set screws.  
C. Repeat other arms.
4. Install light bulbs (not included). See relamping label located at socket area for type and maximum allowed wattage.
5. Follow enclosed supplement installation instructions for electrical and fixture installation onto house outlet box. If you do not have an outlet box at desired location to attach the fixture then hire a qualified electrician to create one.
6. Hang glass drop at bottom of finial.  
**NOTE:** To replace broken drop or pin, gently bend open pin, remove broken drop or pin, hook new one, then close back pin. Avoid bending pin into sharp angle.



**MURRAY  
FEISS**

GENERATION  
BRANDS

