

SPECIFICATIONS

30" Sedona Vanity Top

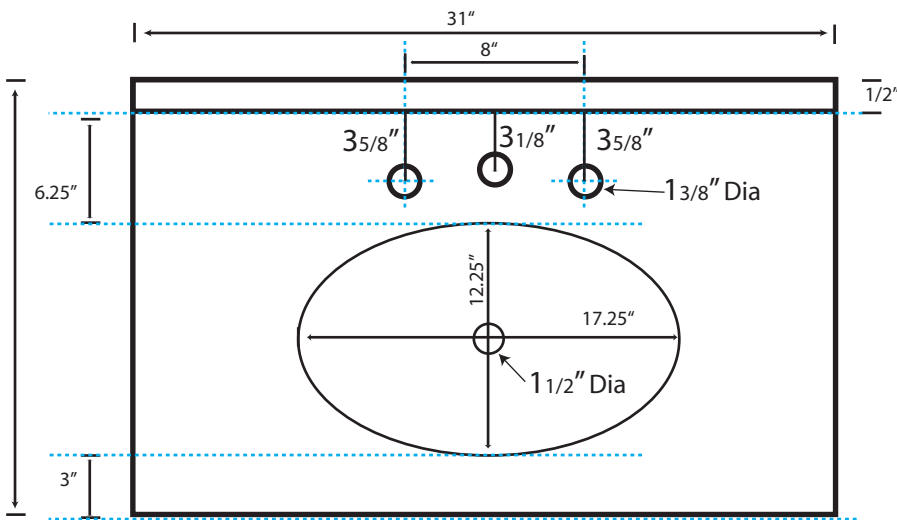

FEATURES

- * 31" x 22" OD
- * Hand hammered 16 gauge copper
- * 3.5" Backsplash
- * Basin 17.25" x 12.25" x 5.25"
- * Pre-drilled for 8" faucet spread
- * Dimensions are not exact and may vary 1/2"

FINISHES

- * Antique - VNT302
- * Brushed Nickel - VNT305

COORDINATING ACCESSORIES

- * Drains: DR120, DR140, DR160

STANDARDS COMPLIANCE

- * IAPMO Listed

IMPORTANT

Due to the handcrafted nature of this product, it will vary in finish, texture, hammering, and other details. Dimensions may vary up to 1/2". We strongly recommend that you wait for the actual product before making any installation cuts.