

Open Towel Ring, Double Garment Hook, Single Post & Reserve Tissue Holder

Installation Instructions

Model No. 29-10, 29-13, 29-27, 29-30

Recommended Installation by a Professional Contractor

1. Hold the BASE (1) up to desired location and mark the hole locations on flange. (See Fig. 1)

2. Drill holes in wall at points marked using the appropriate drill size:

- Wood Screw (#6 x 2") - use: 3/32" Drill
- Toggle Screw (6-32 x 3") - use: 3/8" Drill

3. Temporarily place the POST (5) onto the BASE(s) (1) to check alignment. If necessary, loosen the lower screw on BASE(S) (1) and adjust. Retighten screw.

4. Fasten BASE (1) to wall using either WOOD/TOGGLE SCREWS (2). (See Fig. 2)

5. Place ESCUTCHEONS (3) onto the base of END POST (4). (See Fig. 3)

5a. Open Towel Ring: Slide END POST (4) onto BASE (1) and secure into place with SETSCREW (5). (See Fig. 4)

5b. Double Garment Hook: Slide END POST (4) onto BASE (1) and secure into place with SETSCREW (5). (See Fig. 5)

5c. Single Post Tissue Holder: Slide END POST (4) onto BASE (1) and secure into place with SETSCREW (5). (See Fig. 6)

5d. Reserve Tissue Holder: Slide END POST (4) onto BASE (1) and secure into place with SETSCREW (5). (See Fig. 7)

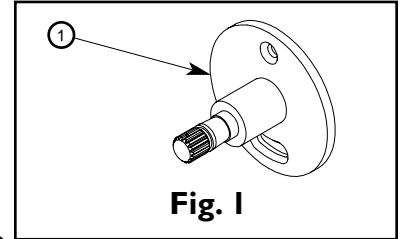

Fig. 1

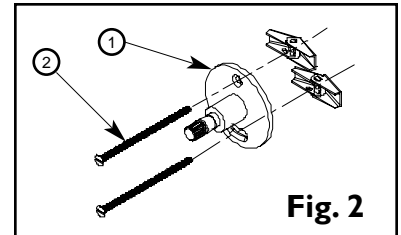

Fig. 2

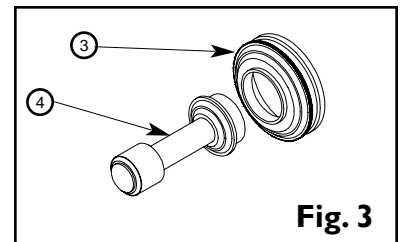

Fig. 3

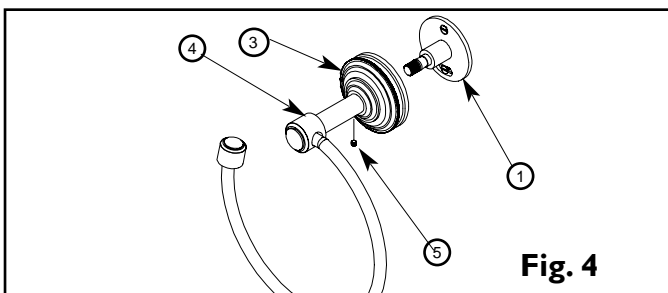

Fig. 4

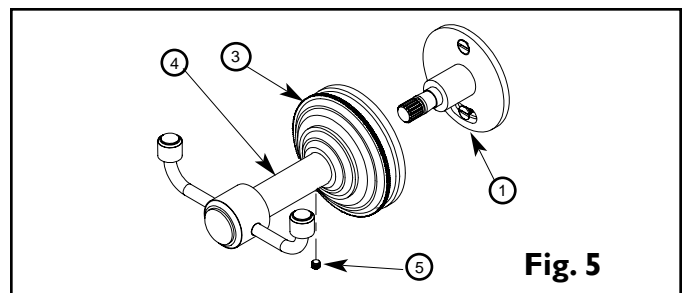

Fig. 5

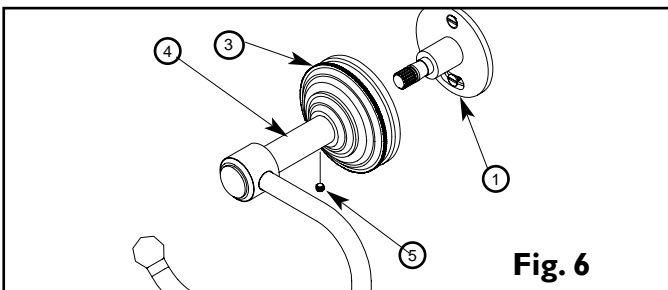

Fig. 6

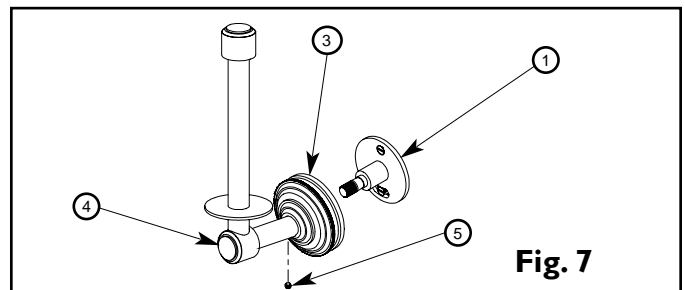

Fig. 7

NEWPORT BRASS.
The Luxury of Style

(949)417-5207

Santa Ana CA 92705

www.brasstech.com