



Incandescent

Bollard

Landscape

Type _____

-31

P5205



Finish

Catalog
No.

Black

Lamping

Dimensions (Inches)

A

B

P5205

-31

1 (m) 60w

5

8-1/4

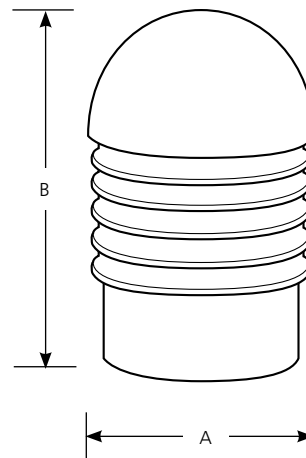

Specifications:

General

- Etched glass two piece with black painted top: 4-7/8" dia., 6-1/2" ht.
- Powder coat Black (-31) finish
- Aluminum construction

Mounting

- Mounts on landscape post (P5313-31 or P8562-31), stake (P5233-31), or approved weatherproof box (order separately)
- 1/2" NPS thread mount

Electrical

- Medium base porcelain socket
- Pre-wired

Labeling

- UL-CUL Wet location listed

Progress Lighting
701 Millennium Blvd.
Greenville, South Carolina
29607

www.progresslighting.com

Rev. 01/15