



LED **4" Open Trim** **Recessed**  
 New Construction and Remodel  
 Wet Location

Type \_\_\_\_\_

-28/30KSTR2

P8080

Catalog No	Finish	3000K LED	LED
	White	Color Temp	Generation
P8080	-28	30K	STR2

Lamp Wattage Housing	Wattage
P830-TG	9w
P831-AT	9w
P832-TG	9w
P830-LED	9w
P831-LED	9w
P832-LED	9w

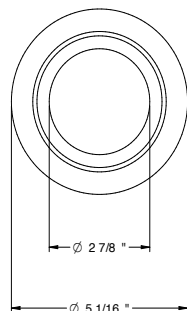
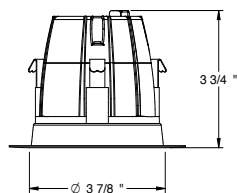

The P8080 is ideal for use in both new construction as well as remodel/retrofit applications. Light output is comparable to that of typical downlight lamps providing up to 75% energy savings. The P8080 is equipped with both an Edison base adapter and quick link allowing easy installation in many standard incandescent cans, in addition affording compliance to California title 24 and IECC lighting power density (w/ft<sup>2</sup>) requirements when used with the P831-LED housings (purchased separately).

**Specifications:**

Trim Assembly

- Frosted acrylic lens controls direct glare from the LEDs
- Easy "Push" installation with (3) friction spring clips.
- In addition to the Progress P830-TG, P831-AT, P832-TG, P830-LED, P831-LED, P832-LED, the P8080 fits in most competitive 4" housings, see ProgressLED trim compatibility guide for a complete list of classified housings.

Lamping

- 8.8 watt input power
- Lumen output: 555 lumens. Absolute photometry conducted per LM-79 for solid state luminaires
- Lumen output and distribution comparable to a 50w R20 incandescent lamp
- CRI is 80+ rivaling CFL
- 35,000 hours life based on 70% lumen maintenance (TM-21)
- Lamp contains no mercury
- Suitable for use in IC or NON-IC Applications with 25°C (77°F) continuous room side ambient temperature.

Electrical

- Class 2 driver, compliant to FCC 47CFR part 15 Class B, Class A noise rating, >0.90 Power Factor
- Trim comes with attached quick link for use with E26 Edison Base adapter whip (provided) or P830-LED, P831-LED, P832-LED housings (purchased separately)
- Flicker-free dimming to 20% with most standard incandescent dimmers (See Dimming Notes)
- 120VAC input, 50/60Hz

Labels

- cETLus classified for wet location
- RoHS



Progress Lighting  
 701 Millennium Blvd.  
 Greenville, South Carolina  
 29607

**ELECTRICAL DATA P8080-28/30KSTR2**

Input Voltage	120V
Input Frequency	57-63 Hz
Input Current	0.08A
Input Power	8.8W
Constant Current Output	190mA
Power Factor	>0.90
THD	<20%
EMI Filtering	FCC 47CFR Part 15, Class B
Operating Temperature	-30°C to 60°C
Dimming	Yes*
Over-voltage, over-current, short-circuit protected	
*See Dimming Notes for more information	

**P8080-28/30KSTR2**

LED Light Engine: 3000K 82 CRI  
 System Wattage: 8.8  
 Fixture delivered lumens: 556  
 Fixture Efficacy: 63  
 Spacing Criteria: 1.1

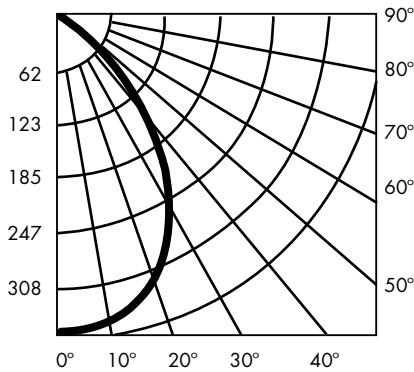

DEG	CANDELA
0	360
5	357
15	336
25	286
35	215
45	124
55	58
65	26
75	11
85	4
90	0

ZONE	LUMENS	%LUMINAIRE
0-30	260.9	46.9%
0-40	388.3	69.8%
0-60	520.2	93.4%
0-90	556.7	100.0%

Test No. Intertek Report 100672234CRT-001  
 Tested at 25°C Ambient in accordance to IESNA LM-79-2008

**DIMMING NOTES:**

ProgressLED integral driver is designed to operate with most standard dimmers including incandescent 120V line voltage (forward phase-leading edge) dimmers as well as 120V electronic low voltage (ELV) (reverse phase-trailing edge) dimmers. Dimming capabilities will vary depending upon the dimmer control used.

Manufacturer	Model	Type	P/N	Max Load
Lutron	Skylark®	600W Incandescent	S-600P	3
	Skylark	600W Magnetic Low Voltage	SLV-600P	3
	Skylark	300W Electronic Low Voltage	SELV-300P	6
	Diva®	600W Incandescent	DV-600P	3
	Diva	1000W Incandescent	DV-10P	3
	Diva	600W Magnetic Low Voltage	DVLV-600P	3
	Diva	300W Electronic Low Voltage	DVELV-300P	6
	Diva	150W LED	DVCL-153P	8
	Skylark	150W LED	CTCL-153P	8
Leviton	Illumatech®	600W Incandescent	IPI06	3
	Trimatron®	600W Incandescent	6683-1W	3
	Decora®	600W Incandescent	6631-L	3
	Vizia®	600W Incandescent	VPI06-1LW	3
	Acenti®	600W Incandescent	ATI06-1LW	3
Cooper	Aspire®	600W Incandescent	9530DS-K	3

**COMPATIBILITY OF 4" RECESSED HOUSINGS:**

ProgressLED modules are cCSAus classified for use with Progress and most competitive recessed cans (with "A" and "B" dimensions) including:

- |                     |            |
|---------------------|------------|
| <b>Progress</b>     | Lithonia   |
| Capri               | Lumapro    |
| Commercial Electric | Luminaire  |
| Elco                | Nora       |
| Emerald             | Prescolite |
| Halo                | Sea Gull   |
| Intense             | WAC        |
| Jimway              | Juno       |

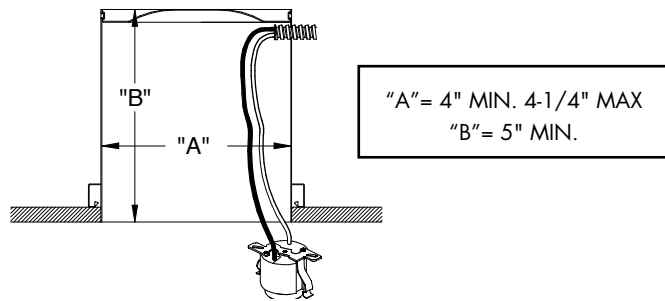

**NOTES**

1. Operation in ambient temperatures higher than those specified will shorten life and void warranty.
2. Warranty is limited to repair and replacement of defective parts of the LED system and does not include labor or installation. 5 year warranty requires product registration. Contact Technical Support for details.