

WINDSTER™

MODEL : H

OPERATION MANUAL



Please read and save this guide through before using your chimney hood. Store the guide away in a safe place so that you will know where it is, when you want to refer to it.

Table of Contents

A. Important Safety Instructions	P.01
B. Safety Notes	P.02
C. Tools and Materials Required	P.03
D. Parts supplied	P.04
E. Installation	P.05
F. Ventilation methods	P.06
G. Installation	P.09
H. Control Switch	P.12
I. Wiring Diagram	P.13
J. Trouble Shoutings	P.14
K. Specifications	P.15
L. Disassembly Diagram	P.15
M. Main Tenance	P.16
N. Size	P.17

Safety Note

Please wear "Safety Workman Gloves" for installation, cleaning, light bulb changing and dismantling to reduce the risk of any bodily injuries.

Safety Workman Gloves



A. IMPORTANT SAFETY INSTRUCTIONS

Read and Save These Instructions

I. Installation

DO NOT INSTALL WHEN YOU FIND THE OUTLOOKING / APPEARANCES OF THIS APPLIANCE ALREADY DAMAGED.

The installation in this manual is intended for qualified persons. **NEVER** attempt to install this appliance by yourself. Injury could result from installing the unit owing to lack of appropriate electrical and technical experience.

All electrical wiring must be properly installed, insulated and grounded. Old duct work should be cleaned or replaced if necessary to avoid the risk of a grease fire. Check all joints on duct work to insure proper connection and all joints should be properly taped.

II. Operation

Read all instructions in this manual before operating this appliance. Save this instructions for future reference.

Always keep safety grills and filter in place. Without these components, operating blower could catch on to hair, fingers and loose clothing.

NEVER dispose cigarette ashes, ignitable substances, or any foreign objects into blower.

NEVER leave cooking unattended. When frying, oil in the pan can easily over heat and catch fire. The risk of self-combustion is higher when the oil has been used several times.

NEVER cook on "open" flame under this appliance. Check deep-fryers during use.

III. Cleaning

The saturation of greasy residue in the blower and filters may cause increased inflammability. Keep this appliance clean and free of grease and residue build-up at all times to prevent possible fires.

Filters must be cleaned periodically and free from accumulation of cooking residue. Old and worn filters must be replaced immediately.
DO NOT OPERATE BLOWER WHEN FILTER ARE REMOVED.

NEVER disassemble parts to clean without proper instructions. Disassembly is only recommended to be performed by qualified persons only.

B. SAFETY NOTES

It is very important for your safety and safety of others. Provided following are many important safety messages in this manual and on your appliance. Always read and obey all safety messages. All safety messages will tell you what the potential hazard is, tell you how to reduce the chance of injury, and tell you how to reduce the chance of injury, and tell you what can happen if the instructions are not followed.

READ AND SAVE THIS INSTRUCTIONS.

WARNING : I. To reduce the risk of fire or electric shock, do not use this fan with any solid-state speed control device.

WARNING : II. To reduce the risk of fire, use only metal duct.

CAUTION : III. For general ventilating use only, do not use to exhaust hazardous or explosive materials and vapors.

To reduce the risk of fire, electric shock, or injury to persons, observe the following:

- Use this unit only in the manner intended by the manufacturer, if you have questions, contact the manufacturer.
- Before servicing or cleaning unit, switch power off at service panel and lock service disconnecting means to prevent power from being switched on accidentally. When the service disconnecting means cannot be locked, securely fasten a prominent warning device, such as a tag to the service panel.
- Installation work and electrical wiring must be done by qualified person(s) in accordance with all applicable codes and standards, including fire rated construction.
- Sufficient air is needed for proper combustion and exhausting of gases through the flue (chimney) of fuel burning equipment to prevent back drafting. Follow the heating equipment manufacturer's guideline and safety standards such as those published by the National Fire Protection Association (NFPA), and the American Society for Heating, Refrigeration and Air Conditioning Engineers (ASHRAE), and the local code authorities.
- When cutting or drilling into wall or ceiling, do not damage electrical wiring and other hidden utilities.
- Dusted fans must always be vented to the outdoors.

To reduce the risk of a range top grease fire:

- Never leave surface units unattended at high settings. Boilover cause smoking and greasy spillovers that may ignite. Heat oils slowly on low or medium settings.
- Always turn hood on when cooking at high heat or when cooking flaming food (i.e. Crepes Suzette, Cherries Jubilee, peppercorn Beef Flamb.)
- Clean ventilating fans frequently. Grease should not be allowed to accumulate on fan or filter.
- Use proper pan size. Always use cookware appropriate for the size of the surface element.

To reduce the risk of injury to persons in the event of a range top grease fire, observe the following:

- **SMOTHER FLAMES** with a close-fitting lid, cookie sheet, or metal tray, then turn off the burner. **BE CAREFUL TO PREVENT BURNS**, if the flames do not go out immediately, **EVACUATE AND CALL THE FIRE DEPARTMENT.**
- **NEVER PICK UP A FLAMING PAN** - You may be burned.
- **DO NOT USE WATER**, including wet dishclothes or towels - a violent steam explosion will result.
- Use an extinguisher only if:
 1. You know you have a class ABC extinguisher, and you already know how to operate it.
 2. The fire is small and contained in the area where it started.
 3. The fire department is being called.
 4. You can fight the fire with your back an exit.

To get the best performance, the vertical clearance between the cook-top and the chimney hood should range from 28" to 36".

C. TOOLS AND MATERIALS REQUIRED

- Flat-blade and Phillips screwdrivers.
- Electrical wire and supplies to comply with local codes.
- Powered screwdriver or drill.
- Measuring tape and level.
- Adjustable wrench.
- Utility knife or cutter.
- Marker or pencil.

D. PARTS SUPPLIED



Upper standard chimney

Chimney Hood
(very with model).



Lower standard chimney



Air diverter
(Optional for Circulation)



Aluminium Filter(s)



Aluminium Duct Tube



Charcoal Filter
(Optional for circulation)

No	Description	Q'ty	No	Description	Q'ty
1	Main body (Body of Hood)	1pc	7	Body Hook	2pcs
2	Aluminium tube	1pc	8	Upper duct cover	1pc
3	Toggle Bolts <small>(additional 2 sets for charcoal filter mode)</small>	4 sets	9	Lower duct cover	1pc
4	Operation manual & Warranty card	1set	10	Φ4x16 tapping screw <small>(Φ4x16 for duct set)</small>	6pcs
5	Duct set	1set	11	Duct cover's fix panel /Ventilation Piece	1pc
6	Φ5x15 screws with washer <small>(use in figure C or E - for body of hood)</small>	4 sets	12	Φ4x10 tapping screw <small>(use in figure D or F - for chimney)</small>	6pcs

E. INSTALLATION

I. Venting Check

- Vent system must terminate to the outside (through roof or side wall), unless using a circulation system. (Optional for a recirculating air diverter and charcoal filter).
- Do not terminate the vent system in an attic or any other enclosed area.
- Recommended to use metal / flexible aluminum vent only.
- Never use plastic vent.
- Always Keep the duct clean to ensure the proper airflow (Fig.1).

II. Important :

Must measure following steps before installation.

1. Distance from the floor to the ceiling.
2. Distance between the floor to the counter top / stove.
3. Distance between the counter / stove.
4. Height of chimney hood and duct cover

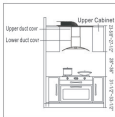

III. Tips for the most efficient and quiet operation:

- It is recommend that this Island hood be vented vertically through the roof through a 6" (15cm) diameter metal / aluminum vent work.
- The size of the vent should be kept in uniform.
- Do not use more than three 90° elbows.
- Make sure there is a minimum of 24" (61cm) of straight vent between the elbows if more than one elbow is used.
- **NEVER** install two elbows together.
- The length of vent system and number of elbows. Should be kept to a minimum to provide efficient performance.

- Use duct tape to seal all joints in the vent system.
- Use caulking to seal exterior wall or roof opening around the cap.

I. Important :

- A minimum of 6" diameter (standard for this chimney hood) must be used to maintain maximum airflow efficiency.
- ALWAYS, try to reduce the number of transitions and turns.
- If turns or transitions are definitely required : Install as far away from opening and as far apart, between 2 as possible.
- Reducing duct size will restrict airflow and decrease airflow, if no choice, thus reduce duct size as far away from opening as possible.
- It is important to install this chimney hood at the proper mounting height. Hood mounted too low could result in heat damage and fire hazard, while hood mounted too high will be hard to reach and will lose its performance and efficiency.

F. VENTILATION METHODS

A. DUCTING.

This island hood is originally set for venting through the roof or wall. Per request, it will be also available for ductless (Circulation) installation, to purchase optional circulating Air-diverter/ charcoal filter.

- Vent work can terminate either through the roof or wall , to vent through a wall , a 90° elbow is needed.

NOTE :

- **NEVER** exhaust air or terminate duct work into spaces between walls, crawl spaces, ceiling, attics or garages. All exhaust must be ducted to the **OUTSIDE**.
- Fasten all connections with sheet metal screws and tape all joints with Duct tape.

Example 1. Vertical roof venting.



Ducting through the roof

Example 2. Horizontal wall venting



Ducting through the wall

B. Ductless

- Ductless conversion is a "purifying" unit, a set of charcoal filter (Fig.2) and an airdiverter (Fig.3) are required in addition to it standard aluminum filter set. (Fig.2)
- The aluminum filter are intend to capture residue from cooking, the optional charcoal filter helps to purify fumes exhausted from cooking, and the optional air diverter redirects filter clean air back to the house.

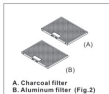

C. Charcoal filter Installation - optional

- Remove aluminum filters on island hood.
- Remove the safety mesh by unscrewing two screws, then position the charcoal filter and align the screw holes, reinstall and fasten two screws. (Fig.4)
- Reinstall the aluminum filters back to the Island hood. (Fig. 5)

NOTE : Charcoal filter is a consumer product must be replaced after 120 hours of use or every 2-3 months.

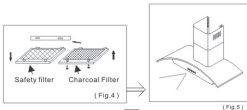

D. Connect power supply :

Important : Installation must be carried out by an authorized or qualified technician an applicable national and local codes.

- 120-Volt , 60Hz, AC only.
- This chimney hood must be properly grounded. Check with a qualified electrician if you are not sure whether the hood is properly grounded. DO NOT ground to a gas pipe.
- The hood must be connected with copper wire / plug only.
- Connect three wires according to its color. (Fig. 8)

BLACK TO BLACK (Hot)
WHITE TO WHITE (Neutral)
GREEN TO GREEN (Ground)

To house wires and Cap with wire connectors.

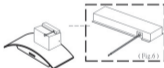

G. INSTALLATION

DUCTING:

WARNING : MAKE SURE THE CHIMNEY HOOD IS SECURE BEFORE RELEASING

CAUTION : PAY EXTRA ATTENTION TO SHARP EDGES ON THE CHIMNEY AND MINIMIZE CHIMNEY MOVE MENTS TO AVOID SCRATCHES ON THE CHIMNEYS.

1. Locate an optimal location to place the chimney hood. Mark the leveling points for two Body Hooks (Fig. 1) on the wall and drill two holes with diameter not exceeding 5/8" . Insert two toggle bolts then fasten two 4mm x 16mm, Tapping screws, reserve approximately 1/8" for the body hooks. Be sure to use appropriate anchors for your wall.

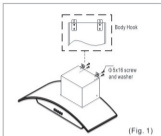

2. Find an optimal location for the chimney mounting bracket. The chimney mounting bracket must be placed directly above and align with the two body hooks, see (Fig.2) Drill two more holes with diameter not exceeding 5/8" and insert two toggle bolts. Secure the chimney mounting bracket with two 4mm x 16mm Tapping screws (Fig.2) Be sure to use appropriate anchors for your wall. Use four sets of 5mm x 16mm to install the body hook onto the hood (Fig. 1). Then hang the hood on the wall and tighten the screws.

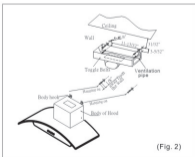

3. Install the Duct set using six 4mm x 16mm Tapping screws, then install aluminum tube (Fig. 3A/ 4B)

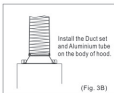
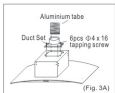

Ductless :

Air Diverter - Optional

Charcoal filter - Optional

If your model is Ducting system, please just skip the portion.

4. Find an optimal location for the Air Diverter. The air diverter **must be placed directly** above and align with the two body hooks, see Fig.4. Drill four more holes with diameter not exceeding $5/8''$ and insert four toggle bolts. Secure the air diverter with four 4mm x 16mm Screw with Washer to install the body hooks onto the hood. Then hang the hood on the wall and tighten the screws.

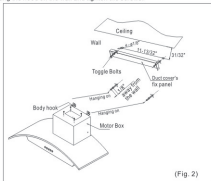

5. Install Aluminum Duct Tube as shown in Figure 5A. Installation of charcoal filter during this step is also recommended, please see Charcoal Filter Installation on Page.7.

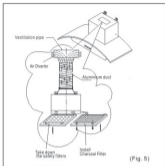

6. Connect the duct tube to the exterior exhaust system or the optional air diverter. Make sure all joints are secure and air tight. Use of duct tape is recommended.
7. Place Upper Chimney and Lower Chimney over the body of the hood as shown in Figure 7A (or Figure 7B if air diverter is present). Slide up the upper duct cover towards the chimney mounting bracket or the optional air diverter. Use four 4mm x 10mm Tapping Screws to secure the upper chimney onto the chimney mounting bracket or the optional air diverter. Finally secure the lower chimney to the hood body by using.

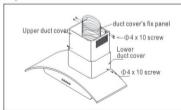

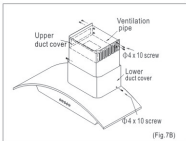

H. CONTROL SWITCH



- TURN ON:**
- Press the speed control (Low , Medium , High) switch to select the desired speed. Once the power switch is turned on, the prior switch selections will be cancelled.
 - Press Light Switch to turn on the lights.
- TURN OFF:**
- Press the Power Switch to turn off the power.
 - Press Light Switch to turn off the lights.

I. WIRING DIAGRAM

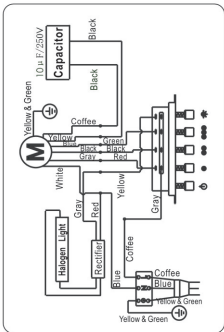

J. TROUBLE SHOOTINGS

1. If the chimney hood does not operate after installation :

- Check if the chimney hood has been plugged in, make sure that all electrical wiring are properly connected.

2. The light does not work :

- Swap out light assembly to working ones to determine whether it is caused by defective halogen bulbs. (See Replacing the halogen light.) (Fig.18)

3. The island hood vibrates when the blower is on :

- The chimney hood might not have been secured properly on to the ceiling.

4. The blowers seems weak :

- Check that the duct size used is at least 6" or 3-1/4" x 10. Chimney hood WILL NOT function efficiently with insufficient duct size. For example: 7" duct over 6" hole and loosely secured.
- Check if duct is clogged or if damper unit is not opening properly. A tight mesh on a side wall cap unit might also cause restriction to the air flow.

5. The lights work but the blower is not spinning at all, is stuck or is rattling :

- The blower might be jammed or scraping the bottom due to shipping damage.

6. The hood is not venting out properly :

- Make sure the distance between the cook top and the bottom of the hood is within 28" and 36" in range.
- Reduce the number of elbows and length of duct work. Check if all joints are properly connected, sealed, and taped.
- Make sure the power is on high speed for heavy cooking.

K. SPECIFICATIONS :

Model : H

Body	Stainless Steel / Tempered Glass
Power Rating	120W / 60Hz (USA & Canada standard)
Control Input Power	180 W (150W + 2x20W)
Motor Input Power	150W
Motor Revolution	800 R.P.M. (±10%) to 1400 R.P.M. (±10%)
Levels Of Speed Control	3 Levels
Air Pressure	560 Pa
Noise Level (dB / some)	Approximately 55 / 2.8 to 59 / 3.8 (Lowest to highest Speed)
Motor Type	Single motor
Fan Type	Stress
Control Type	Push Button
Illumination	20W - 2 Halogen
Venting Size	6" Inch Round

* specifications are subject to change without any prior notice.

L. DISASSEMBLY DIAGRAM

Halogen Light Model H
Assembly Diagram

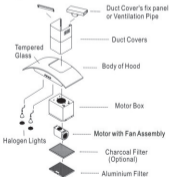

M. MAINTENANCE :

- 1. Cleaning Exterior :**
- Clean periodically with hot soapy water and clean cotton cloth. Do not use corrosive or abrasive detergent , or steel wool / scouring pads, which will scratch and damage the stainless steel surface.
 - After cleaning, you may use non abrasive stainless steel polish / cleaner, to polish and buff out the stainless luster and grain. Always scrub lightly, with clean cotton cloth, and with the grain.
- 2. Cleaning Aluminum Grease Filter Stainless Steel Filterless Grill :**
- The metal filters fitted by the intended to filter out residue and grease from cooking. It need not be replaced on a regular basis but are required to be kept clean.
 - Filters should be cleaned after every 30 hours of use.
 - Remove and clean by hand or dishwasher. Spray degreasing detergent and leave to soak if heavily soiled. Dry filters and re-install before using hood.
- 3. Replacing Filter :**
- Should filters wear out due to age and prolonged use, replace with following :
Description : Aluminum Grease Filter / Stainless Steel Filterless Grill.
 - Note : Also replace damaged filter that has punctured or broken frame.
- 4. Replacing the light bulb :**
- Should the light bulb burned out due to age and prolonged use, replace with following :
Description : 20W 12V halogen bulb.
 - Turn off the chimney hood.
 - Make sure the lights are cool to touch, turn the inner ring counter-clock wise with a small flat head screw driver then pop-out the protective covering.
 - Gently pull out the defective bulb and discard accordingly.
 - Install a new halogen light bulb and reverse the steps.

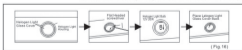

ONE-YEAR LIMITED WARRANTY

Every **WINDSTER** RANGE HOOD is thoroughly inspected and tested before leaving the factory. It will also be tested by our agents (USA or CANADA). And displayed in front of customers to prove merchantability or fitness at the time of purchase.

Every mail-order merchandise will also be inspected, tested, and carefully packed by our agents before mailing to customers.

During ONE-YEAR warranty period from the date of original purchase, defective parts could be carried or mailed to your agent to exchange for new parts free of charge, however, your agents will extend this same warranty service for..... year(s).

Should there be any questions regarding this product, please, contact the service dedicated line :

Contact us :

9848 Rush Street Suite A,B,C.

South El Monte, CA 91733

Tel : 626-350-1015

Fax : 626-350-1254

Website : www.windsterhood.com

Model: _____ Size: _____ Type: _____

Date of purchase: _____

Authorized agents seal: _____

Customer's Name: _____

Address: _____

Tel: _____

This warranty is invalid without an authorized agent's seal. If the range hood has already been installed or used, return will not be accepted.