

FEATURED MODEL

441186 HYDRA
w/ PULLOUT SPRAY in SATIN NICKEL

ADDITIONAL MODELS

441185 HYDRA
w/ PULLOUT SPRAY in CHROME

FEATURES

- **1.5 GPM faucet flow rate conserves up to 30% water**
- AB1953 compliant
- Fresh design hand spray features water conservation with a modern look
- Extra long supply lines
- Solid brass body & pullout spray
- Ceramic disc cartridges
- Installation in a 1-3/8" hole

CODE/STANDARDS COMPLIANCE

ASME A112.18.1-2005
NSF 61 certified
NSF 61 ANEX G low lead requirements

AB1953 Lead Free

WARRANTY

BLANCO kitchen faucets in Chrome and Stain Nickel a LIMITED LIFETIME WARRANTY to be free of all manufacturing defects under normal use. A 5-YEAR LIMITED WARRANTY on all SILGRANIT color matching faucets. See our complete warranty for details.

While BLANCO endeavors to provide accurate information, all dimensions are nominal, cannot be gaurenteed, and are subject to change or cancellation. BLANCO assumes no responsibility for use of superseded or voided specifications.

JOB INFORMATION

Job Name: _____

Contact: _____

Date Specified: _____

Specifier: _____

Contractor: _____



Model 441186 shown

NOMINAL DIMENSIONS

REACH	SPOUT HEIGHT	FAUCET HEIGHT
10-1/4"	12"	14-3/8"

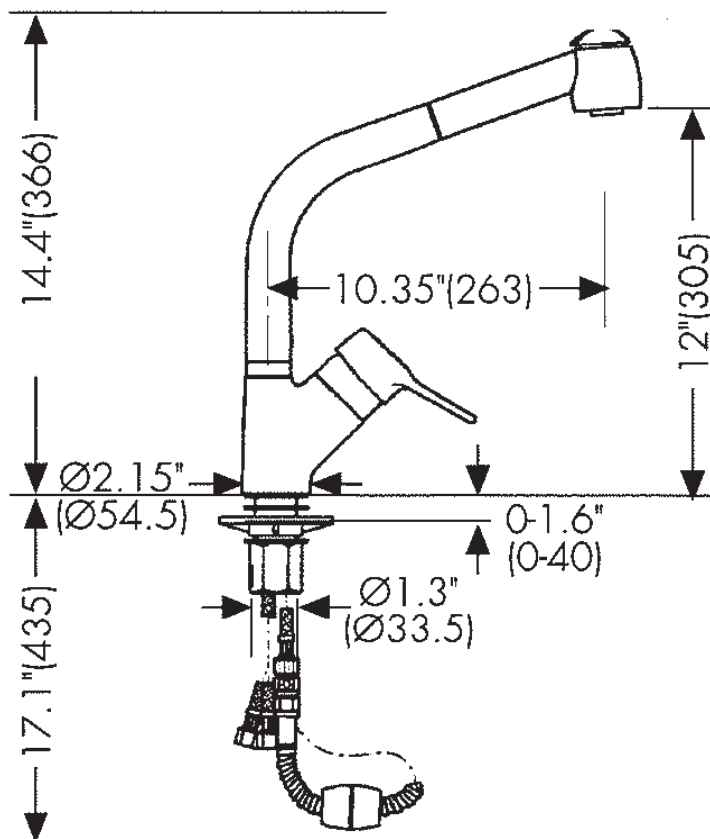

BLANCO AMERICA
800.451.5782
www.blancoamerica.com

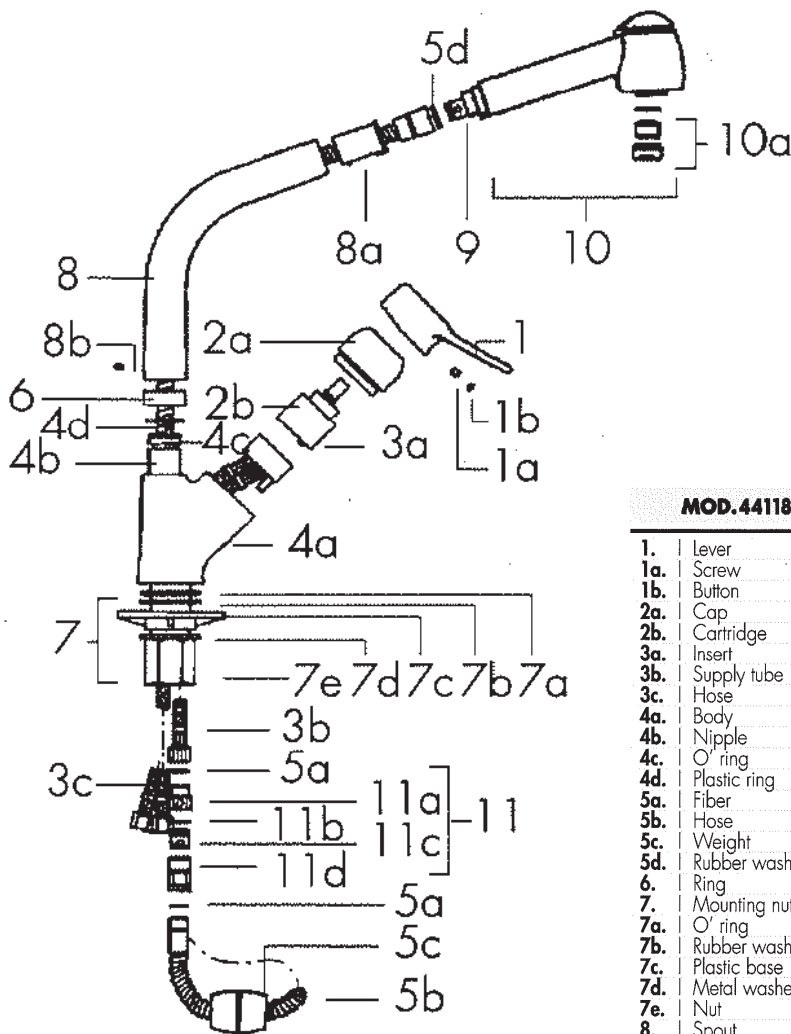

MOD.441185/441186 PART LIST

1.	Lever	2458
1a.	Screw	2058
1b.	Button	1270
2a.	Cap	2326
2b.	Cartridge	2809
3a.	Insert	2463/A
3b.	Supply tube	2360
3c.	Hose	2350
4a.	Body	2869
4b.	Nipple	2469
4c.	O' ring	2.62x21.89
4d.	Plastic ring	2418
5a.	Fiber	13.7x10x1.5
5b.	Hose	2266
5c.	Weight	2582
5d.	Rubber washer	20x12x2.5
6.	Ring	2405
7.	Mounting nut assy	1-2359
7a.	O' ring	3.53x42.86
7b.	Rubber washer	48x34x2
7c.	Plastic base	3109
7d.	Metal washer	2258
7e.	Nut	2359
8.	Spout	2825
8a.	Plastic insert	2866
9.	Flow regulator w/ check valve	2518
10.	Pull-out spray	1666
10a.	Aerator set	1-680
11.	Check valve assy	1-3115
11a.	Nipple	3116
11b.	Fiber	16.5x12x1.5
11c.	Check valve	2419
11d.	Check valve body	3115