

ELKAY®

**How to Install
Single-Lever
Kitchen Faucets**

**MODELS
LKE4100
LKE4100F
LKE4101
LKE4102
LKE4103
LKE4160
LKE4161**

SAVE FOR CONSUMER

ELKAY • 2222 CAMDEN COURT • OAK BROOK, IL 60523

TO INSTALL FAUCET

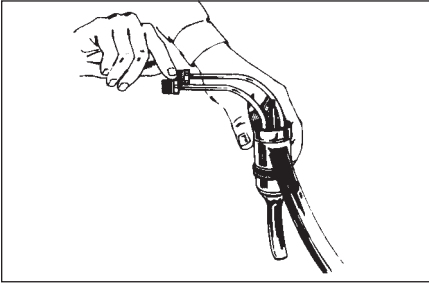

Apply caulking to underside of base. Install faucet in center hole and fasten with mounting hardware. Tighten nut securely with screw driver nut driver. **CAUTION: DO NOT STRAIGHTEN INLET TUBES BEFORE MOUNTING FAUCET.**

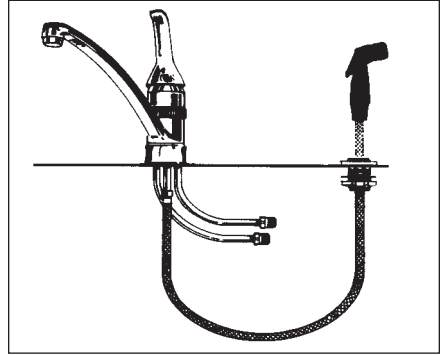

Install spray nest. Connect spray hose to nipple between inlet tubes. Straighten supply tubes and connect to water supply lines.

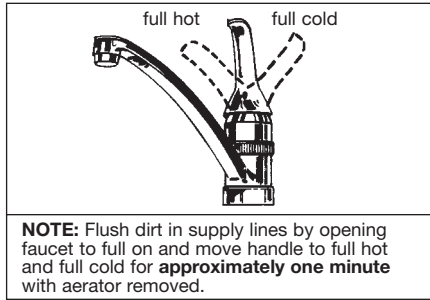

NOTE: Flush dirt in supply lines by opening faucet to full on and move handle to full hot and full cold for **approximately one minute** with aerator removed.

Repair and Maintenance Instructions

SERVICING CONDITIONS FOR ...

1. Low water volume through spout or spray hose.

SOLUTION

- Remove and clean aerator.
- Remove and clean diverter. Flush out. Follow steps 1, 2, 7, 10, 11, 12, 13, 14.
- If condition continues, remove cartridge and flush lines. Follow steps 1, 2, 3, 4, 5, 6, 13, 14.

2. Excessive amount of water from spout when using spray hose.

SOLUTION

- Remove and clean or replace diverter. Follow steps 1, 2, 7, 10, 11, 12, 13, 14.

3. Water dripping out spout end.

SOLUTION

- Replace cartridge. Follow steps 1, 2, 3, 4, 5, 6, 13, 14.

4. Water dripping out spout hub.

SOLUTION

- Remove and replace "O" rings inside hub. Follow steps 1, 2, 7, 8, 9, 12, 13, 14.

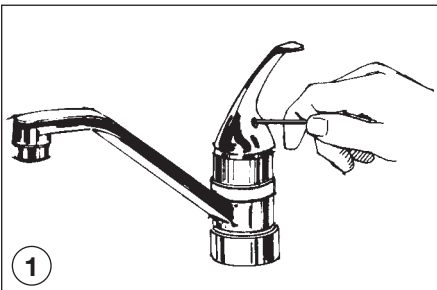

1 Loosen set screw and lift off handle.

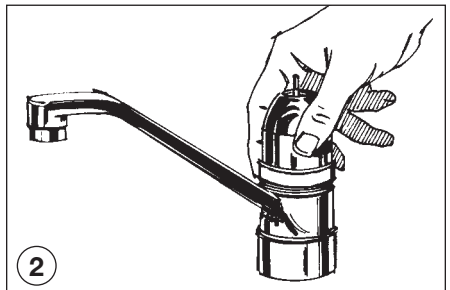

2 Unscrew dome assembly and lift off.

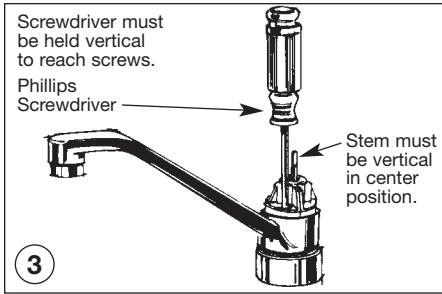

Remove cartridge. Remove old diaphragm from lower housing (if not attached to cartridge).

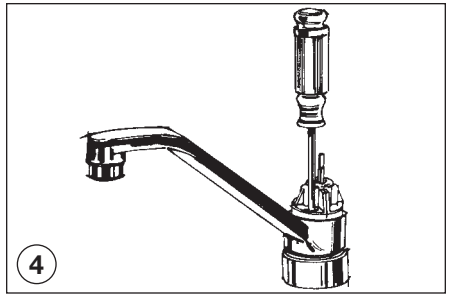

Before replacing cartridge, follow instructions for drawings 5 and 6.

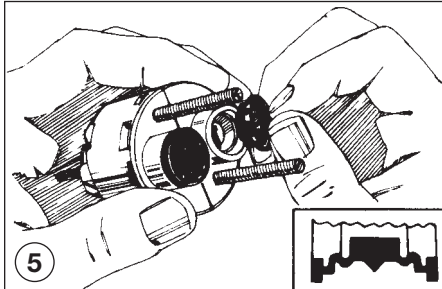

NOTE: Rubber diaphragm must be seated in cartridge bottom when reinserted into lower housing.

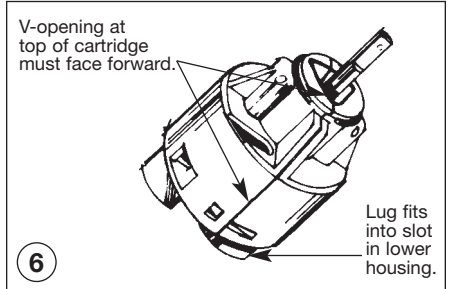

Note position of cartridge (above) when inserting cartridge in lower housing.

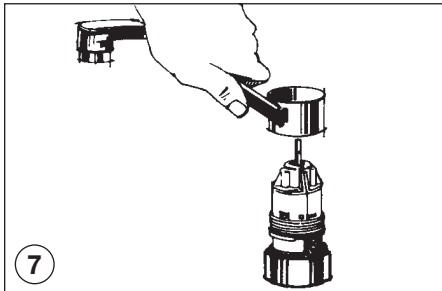

If water leaks around spout hub, or diverter requires service, remove spout as shown.

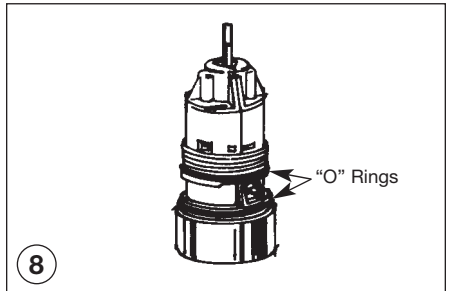

Remove "O" rings.

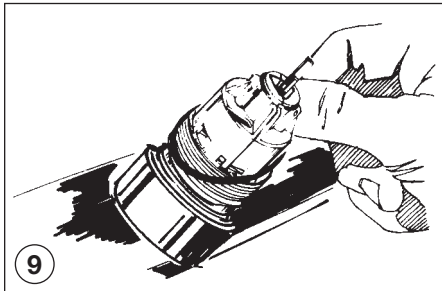

Replace "O" rings in grooves in lower housing. Grease "O" rings with silicon grease provided.

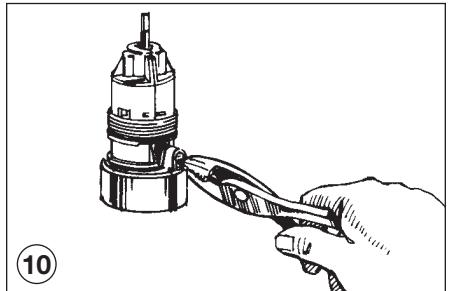

To remove diverter assembly, pull straight out with pliers.

Repair and Maintenance Instructions (Continued)

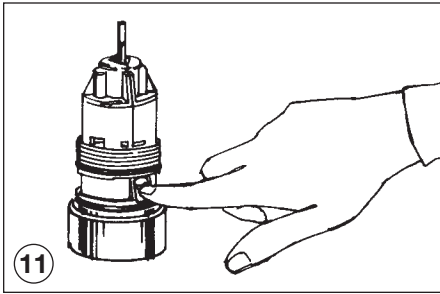

Place diverter assembly into cavity inside of body as far as possible.

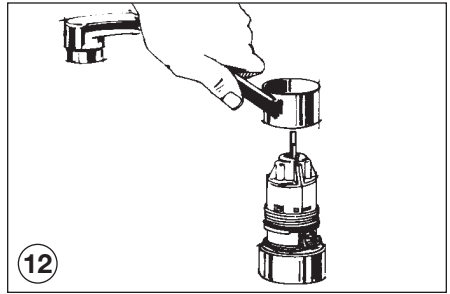

To replace spout, gently rotate spout while pressing down into position.

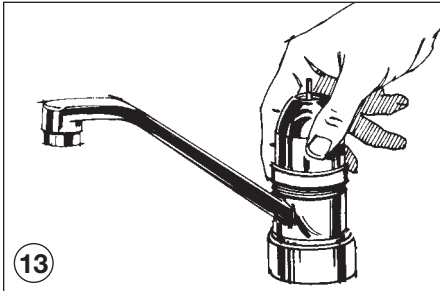

Replace dome, finger tighten.

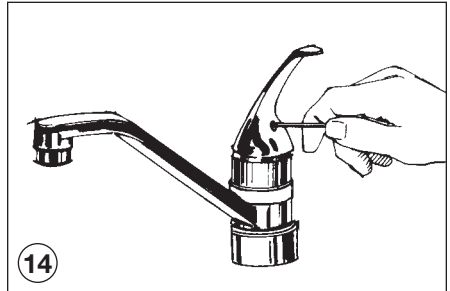

Replace handle. Tighten set screw. Turn water supply on.

ELKAY LIMITED LIFETIME FAUCET WARRANTY ON RESIDENTIAL FAUCETS

Limited Lifetime Functional and Finish Warranty

Elkay warrants to the original consumer purchaser that the Elkay faucet purchased will be free from defects in material and workmanship for as long as the original consumer purchaser owns the faucet. Elkay will, at its option, supply replacement parts (or if no longer available a comparable product) if the faucet fails due to a defect in material or workmanship. This warranty does not apply in the event of product surface damage caused by abuse, misuse or improper care and maintenance. This warranty excludes damage caused by harsh or abrasive cleaners and/or materials. This warranty excludes all industrial, commercial and business use, whose purchasers are hereby extended a limited lifetime on mechanical parts and 5 years on finish. Product replacement does not include transportation cost or labor installation cost. Elkay reserves the right to examine product in question and its installation prior to replacement.

OTHER WARRANTY CONDITIONS ON FAUCETS

Our warranty does not cover product failure or damage caused by abusive treatment, misuse, environmental factors, improper care and cleaning, or damage due to handling or faulty installations. This warranty is extended only to the original consumer purchaser of the product. This warranty does not cover shipping costs, labor costs, or any other charges for such items as installation or replacement of the sink, diagnosis or replacement of any faucet or component part, or any other expense or loss.

All incidental or consequential damages are specifically excluded. No additional warranties, express or implied are given. Any implied warranty, including one of merchantability or fitness for a particular purpose, is limited to the duration of this written warranty.

Some states do not allow the exclusion or limitation of incidental or consequential damages or limitations on how long an implied warranty lasts, so the above limitations or exclusions may not apply to you.

This warranty gives you specific legal rights, and you may also have other rights which vary from state to state.

TO OBTAIN SERVICE UNDER WARRANTY

- Write to: Elkay
Attention: Consumer Services
2222 Camden Court
Oak Brook, IL 60523
- Include a letter containing the following information:
 - Date of purchase and installation
 - Description of nature of defect
 - Model number or description of model and/or component part if possible.

Elkay

www.elkayusa.com

2222 Camden Court
Oak Brook, IL 60523

Printed in U.S.A.
©2004 Elkay

Rev. B (3/04) A-52398