

Features

- 18-gauge stainless steel
- Under-mount
- Single bowl
- Rounded bowl(s)
- Includes installation hardware
- 9-1/4" (235 mm) x 15-3/8" (391 mm)

Codes/Standards Applicable

Specified model meets or exceeds the following:

- ASME A112.19.3/CSA B45.4

UNDER-MOUNT SINK K-3338

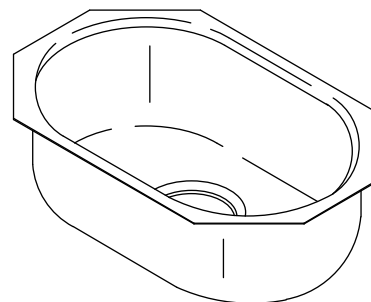

Colors/Finishes

- NA: None applicable

Accessories

- CP: Polished Chrome
- 0: White
- NA: None applicable
- Other: Refer to Price Book for additional colors/finishes

Specified Model

Model	Description	Colors/Finishes	
K-3338	Under-mount sink	<input type="checkbox"/> NA	
Optional Accessories			
K-2989	Countertop cutting board	<input type="checkbox"/> NA	
K-3292	Hardwood cutting board and colander set	<input type="checkbox"/> 0 White	<input type="checkbox"/> Other_____
K-8801	Duostrainer [®] sink strainer	<input type="checkbox"/> CP	<input type="checkbox"/> Other_____

Product Specification

The under-mount sink shall be 9-1/4" (235 mm) in length and 15-3/8" (391 mm) in width. Sink shall be made of 18-gauge stainless steel. Sink shall be a single rounded bowl. Sink shall include installation hardware. Sink shall be Kohler Model K-3338-NA.

UNDERTONE™

Technical Information

Fixture*:	
Bowl area	9-1/4" (235 mm) x 15-3/8" (391 mm)
Water depth	5-1/2" (140 mm)
Drain hole	Ø 3-5/8" (92 mm)
*Approximate measurements for comparison only.	
Included components:	
Hardware kit	91915
Cut-out template	113199-7

Installation Notes

Install this product according to the installation guide.

Allow a minimum of 2" (51 mm) clearance around the sink rim for clip attachment.

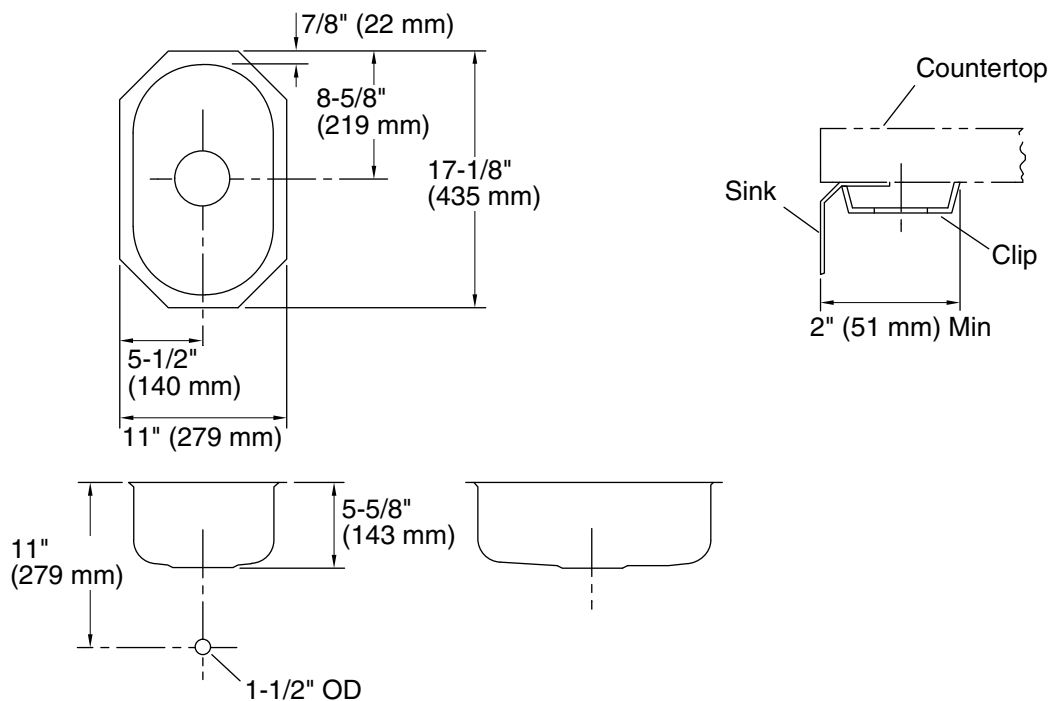

Product Diagram