

EL1499S

4" Low Voltage Shallow Housing
Complete with 12 volt thermally protected
magnetic transformer.

PROJECT INFORMATION:

Project Name: _____

Fixture Type: _____

Date: _____

DIMENSIONS

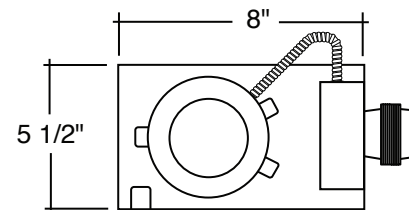
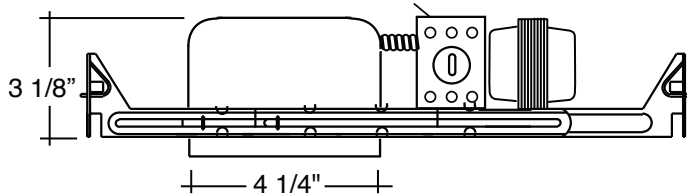

PRODUCT SPECIFICATIONS

Housing Features:

Integral thermal protector guards against improper lamping. Single wall construction. 3 5/8" deep aluminum housing.

Lamp:

12V, 50W Maximum; MR16.

Lamp Holder:

MR16 Socket.

Trim Ring:

Polycarbonate trim ring, metal trim ring, designed to conceal ceiling cutout.

Transformer:

120V / 12V / 50VA Magnetic Transformer

INSTALLATION

Junction Box:

Pre-wired junction box provided with 1/2" knockout. Junction box provided with removable access plates. U.L./C.U.L. Listed for maximum (6) No. 12AWG branch circuit conductors.

Mounting:

Hangar bars span 24" joists. Housing accommodates various ceiling thickness.

Mounting Frame:

Stamped galvanized steel material for corrosion resistance.

Labels:

- U.L. Listed for damp locations
- U.L. Listed for feed through wiring

CATALOG NUMBER

Example:

EL1499S-EL1421C

See trims page for variety of trims available.