

2501-13L NWB

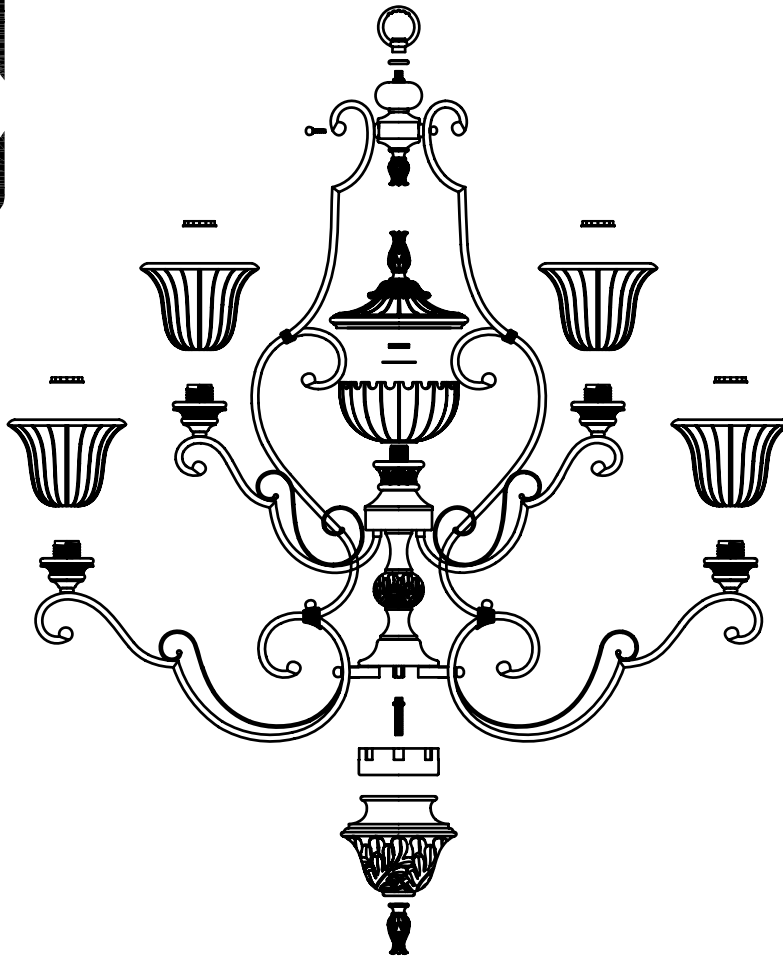

2501-20L NWB

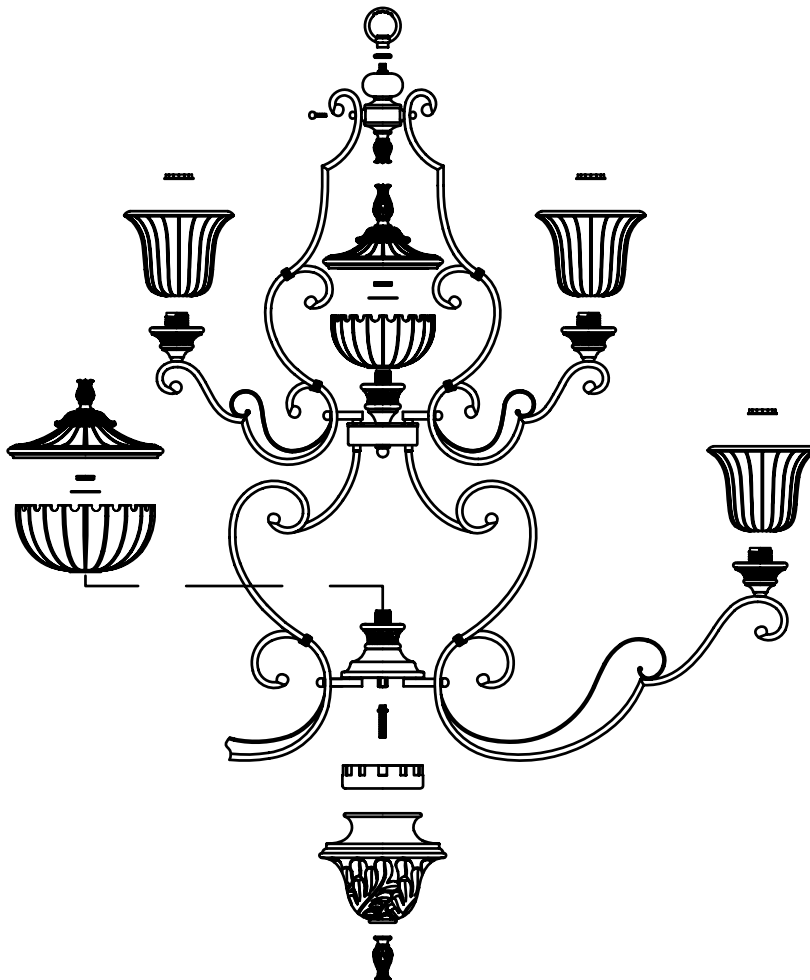

INSTALLATION INSTRUCTION CH-2

For Multi tier Light fixtures

WARNING! SHUT POWER OFF AT FUSE OR CIRCUIT BREAKER

IMPORTANT: FOR A SAFE AND SECURE INSTALLATION, THESE FIXTURES MUST BE INSTALLED BY MEANS OF SUPPORTS THAT ARE INDEPENDENT OF THE OUTLET BOX.

SUGGESTED INSTALLATION (Fig.1)

1. Provide a 1/4 IPS pipe with one end securely mounted to a beam or a structural member. The other end should protrude through the center of the outlet box as shown.
2. Assemble the ceiling loop, nipple, nuts & hickey to center 1/4 IPS support pipe and adjust overall length to allow the lock collar to hold the canopy flush to the ceiling.
3. Attach the chain to the fixture loop by opening the end link.
4. Slip the lock collar (finish side down) & canopy over the upper end of the chain. Open the upper end link of chain, now lift the fixture and hang it on the Ceiling loop tighten both end links.
5. Lace the fixture wires, ground & safety cable through the chain & loop, exiting through the side of the hickey. Place the safety cable through the lock, now wrap it twice around the hickey & run the end back through the lock, tighten the set screw on the side of the lock. Run cable through the top of the outlet box and secure to structural member.
6. Install the light bulbs & glass. (See glass installation instruction enclosed.)

CONNECTING THE WIRES (Fig.2)

7. Place the white, ribbed, or tinned wire from the fixture evenly against the white wire from the Outlet Box.
8. Fit the connector over the ends of the two wires and screw the connector clockwise until you feel a firmness.
9. Try gently to pull the connector off the wires. If you can pull the connector off, carefully redo steps 6 and 7 above, and check again for a firm connection.
10. Connect the black, smooth, or untinned wire from the fixture to the black wire from the Outlet Box in the same manner.
11. If your Outlet Box is provided with a ground wire (green or bare copper only), attach this wire and the bare copper wire from the fixture to the ground screw by wrapping both wires under the head of the screw and tightening screw. If Outlet Box is not provided with ground wire, attach

only the bare copper wire from the fixture to the ground screw.

WARNING: DO NOT ATTACH ANY OTHER WIRES BESIDES THE GREEN OR BARE COPPER WIRE TO THE GROUND SCREW.

12. After the wires are connected, tuck them carefully inside the outlet box. Then raise the Canopy up against the ceiling & screw the Lock Collar onto the Ceiling Loop.

NOTE: DO NOT EXCEED THE SPECIFIED WATTAGE.

Your installation is now complete. Turn power on at to the junction box & test the fixture.

