

Family: Midtown | Item No. 4971 BN

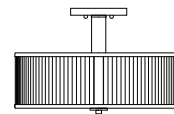

▼ start here

Drawing 1 - Fixture Assembly

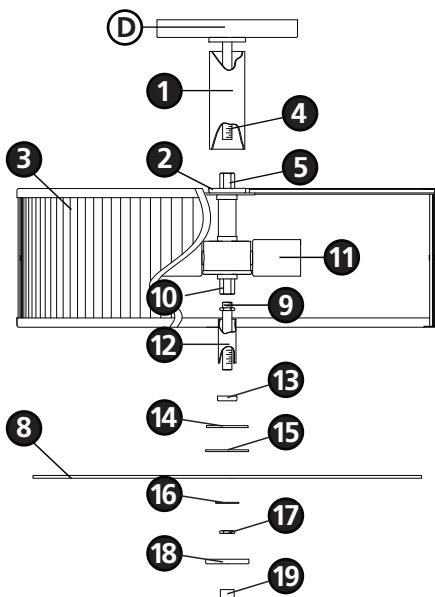

1

1. Find a clear area in which you can work.
2. Unpack fixture and glass from carton.
3. Carefully review instructions prior to assembly.

***** The construction of this fixture will be accomplished by first assembling the main body of the fixture, making all necessary electrical connections, hanging the fixture from the ceiling, and then installing the glass.**

2

1. To assemble fixture, slip tubing (1) over wires and place into cap (2) on top of cage assembly (3) - see **Drawing 1**.
2. Slip wires through center stem (4) that is attached to the canopy (D) and thread end of stem (4) into coupler (5) located on top of cage assembly (3) and tighten.

3

1. Prepare mounting strap (B) for mounting by installing screws (A) into mounting plate (B) - see **Drawing 2**.
 - Be sure the holes into which the screws are threaded match the spacing of holes (C) in the canopy (D) - see **Drawings 2 and 3**.
2. Attach mounting plate (B) to junction box (J), using screws (F) provided and slip supply wires through large center hole.

SAFETY WARNING: READ WIRING AND GROUNDING INSTRUCTIONS (I.S. 18) AND ANY ADDITIONAL DIRECTIONS. TURN POWER SUPPLY OFF DURING INSTALLATION. IF NEW WIRING IS REQUIRED, CONSULT A QUALIFIED ELECTRICIAN OR LOCAL AUTHORITIES FOR CODE REQUIREMENTS.

Make electrical connections from supply wire to fixture lead wires. Refer to instruction sheet (I.S. 18) and follow all instructions to make all necessary wiring connections. Then refer back to this sheet to continue installation of this fixture.

Drawing 2 - Strap Detail

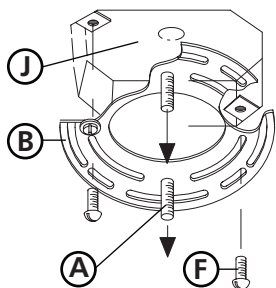

4

1. Hang the fixture by slipping canopy (D) over screws (A) and hold in position - see **Drawings 2 and 3**.
2. Thread ball knobs (E) onto end of screws (A) and tighten to secure fixture to ceiling.

Drawing 3 - Fixture Mounting

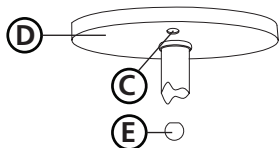

5

1. Fixture can now be lamped accordingly.
2. Thread center stem with hex nut (9) into coupler (10) at base of socket assembly (11) approximately 3/8" and tighten hex nut to secure center stem - see **Drawing 1**.
3. Slip tubing (12) over center stem and hold in position.
4. Slip cap (13) over center stem followed by metal flat washer (14) and rubber washer (15) and hold in position.
5. Slip glass (8) onto center stem and hold in position.
6. Slip flat washer (16) onto center stem and hold both glass and washer in position while threading on hex nut (17). Tighten hex nut (17) to secure glass to fixture.
7. Slip cap (18) onto center stem and hold in position.
8. Thread on bottom knob (19) and tighten to complete assembly.

Note: Maximum wattage for 4971 fixture is 100 watts per bulb.

4.28.10