

## DJ Screw On

700DJSOC

1.9



## GENERAL PRODUCT INFORMATION:



This product is suitable for indoor dry locations only.

The anchors provided with this product are for drywall. Use proper anchors for mounting onto other type of surfaces.

This product is suitable for dry locations only.



## Mount the Bracket onto a Display Board

1A

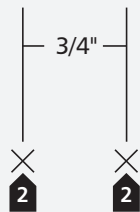

- 1 Select the location on the display board where the Display Jack Screw-On will be mounted.
- 2 Mark two points 3/4" apart on the display board for the two anchors.

1B

SCREW THE ANCHOR IN

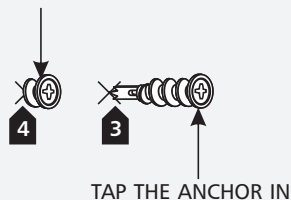

- 3 With a hammer tap the anchors at the mark points up to the threaded portion.
- 4 Screw anchors in the rest of the way with a Phillips screwdriver.

1C

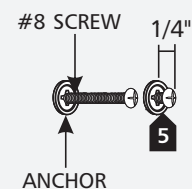

- 5 Screw the #8 screws into the anchors. Leave the screws 1/4" exposed.

**NOTE:** If the mounting surface is wood, discard the anchors and mount the #8 screws directly into the wood.

1D

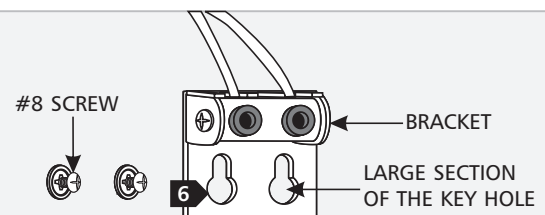

- 6 Hook the bracket onto the #8 screws through the large section of the key holes.

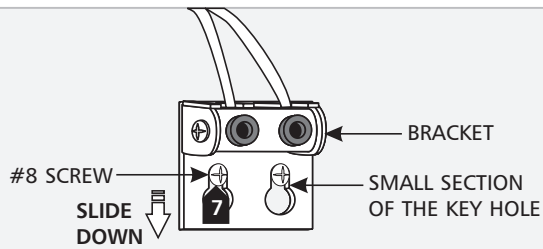
**1E**

- 7** Slide the bracket down so that the small section of the key holes cover the #8 screws. Tighten the #8 screws.

## Assemble the Cord Switch

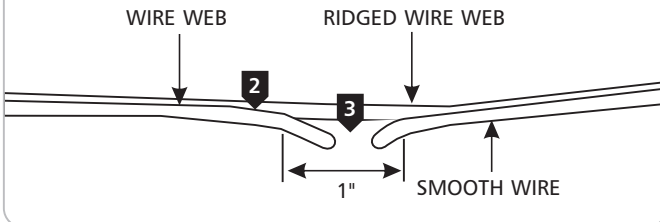
**2A**

- 1** Select a place on cord where the switch is going to be mounted.
- 2** With a sharp knife cut 1" slot in the cord web. Make sure not to nick the insulation of either wire.
- 3** Cut the smooth wire in half.

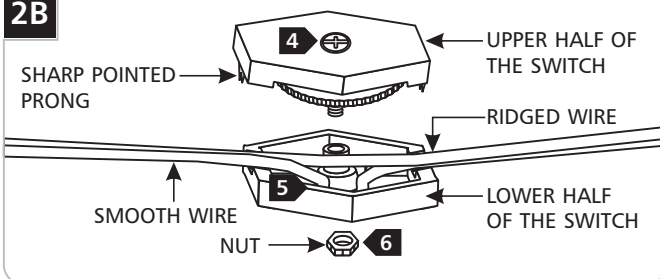
**2B**

- 4** Loosen the screw on upper half of the switch to remove the nut on the lower half.
- 5** Place the cord in the lower half of the switch (the half without the wheel).
- 6** Press both halves back together. Replace the nut in the lower half and tighten the screw on upper half so that the sharp pointed prongs pierce the smooth wire insulation and make contact inside.

## Connect The Fixture To The Port

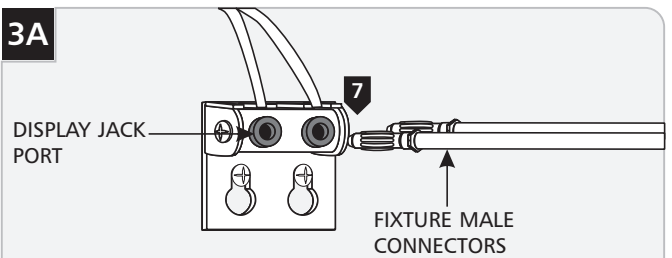
**3A**

- 7** Push the two fixture male connectors all the way into the Display Jack ports.

**SAVE THESE INSTRUCTIONS!**



**TECH LIGHTING®**

7400 Linder Ave, Skokie, IL 60077

847.410.4400

[www.techlighting.com](http://www.techlighting.com)

© 2008 Tech Lighting, L.L.C. All rights reserved. The "Tech Lighting" graphic is a registered trademark of Tech Lighting, L.L.C. Tech Lighting reserves the right to change specifications for product improvements without notification.

A Generation Brands Company