

1224DWRSOD • 24" Outdoor Refrigerator Drawers • Outdoor Series

FEATURES & BENEFITS



STAINLESS  
SOLID

|                   |  |
|-------------------|--|
| PERFORMANCE       | <ul style="list-style-type: none"><li>• Volume of 5.4 cu ft holds up to 98 bottles (12 oz) or 150 cans (12 oz)</li><li>• Digital Touch Pad Control</li><li>• Temperature range: 34°F - 45°F</li><li>• Passive cooling system</li></ul>   |
| INTERIOR/EXTERIOR | <ul style="list-style-type: none"><li>• Black interior is illuminated with LED lighting</li><li>• Equipped with 2 full-extension robust stainless drawers</li><li>• Standard professional stainless steel handle is interchangeable with commercial handle accessory</li><li>• The lower drawer is large enough to fit 2 one-gallon containers with additional space for more storage</li><li>• Full stainless steel cabinet and drawers are deemed suitable for outdoor use by UL</li></ul> |
| INTEGRATION       | <ul style="list-style-type: none"><li>• Unit is designed to be built-in or can be freestanding with the freestanding accessory kit</li><li>• Four independently adjustable leveling legs provide a precise undercounter fit</li></ul>  |

MODEL DETAILS

| Model            | Voltage/Hz | Door Swing | Finish          | Shipping Weight |
|------------------|------------|------------|-----------------|-----------------|
| U-1224DWRSOD-00A | 115 / 60   | Drawers    | Stainless Solid | 142 lb          |

ACCESSORIES

| Model       | Description                                  | Finish    | Shipping Weight |
|-------------|--|-----------|-----------------|
| 80-54289-00 | Commercial Drawer Handle, 7/8" Diameter      | Stainless | 2 lb            |
| U-FSK-B     | Freestanding Kit                             | Stainless | 3 lb            |
| 80-54362-00 | Top Drawer Slide and Divide Bin Organizer 1k | N/A       | 3 lb            |

## Outdoor Series • 24" Outdoor Refrigerator Drawers • 1224DWRSOD

### DIMENSIONS

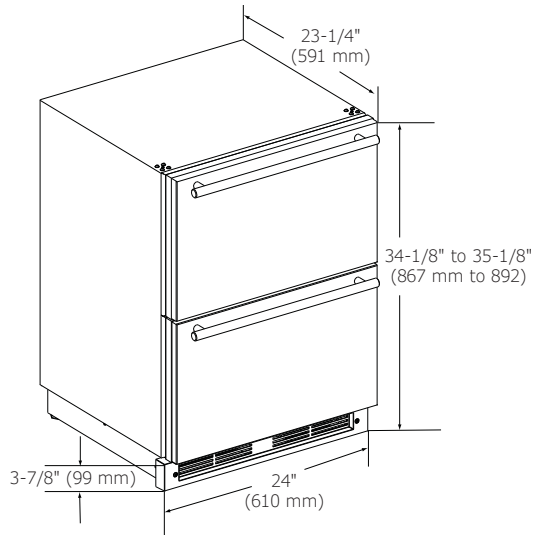

### CABINET CUT-OUT

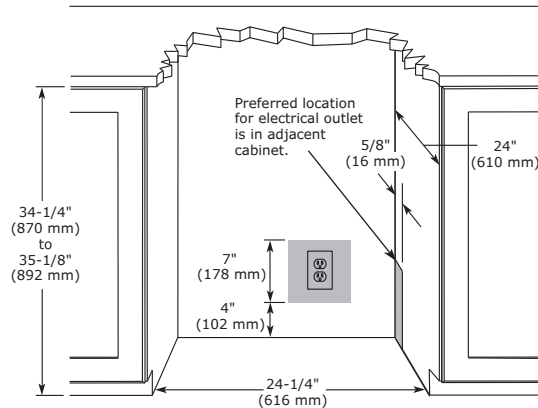

### INSTALLATION NOTES

Cutout includes the additional 1/4" width overall to ensure proper installation.

No additional clearance around sides, top or rear of unit is needed for ventilation.

### SPECIFICATIONS

|                                   |                   |
|-----------------------------------|-------------------|
| Model                             | 1224DWRSOD        |
| Amps: Running                     | 1.2               |
| Capacity: Bottle (12 oz)          | 98                |
| Capacity: Can (12 oz)             | 150               |
| Capacity: Volume (cu ft)          | 5.4               |
| Control Type                      | Digital Touch Pad |
| Dimensions: Product Depth         | 23 1/4" / 591 mm  |
| Dimensions: Product Height        | 34 1/8" / 867 mm  |
| Dimensions: Product Width         | 24" / 610 mm      |
| Energy Consumption: Avg. Per Year | 305 kWh           |
| ENERGY STAR                       | No                |
| Panel Width                       | 23 3/4" / 603 mm  |
| Product Weight: Max               | 132 lb            |
| Refrigerant Type                  | R600a             |
| Sabbath (Star K Certified)        | Yes               |
| Temperature Range                 | 34°F - 45°F       |

### COOLING SYSTEM



### ELECTRICAL REQUIREMENTS

This unit requires a grounded, polarized 115 VAC, 60 Hz, 15 A power supply (normal household current).



Warranty

Please visit [u-line.com](http://u-line.com) to view this model's User Guide & Service Manual. All Specifications are subject to change without notice.

Deemed suitable for outdoor use by UL.