

**1224DWR • 24" Solid Refrigerator Drawers • 1000 Series**
**FEATURES & BENEFITS**

**STAINLESS  
SOLID**

**INTEGRATED  
SOLID**
**PERFORMANCE**

- Volume of 5.4 cu ft holds up to 98 bottles (12 oz) or 150 cans (12 oz)
- Digital Touch Pad Control
- Temperature range: 34°F - 45°F
- Passive cooling system

**INTERIOR/EXTERIOR**

- Black interior is illuminated with LED lighting
- Equipped with 2 full-extension robust stainless drawers
- Standard commercial stainless steel handle is interchangeable with professional handle accessory
- The lower drawer is large enough to fit 2 one-gallon containers with additional space for more storage

**INTEGRATION**

- Unit is designed to be built-in or can be freestanding with the freestanding accessory kit
- Integrated model requires ¾" custom door panel (panels not supplied by U-Line)
- Four independently adjustable leveling legs provide a precise undercounter fit
- Available in the following finishes: Stainless or Integrated

**MODEL DETAILS**

Model	Voltage/Hz	Door Swing	Finish	Shipping Weight
U-1224DWRS-00B	115 / 60	Drawers	Stainless Solid	142 lb
U-1224DWRINT-00B	115 / 60	Drawers	Integrated Solid	134 lb

**ACCESSORIES**

Model	Description	Finish	Shipping Weight
23050-02	Commercial Drawer Handle, 7/8" Diameter	Stainless	2 lb
U-FSK-B	Freestanding Kit	Black	3 lb
26013	1k Top Drawer Slide and Divide Bin Organizer	N/A	3 lb

**1000 Series • 24" Solid Refrigerator Drawers • 1224DWR**
**DIMENSIONS**

Dimensions shown apply to all finishes, including Integrated (INT) models with  $\frac{3}{4}$ " integrated panel/frame installed.

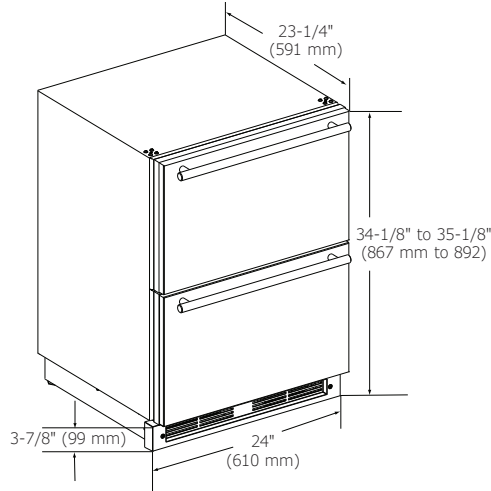
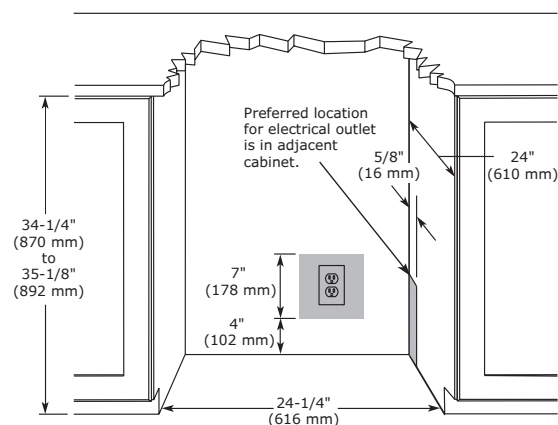
**CABINET CUT-OUT**

**INSTALLATION NOTES**

Cutout includes the additional  $\frac{1}{4}$ " width overall to ensure proper installation.

No additional clearance around sides, top or rear of unit is needed for ventilation.

**SPECIFICATIONS**

Model	1224DWR
Amps: Running	1.2
Capacity: Bottle (12 oz)	98
Capacity: Can (12 oz)	150
Capacity: Volume (cu ft)	5.4
Control Type	Digital Touch Pad
Dimensions: Product Depth	23 $\frac{1}{4}$ " / 591 mm
Dimensions: Product Height	34 $\frac{1}{8}$ " / 867 mm
Dimensions: Product Width	24" / 610 mm
Energy Consumption: Avg. Per Year	305 kWh
ENERGY STAR	No
Panel Height	15" / 381 mm
Panel Thickness	$\frac{3}{4}$ " / 20 mm
Panel Type	Solid Panel
Panel Width	23 $\frac{3}{4}$ " / 603 mm
Product Weight: Max	132 lb
Refrigerant Type	R600a
Sabbath (Star K Certified)	Yes
Temperature Range	34°F - 45°F

**COOLING SYSTEM**

**ELECTRICAL REQUIREMENTS**

This unit requires a grounded, polarized 115 VAC, 60 Hz, 15 A power supply (normal household current).



Residential &  
Commercial



Please visit [U-Line.com](http://U-Line.com) to view this model's User Guide.  
All specifications are subject to change without notice.