



**1****CAUTION**

Turn off hot and cold water supplies before beginning.

**SPOUT OR BASE ASSEMBLY**

- Insert BASE or SPOUT shank through center hole of SINK, making sure RUBBER GASKET is properly positioned.
- Assemble RUBBER WASHER, RETAINER, and LOCKNUT onto threads of SPOUT from underside of SINK.
- Insert LIFT ROD through SPOUT (or BASE) and slot of RETAINER.
- Align SPOUT and tighten LOCKNUT. Be sure slot in BRASS WASHER is positioned to the rear as shown.

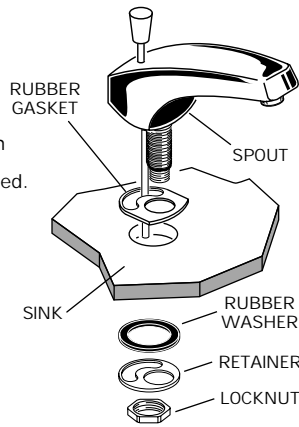
**2****VALVE INSTALLATION**

- Place RUBBER RING into ESCUTCHEON and screw ESCUTCHEON onto VALVE BODY until snug against internal stop.
- Tighten LOCKNUT to secure VALVE position. Attach COUPLING to TEE and tighten.
- Slide RUBBER FERRULE, FRICTION RING, and COUPLING NUT to outlet of VALVE and tighten COUPLING NUT firmly. Repeat on other VALVE.
- Connect HOT water supply to inlet of left VALVE and COLD water supply to inlet of right VALVE using appropriate connector.

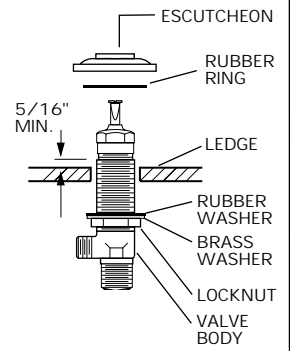
**VALVE INSTALLATION (continued)**

- Prepare TUBE and TEE ASSEMBLY to fit available VALVE location. If necessary, cut and/or bend TUBING carefully. Make sure tube bend is close to the TEE so that it will not effect the compression joint at the VALVE.
- Remove COUPLING NUT, FRICTION RING, and RUBBER FERRULE from each valve and slide onto tubing.
- Push TUBING ends into VALVE side outlets. Insert VALVES into mounting holes from underside of SINK.
- Press TEE onto SHANK of SPOUT making certain that the SHANK O-RING is properly seated on SHANK.

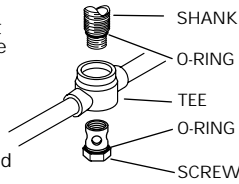
**3****DRAIN ASSEMBLY (Models 6502, 6902, 6532 and 6932)**

- Apply a bead of PUTTY around underside of DRAIN PLUG flange. Insert DRAIN PLUG into SINK drain hole.
- Hold DRAIN PLUG to prevent turning and assemble GASKET, WASHER, and LOCKNUT, from underneath sink.
- Insert threaded end of TAILPIECE into lower end of DRAIN PLUG. Connect other end to trap.

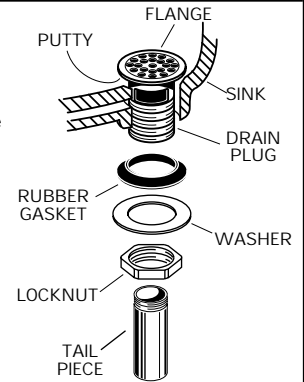
**4****DRAIN INSTALLATION (Models 6801 and 6831 only)**

- Push TAILPIECE down into TRAP (threaded end up).
- Thread LOCKNUT, WASHER and GASKET onto DRAIN BODY.
- Apply a bead of PUTTY to underside of FLANGE.
- Feed DRAIN BODY up through SINK and thread FLANGE fully onto BODY.
- Tighten LOCKNUT firmly, keeping the PIVOT ROD pointed towards the back of the SINK.
- Drop STOPPER into DRAIN BODY.
- Pull TAILPIECE up and thread tightly into DRAIN BODY.

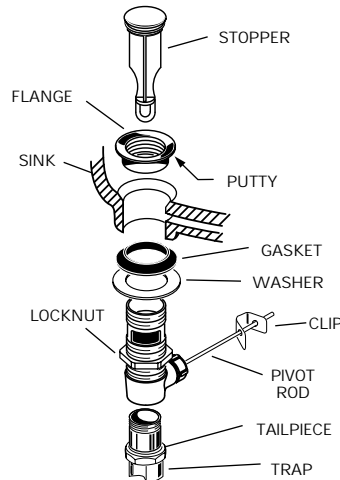

- Position EXTENSION ROD onto POP-UP ROD and tighten THUMBSCREW.
- Remove one end of CLIP from PIVOT ROD by squeezing ends together while sliding.
- Insert PIVOT ROD into second or third hole in EXTENSION and reassemble CLIP. (EXTENSION may need to be bent.)

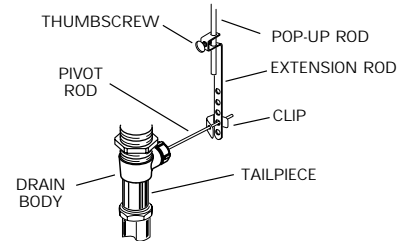

- Adjust STOPPER height by repositioning EXTENSION and tightening THUMBSCREW.

**5****TEST INSTALLED FAUCET**

- Remove AERATOR.
- With handle in OFF position, turn on water supplies and check all connections for leaks.

- Operate both handles to flush water lines thoroughly. Check spout mounting and hose connections for leaks.
- Operate LIFT ROD and check DRAIN for leaks.
- Turn handles into OFF position and replace AERATOR.

**6****SERVICE**

- To change direction of handle rotation, proceed as follows:
  - Turn valve to OFF position.
  - Remove HANDLE and BONNET NUT.
  - Remove SPRING CLIP.
  - Lift STOP WASHER, turn 90° and replace.
  - Replace SPRING CLIP.
  - Replace BONNET NUT, HANDLE, SCREW, and INDEX.
- AERATOR may accumulate dirt causing distorted and reduced water flow. Remove AERATOR and rinse clean.

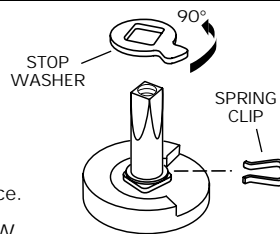

- If spout drips, operate handles several times from OFF to ON position. Do not force - handles turn only 90°.

- Plastic SCREEN in CARTRIDGE may accumulate dirt causing reduced water flow. To clean, first turn off hot and cold water supplies, then:
  - Remove HANDLE and BONNET NUT.
  - Remove CARTRIDGE by pulling up.
  - Thoroughly rinse plastic SCREEN at base of CARTRIDGE.
- Replace CARTRIDGE until flange is tight against valve body.
- Turn valves OFF.
- Replace BONNET NUT, HANDLE, SCREW and INDEX.

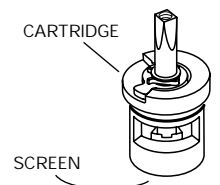
**HOTLINE FOR HELP**

For toll-free information and answers to your questions, call:  
1 (800) 223-0068  
Weekdays 8:00 a.m. to 4:00 p.m. Eastern Time

Product names listed herein are trademarks of American Standard Inc.  
©American Standard Inc. 1997

60186B