

Family: Maribella | Item No. 4768 RY

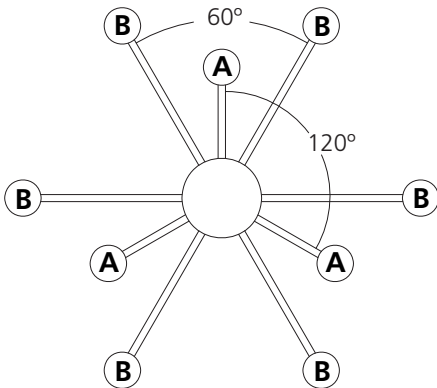

Drawing 1 - Fixture Assembly



Drawing 2 - Fixture Assembly

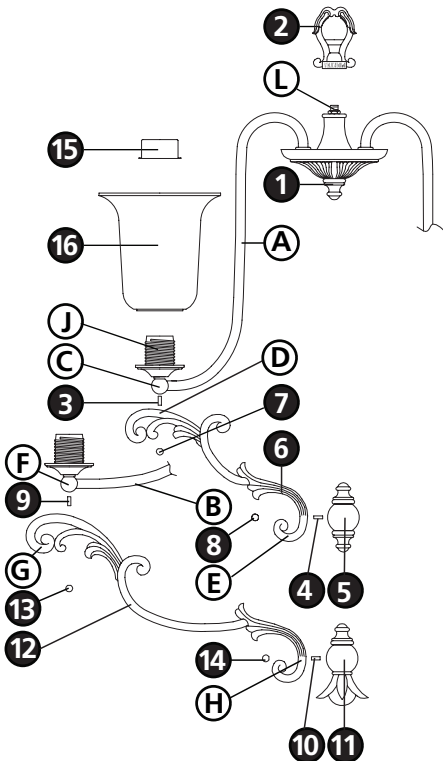

▼ start here

1

1. Find a clear area in which you can work.
2. Unpack fixture and glass from carton.
3. Carefully review instructions prior to assembly.

***** The construction of this fixture will be accomplished by first assembling the main body of the fixture, making all necessary electrical connections, hanging the fixture from the ceiling, and then installing the glass.**

SAFETY WARNING: READ WIRING AND GROUNDING INSTRUCTIONS (I.S. 18) AND ANY ADDITIONAL DIRECTIONS. TURN POWER SUPPLY OFF DURING INSTALLATION. IF NEW WIRING IS REQUIRED, CONSULT A QUALIFIED ELECTRICIAN OR LOCAL AUTHORITIES FOR CODE REQUIREMENTS.

2

1. To assemble fixture, slip loop (2) along wire and thread onto nipple (L) at top of main body assembly (1) - see **Drawing 2**.
2. Spread arms (A) until they are equally spaced 120 degrees apart - see **Drawing 1**.
3. Spread arms (B) of bottom tier until they are equally spaced 60 degrees apart and evenly spaced between the top tier arms.
4. Thread stud (3) into bottom of decorative knob (C) approximately 1/4" and repeat for remaining arms - see **Drawing 2**.
5. Thread the three studs (4) into floating body (5).
6. Slip stud (3) through hole (D) of bottom scroll (6) and thread ball knob (7) onto end of stud (3) to secure scroll (6) and repeat for remaining arms.
7. Slip stud (4) through hole (E) of bottom scroll (6) and thread ball knob (8) onto end of stud (4) to secure scroll (6) and repeat for remaining scrolls.
8. Thread stud (9) into bottom of decorative knob (F) approximately 1/4" and repeat for remaining arms.
9. Thread the six studs (10) into floating body (11).
10. Slip stud (9) through hole (G) of bottom scroll (12) and thread ball knob (13) onto end of stud (9) to secure scroll and repeat for remaining arms.
11. Slip stud (10) through hole (H) of bottom scroll (12) and thread ball knob (14) onto end of stud (10) to secure scroll and repeat for remaining scrolls.
12. Please refer to the hanging instruction sheet (I.S. 19) provided to hang fixture. Then refer back to this sheet to install glass.

3

1. To install glass, remove socket ring (15) from socket (J) - see **Drawing 2**.
2. Slip glass (16) over socket (J).
3. Thread socket ring (15) onto socket (J) to secure glass.
4. Fixture can now be lamped accordingly.

Note: Maximum wattage for 4768 fixture is 75 watts per bulb.

2.29.08