

# INSTALLATION INSTRUCTIONS COLD WATER DISPENSER

NEWPORT BRASS.

*Flawless Beauty. From Faucet to Finish.™*

Model No:

106C, 107C, 107XC, 108C, 108XC

2470-5623, 2500-5623

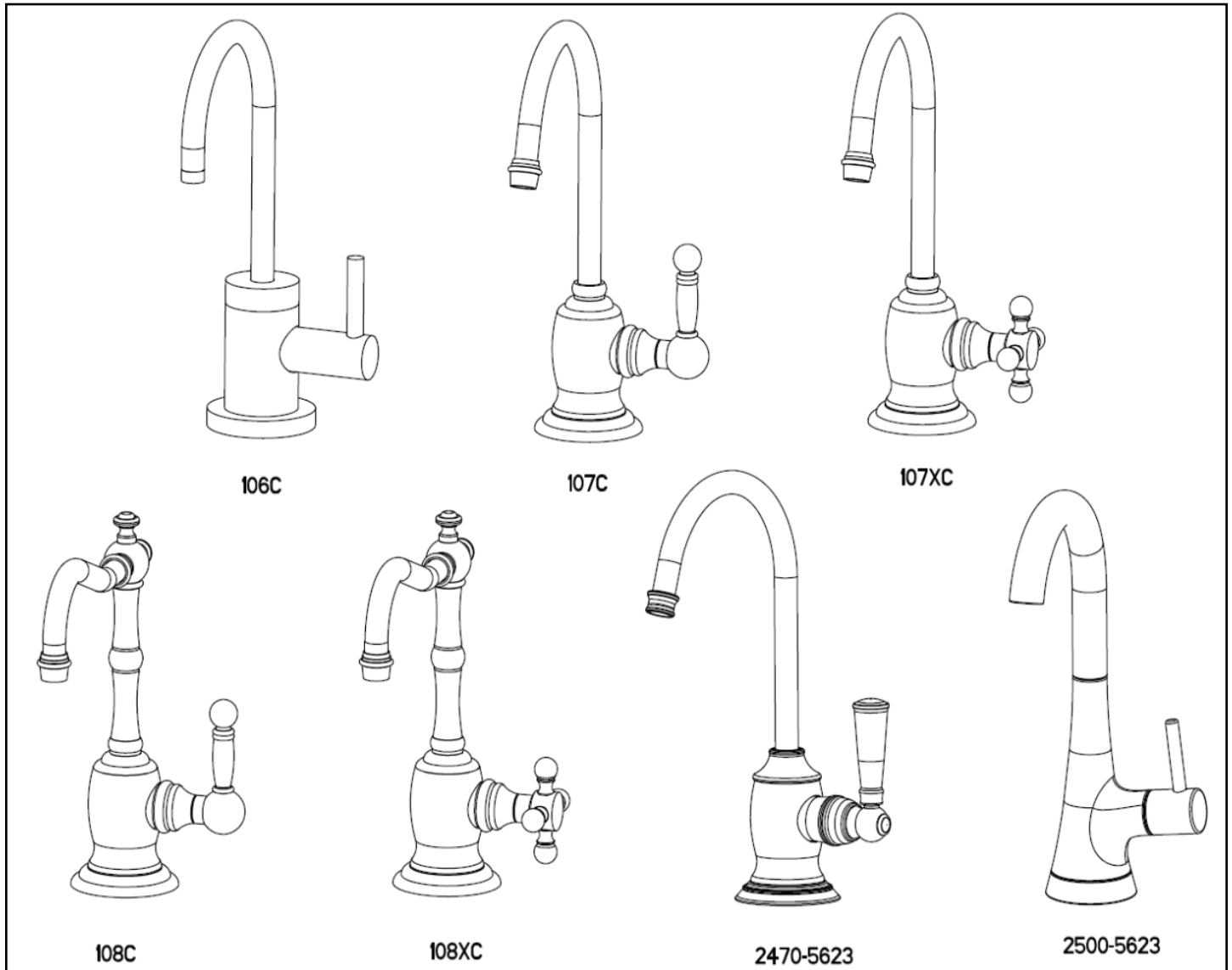

**Congratulations on the purchase  
of your Brasstech product,  
an excellent choice, that will give you  
years of quality service and enhance  
the look and style of your home.**

## Recommended Installation by a Professional Plumbing Contractor

Note: The use of petroleum base plumbers putty on our products will nullify the warranty. We recommend the use of clear silicone sealing materials. Recommended deck thru hole  $\text{\O} 1.25''$  to  $\text{\O} 1.38''$

### INSTALLING FAUCET ON SINK (See Fig 1)

- Place the faucet inlet and mounting stud through escutcheon, o-ring, and mounting surface hole.
- Slide gasket and mounting crescent over mounting stud on underside of mounting surface and secure into place with mounting nut.

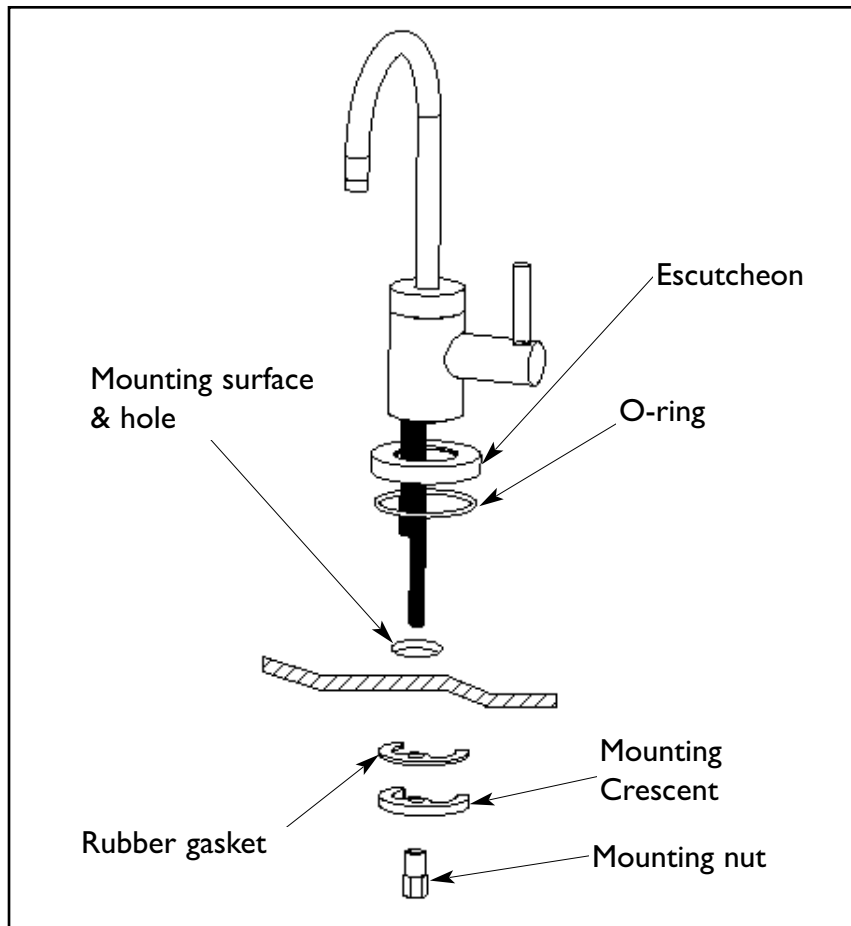

**Figure 1**

## ATTACHING WATER SUPPLY CONNECTION (See Fig 2)

- Slide the 1/4" OD supply tube (not included) through compression nut and compression sleeve. Place insert into end of tube.
- Insert the end of tube into faucet inlet and thread compression nut onto the end of inlet.

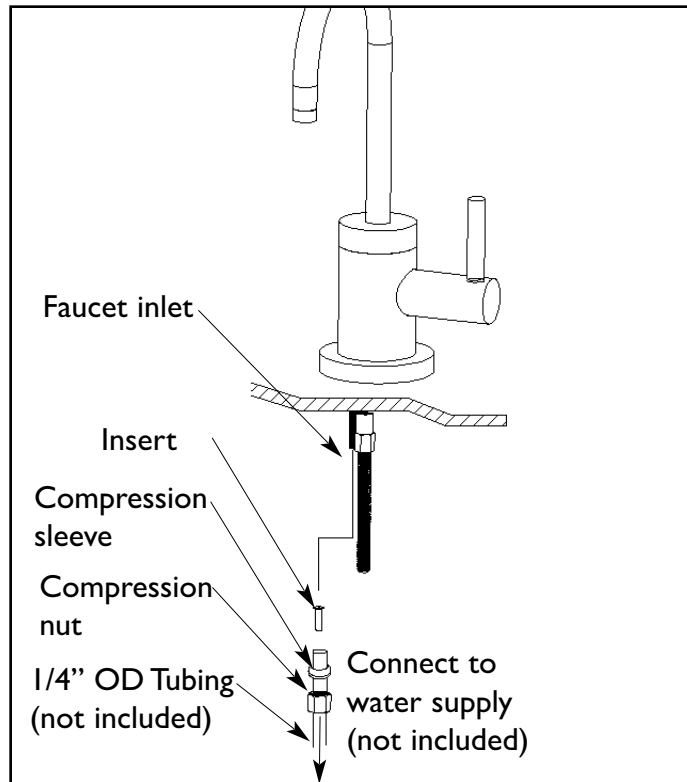

**Figure 2**

### 3. TEST INSTALLED FAUCET

- With handle in OFF position, turn on water supplies and check all connections for leaks.