

ORDER BY PART NUMBER

## ILLUSTRATED PARTS

### 1410/16

17" Reach Wall Mount Shower Arm With Square Escutcheon

ID	Kit Number	Finish
A	WROS0018*	See below

**\*Finish Determined by Suffix**

Finish	Description
APC	Polished Chrome
PN	Polished Nickel
STN	Satin Nickel
TCB	Tuscan Brass

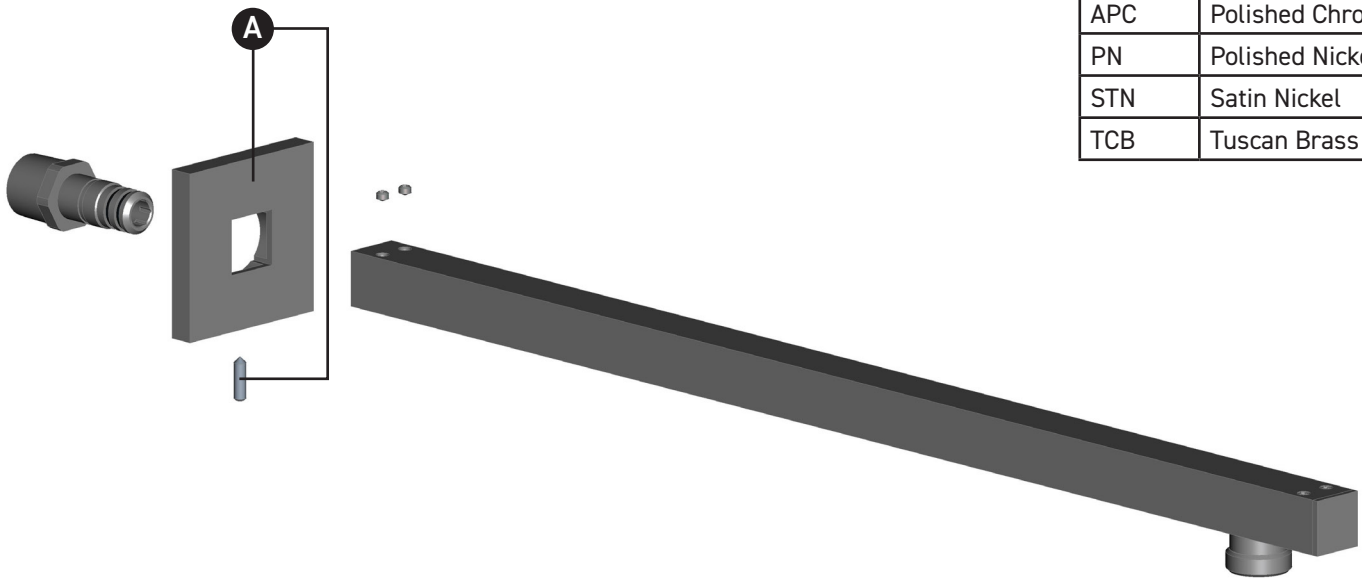

For warranty or additional information, contact:

U.S.A.  
[houseofrohl.com/support](http://houseofrohl.com/support)  
 1-800-777-9762

QUEBEC / MARITIMES / WESTERN CANADA  
[houseofrohl.ca/support](http://houseofrohl.ca/support)  
 1-866-473-8442

ONTARIO  
[houseofrohl.ca/support](http://houseofrohl.ca/support)  
 1-800-287-5354

Riobel

PERRIN & ROWE  
 LONDON



victoria ⊕ albert

ROHL

**VEUILLEZ EFFECTUER VOTRE COMMANDE  
PAR NO DE RÉFÉRENCE**

## ILLUSTRATIONS DES PIÈCES

### 1410/16

Bras de douche mural de 17 po avec écusson carré

ID	Référence du kit	Finition
A	WROS0020*	Voir ci-dessous

**\*Finition déterminée par le Suffixe**

Finition	Description
APC	Laiton poli
PN	Nickel poli
STN	Nickel satiné
TCB	Laiton toscan

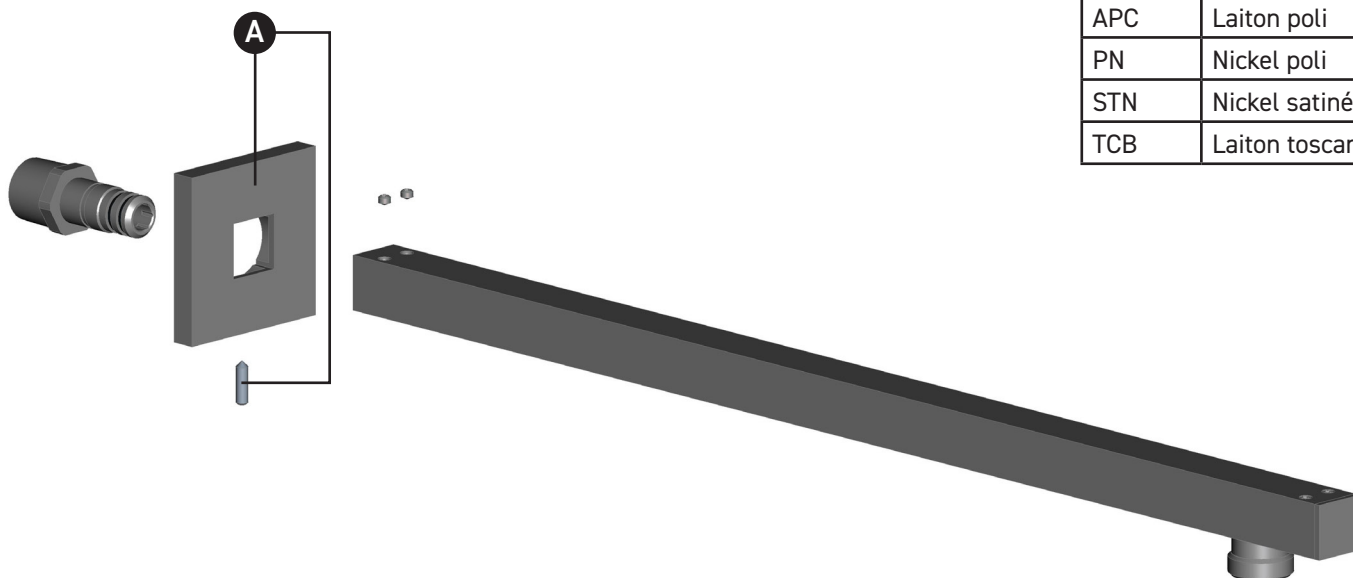

**Pour la garantie ou des informations supplémentaires, contactez:**

U.S.A.  
houseofrohl.com/support  
1-800-777-9762

QUÉBEC / MARITIMES / OUEST CANADIEN  
houseofrohl.ca/support  
1-866-473-8442

ONTARIO  
houseofrohl.ca/support  
1-800-287-5354

Riobel

PERRIN & ROWE  
LONDON



victoria ⊕ albert®

ROHL

PEDIR POR NÚMERO DE REFERENCIA

## PIEZAS ILUSTRADAS

### 1410/16

Brazo de ducha de montaje en pared de 17" de alcance con escudo cuadrado

ID	Referencia del kit	Acabado
A	WROS0020*	Ver más abajo

**\*Acabado determinado por el sufijo**

Acabado	Descripción
APC	Cromo pulido
PN	Níquel pulido
STN	Níquel satinado
TCB	Latón toscano

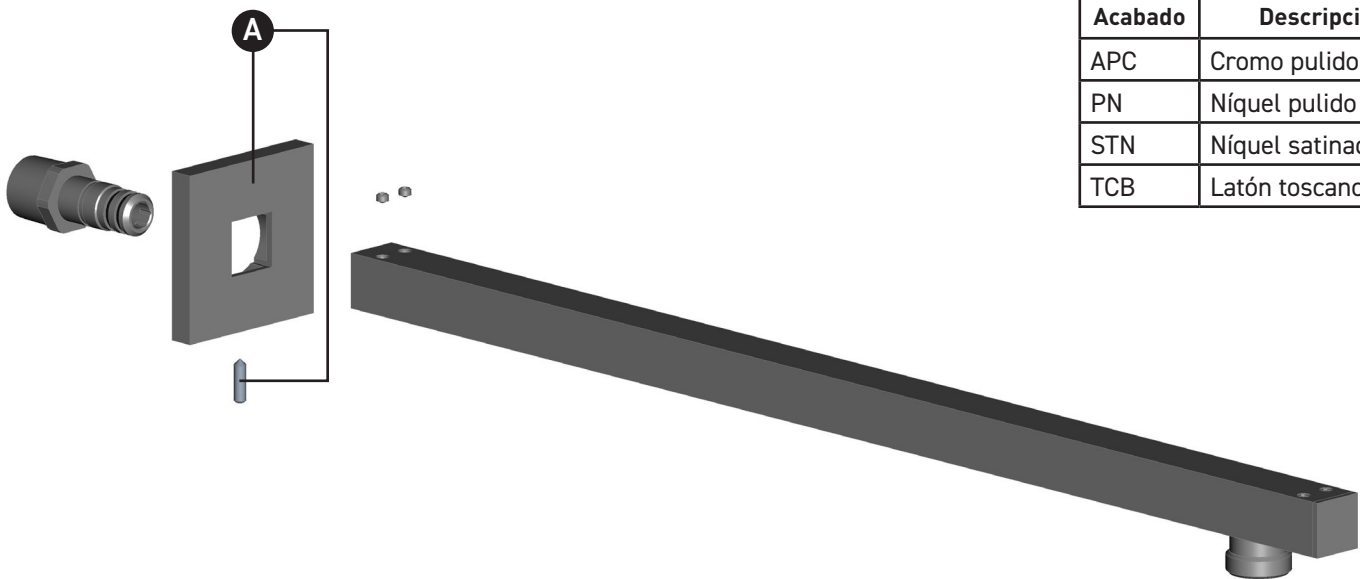

Para garantía o información adicional, comuníquese con:

U.S.A.  
houseofrohl.com/support  
1-800-777-9762

QUEBEC / MARITIMOS / CANADA OCCIDENTAL  
houseofrohl.ca/support  
1-866-473-8442

ONTARIO  
houseofrohl.ca/support  
1-800-287-5354

Riobel

PERRIN & ROWE  
LONDON



victoria ⊕ albert

ROHL