

# Towel Bar / Towel Ring / Robe Hook / Tissue Holder Installation Instructions

**Model No. 13-01, 13-02, 13-03, 13-04, 13-05, 13-09, 13-12, 13-28**

Recommended Installation by a Professional Contractor

1. Using the table below, measure the appropriate distance between post centers. See Fig. 1.

Note: Hole locations should be level.

- 18" Single Towel Bar - 18 7/16"
- 24" Single Towel Bar - 24 7/16"
- 30" Single Towel Bar - 30 7/16"
- 18" Double Towel Bar - 18 11/16"
- 24" Double Towel Bar - 24 11/16"
- Tissue Holder (2 Post) - 6 1/4"

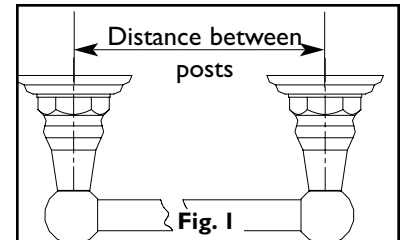

2. Drill hole(s) in wall at points marked using the appropriate drill size:

- Wood Screw (#6 x 2") - use: 3/32" Drill
- Toggle Screw (6-32 x 3") - use: 3/8" Drill

3. Fasten FLANGE (1) to wall using either WOOD/TOGGLE SCREW (2). See Fig. 2.

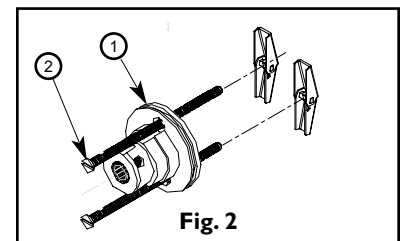

4. Place ESCUTCHEON (3) onto the FLANGE (1). See Fig. 3.

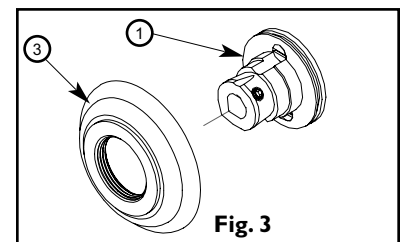

**4a. Towel Bars:** Assemble BAR (5) into END POSTS (4). Slide onto FLANGE (1) and secure into place with SETSCREW (6). See Fig. 4.

**4b. Towel Ring / Robe Hook:** Place END POSTS (4) onto FLANGE (1). Secure into place with SETSCREW (6). See Fig. 5.

**4c. Tissue Holder:** Slide END POST (4) onto FLANGE (1) and secure into place with SETSCREW (6). Place HOLDER (7) between END POSTS (4). See Fig. 6.

